

o.m.
OLEODINAMICA

CATALOGO ADATTATORI



CATALOGO ADATTATORI

REV. 02

Sede: 60035 JESI (AN) Via G. di Vittorio, 9 – Tel 0731 207231 - Fax 0731 64312

Filiale: 41100 MODENA – Via Respighi, 78 – Tel 059 270966 – Fax 059 3680302

e-mail: om@omoleodinamica.com - www.omoleodinamica.com C.F. e P.IVA 00478760424

Indice:

DA PAG. 1 A 26 - FILETTO GAS

- 1,2 - NIPPLI
- 3,4,5 - COLONNETTE
- 6 - PASSAPARETI
- 7,8,9 - NIPPLI DI RIDUZIONE **GAS/GAS-NPTF-UNF-2A**
- 10,11 - RIDUZIONE F/M
- 12,13 - RACCORDI 90°
- 14 - ADATTATORI 90° M/F
- 15,16 - RACCORDI A T
- 17 - ADATTATORI A T e TAPPI
- 18 - VITI FORATE
- 19,20 - OCCHI FILETTATI
- 21 - OCCHI A SALDARE
- 22 - OGIVA CON DADO A SALDARE
- 23 - BORCHIE E MANICOTTI A SALDARE
- 24 - ADATTATORI M/F 45° e 90°
- 25 - ADATTATORI F/F 45° e 90°
- 26 - RACCORDI A CROCE

DA PAG. 27 A 35 - FILETTO METRICO

- 27 - NIPPLI
- 28,29 - RACCORDI DRITTI e COLLONETTE **METRICO/GAS**
- 30,31 - RIDUZIONI **METRICO/GAS**
- 32 - RACCORDO A T e TAPPI
- 33 - VITI FORATE e OCCHI FILETTATI
- 34 - BORCHIE A SALDARE
- 35 - ADATTATORI A 45° e 90°

DA PAG. 36 A 45 - FILETTO ORFS

- 36** - NIPPLI e PASSAPARETE
- 37** - MEZZO NIPPLO A SALDARE e RACCORDI DRITTI **ORFS/GAS**
- 38,39** - RACCORDI DRITTI **ORFS/UNF-MET-GAS**
- 40** - RACCORDI 90° e T
- 41** - RACCORDI A T e TAPPI
- 42** - RACCORDI e RIDUZIONI
- 43** - RACCORDI DI ESTREMITA' A T
- 44** - RACCORDI 45° e 90°
- 45** - RACCORDI 90°

DA PAG. 46 A 62 - FILETTO JIC

- 46** - TAPPI
 - 47** - RACCORDI **JIC/JIC**
 - 48** - RACCORDI M **JIC** / M **NPTF**
 - 49** - RACCORDI M **JIC** / M **UNF-2A**
 - 50** - RACCORDI M **JIC** / M **GAS CON.**
 - 51** - RACCORDI M **JIC** / M **GAS CIL.**
 - 52** - RACCORDI M **JIC** / M **METR. CIL**
 - 53,54** - RACCORDI DIRITTI F/M
 - 55,56** - RACCORDI A T
 - 57,58** - RACCORDI 45°
 - 59,60,61,62** - RACCORDI 90°
-
- 63** - BUSSOLE
 - 64** - DADI LIBERI

**NIPPLO M/M GAS
CICLINDRICO**

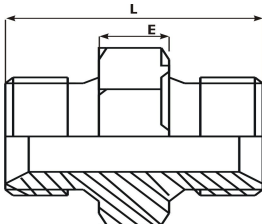

CODICE	Filetto	L	E	CH		
01NP02	1/8-28	25	6	14		
01NP04	1/4-19	29	7	19		
01NP06	3/8-19	34	8	22		
01NP08	1/2-14	37,5	9,5	27		
01NP10	5/8-14	42	10	30		
01NP12	3/4-14	42	10	32		
01NP16	1-11	50	12	41		
01NP20	1.1/4-11	57	17	50		
01NP24	1.1/2-11	60	16	55		
01NP32	2-11	70	17	70		
01NP40	2.1/2-11	85	21	85		
01NP48	3-11	95	25	100		
Serie con foro calibrato su un lato				Misura foro		
01NP04-0	1/4-19	29	7	19	0	
01NP04-006	1/4-19	29	7	19	0,6 mm	
01NP04-008	1/4-19	29	7	19	0,8 mm	
01NP04-01	1/4-19	29	7	19	1 mm	

**NIPPLO M GAS
CONICO / M GAS
CILINDRICO**

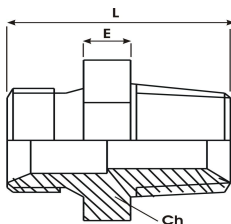

CODICE	Filetto	L	E	CH		
01CC02	1/8-28	23	6	14		
01CC04	1/4-19	32	7	17/16		
01CC06	3/8-19	35	8	19		
01CC08	1/2-14	42,5	9,5	24		
01CC12	3/4-14	45	10	32		
01CC16	1-11	55	12	36		
01CC24	1.1/2-11	60,5	13,5	50		
01CC32	2-11	64	12	65		
01CC40	2.1/2-11	68	13	75		

**NIPPLO M/M GAS
CONICO**

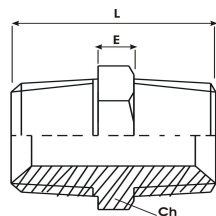

CODICE	Filetto	L	E	CH		
01CN02	1/8-28	26	6	14		
01CN04	1/4-19	35	7	17		
01CN06	3/8-19	36,5	8	19		
01CN08	1/2-14	48	9	22		
01CN12	3/4-14	48	10	27		
01CN16	1-11	59	10	36		
01CN20	1.1/4-11	63,5	14	46		
01CN24	1.1/2-11	67	14	50		
01CN32	2-11	68	12	60		
01CN40	2.1/2-11	78	21	80		

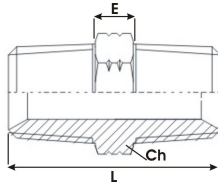
NIPPLO NPTF

CODICE	Filetto	L	E	CH		
01NN02	1/8-28	29	6	13		
01NN04	1/4-19	32	7	17		
01NN06	3/8-19	38	8	19		
01NN08	1/2-14	40	8	27		
01NN16	1-11	60	18	36		
01NN32	2-11	75	22	65		

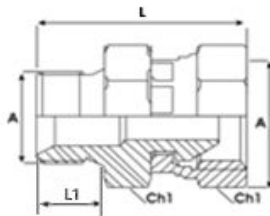
**NIPPLO GAS M/F
GIREVOLE**

CODICE	Filetto A	L	L1	CH		
01MG02	1/8-28	29	6	14		
01MG04	1/4-19	34	6	19		
01MG06	3/8-19	40	8	22		
01MG08	1/2-14	41	8	27		
01MG10	5/8-14	49	10	27		
01MG12	3/4-14	54	11	32		
01MG16	1-11	60	13	41		
01MG20	1.1/4-11	66	13	50		
01MG24	1.1/2-11	70	14	55		
01MG32	2-11	84	20	70		

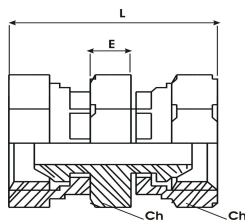
**GIUNZIONE GAS F/F
GIREVOLE**

CODICE	Filetto	L	E	CH		
01FG02	1/8-28	34	7	15		
01FG04	1/4-19	37	7	19		
01FG06	3/8-19	44	8	22		
01FG08	1/2-14	50	9,5	27		
01FG10	5/8-14	55	10	28		
01FG12	3/4-14	59	10	32		
01FG16	1-11	66,5	12	41		
01FG20	1.1/4-11	76	9	50		
01FG24	1.1/2-11	83	14	55		
01FG32	2-11	91,5	17	70		

**MEZZO NIPPLO A
SALDARE GAS**

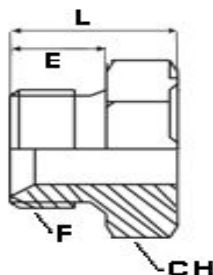

CODICE	Filetto	L	E	CH	
01NS02	1/8-28	16.5	5	14	
01NS04	1/4-19	18	7	19	
01NS06	3/8-19	21	8	22	
01NS08	1/2-14	25	10	27	
01NS10	5/8-14	26	10	30	
01NS12	3/4-14	27	10	32	
01NS16	1-11	30	12	41	
01NS20	1.1/4-11	34	13	50	
01NS24	1.1/2-11	36	14	55	
01NS32	2-11	40	16	65	
01NS40	2.1/2-11	50	20	70	
01NS48	3-11	60	25	100	
01NS56	3.1/2-11	60	25	110	

**COLONNETTA GAS
M/F**

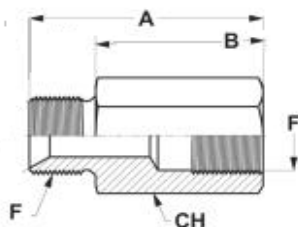

CODICE	Filetto	A	B	CH	
01MF02-10	1/8	18	10	14	
01MF02-17	1/8	25	17	14	
01MF02-20	1/8	28	20	14	
01MF02-21	1/8	29	21	14	
01MF02-30	1/8	38	30	14	
01MF02-40	1/8	48	40	14	
01MF04-16	1/4	28	16	19	
01MF04-20	1/4	32	20	19	
01MF04-25	1/4	37	25	19	
01MF04-30	1/4	42	30	19	
01MF04-35	1/4	47	35	19	
01MF04-40	1/4	52	40	19	
01MF04-45	1/4	57	45	19	
01MF04-50	1/4	62	50	19	
01MF04-60	1/4	72	60	19	
01MF04-75	1/4	87	75	19	
01MF04-100	1/4	112	100	19	
01MF06-20	3/8	32	20	22	
01MF06-22	3/8	34	22	22	
01MF06-25	3/8	37	25	22	
01MF06-30	3/8	42	30	22	
01MF06-35	3/8	47	35	22	
01MF06-40	3/8	52	40	22	
01MF06-45	3/8	57	45	22	
01MF06-50	3/8	62	50	22	
01MF06-60	3/8	72	60	22	
01MF08-20	1/2	36	20	27	
01MF08-23	1/2	39	23	27	
01MF08-25	1/2	41	25	27	
01MF08-30	1/2	46	30	27	
01MF08-35	1/2	51	35	27	

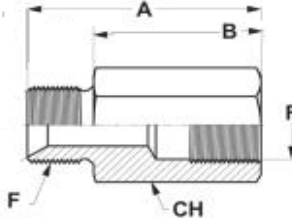
COLONNETTA GAS
M/F

CODICE	Filetto	A	B	CH	
01MF08-40	1/2	56	40	27	
01MF08-45	1/2	61	45	27	
01MF08-50	1/2	66	50	27	
01MF08-60	1/2	76	60	27	
01MF08-65	1/2	81	65	27	
01MF08-80	1/2	96	80	27	
01MF08-100	1/2	116	100	27	
01MF08-150	1/2	166	150	27	
01MF10-35	5/8	51	35	30	
01MF12-30	3/4	47	30	32	
01MF12-35	3/4	52	35	32	
01MF12-40	3/4	57	40	32	
01MF12-45	3/4	62	45	32	
01MF12-55	3/4	72	55	32	
01MF12-60	3/4	77	60	32	
01MF12-62	3/4	79	62	32	
01MF12-80	3/4	97	80	32	
01MF16-30	1	49	30	41	
01MF16-35	1	54	35	41	
01MF16-40	1	59	40	41	
01MF16-46	1	65	46	41	
01MF16-50	1	69	50	41	
01MF16-60	1	79	60	41	
01MF16-65	1	84	65	41	
01MF16-70	1	89	70	41	
01MF16-71	1	90	71	41	
01MF16-80	1	99	80	41	
01MF20-35	1.1/4	57	35	50	
01MF20-40	1.1/4	62	40	50	
01MF20-50	1.1/4	72	50	50	
01MF20-60	1.1/4	82	60	50	
01MF20-70	1.1/4	92	70	50	
01MF20-100	1.1/4	122	100	50	
01MF20-120	1.1/4	142	120	50	
01MF20-260	1.1/4	282	260	50	
01MF24-40	1.1/2	62	40	55	
01MF24-50	1.1/2	72	50	55	
01MF24-60	1.1/2	82	60	55	
01MF24-75	1.1/2	97	75	55	
01MF24-80	1.1/2	102	80	55	
01MF24-120	1.1/2	142	120	55	
01MF32-45	2	71	45	70	
01MF32-50	2	76	50	70	
01MF32-75	2	101	75	70	

COLONNETTA GAS
F/F

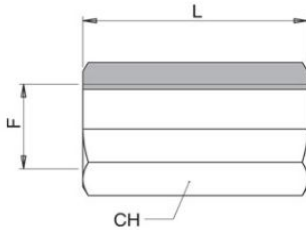

CODICE	Filetto	L	CH		
01FF02-22	1/8-28	22	14		
01FF02-25	1/8-28	25	14		
01FF02-30	1/8-28	30	14		
01FF04-25	1/4-19	25	19		
01FF04-30	1/4-19	30	19		
01FF04-35	1/4-19	35	19		
01FF04-50	1/4-19	50	19		
01FF06-30	3/8-19	30	22		
01FF06-35	3/8-19	35	22		
01FF06-45	3/8-19	45	22		
01FF06-52	3/8-19	52	22		
01FF08-45	1/2-14	45	27		
01FF12-45	3/4-14	45	32		
01FF16-38	1-11	38	38		
01FF16-45	1-11	45	38		
01FF16-50	1-11	50	38		
01FF16-60	1-11	60	38		
01FF16-80	1-11	80	38		
01FF20-50	1.1/4-11	50	55		
01FF20-60	1.1/4-11	60	55		
01FF20-90	1.1/4-11	90	55		
01FF24-70	1.1/2-11	70	55		

COLONNETTA GAS
M/M

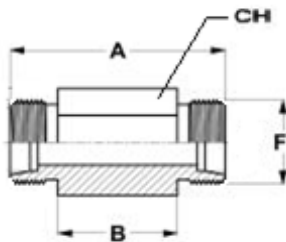

CODICE	Filetto	A	B	CH	
01MM04-20	1/4-19	43	20	19	
01MM04-25	1/4-19	48	25	19	
01MM04-90	1/4-19	113	90	19	
01MM04-115	1/4-19	138	115	19	
01MM06-25	3/8-19	51	25	22	
01MM06-34	3/8-19	60	34	22	
01MM06-35	3/8-19	61	35	22	
01MM06-40	3/8-19	66	40	22	
01MM06-45	3/8-19	71	45	22	
01MM06-50	3/8-19	76	50	22	
01MM06-55	3/8-19	81	55	22	
01MM08-25	1/2-14	53	25	27	
01MM08-35	1/2-14	63	35	27	
01MM08-40	1/2-14	68	40	27	
01MM08-50	1/2-14	78	50	27	
01MM08-60	1/2-14	88	60	27	
01MM12-40	3/4-14	74	40	32	
01MM12-45	3/4-14	79	45	32	
01MM16-30	1-11	70	30	38	
01MM16-45	1-11	85	45	38	
01MM16-60	1-11	100	60	38	
01MM20-90	1.1/4-11	134	90	50	
01MM32-50	2-11	100	50	70	

**PASSAPARETE
DIRITTA GAS**

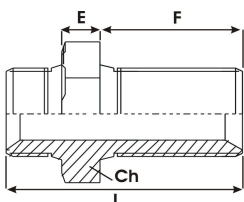

CODICE	Filetto	L	F	E	CH	
01PSP04	1/4-19	45	28	6	19	
01PSP06	3/8-19	53	33	7	22	
01PSP08	1/2-14	59	37	8	27	
01PSP10	5/8-14	71	45	10	30	
01PSP12	3/4-14	80	53	10	32	
01PSP16	1-11	81	51	11	41	
01PSP20	1.1/4-11	96	61	13	50	
01PSP24	1.1/2-11	110	71	15	60	

**GHIERA GAS PER
PASSAPARETE**

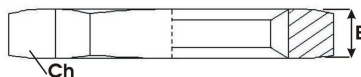

CODICE	Filetto	E	CH			
CD04FG	1/4-19	6	19			
CD06FG	3/8-19	7	22			
CD08FG	1/2-14	7	27			
CD10FG	5/8-14	10	30			
CD12FG	3/4-14	10	32			
CD16FG	1-11	12	41			
CD20FG	1.1/4-11	13	50			
CD24FG	1.1/2-11	13	55			
CD32FG	2-11	8	70			

**PASSAPARETE GAS
M/M 90°**

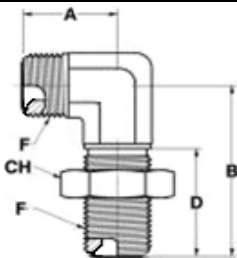

CODICE	Filetto	A	B	D	CH	
01PSP9002	1/8-28	20	40	20	15	
01PSP9004	1/4-19	24	45	28	19	
01PSP9006	3/8-19	28	52	32	24	
01PSP9008	1/2-14	36	56	34	27	
01PSP9012	3/4-14	42	65	39	36	
01PSP9016	1-11	45	70	41	41	
01PSP9020	1.1/4-11	60	90	55	50	
01PSP9024	1.1/2-11	65	95	60	60	

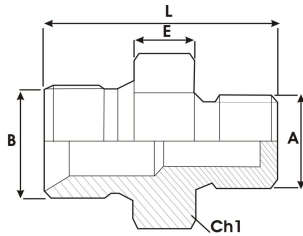
**NIPLO DI RIDUZIONE
M/M GAS CILINDRICA**

CODICE	Filetto A	Filetto B	L	E	CH	
02NR04-02	1/4-19	1/8-28	27,5	7	19	
02NR06-02	3/8-19	1/8-28	28	6,5	19	
02NR06-04	3/8-19	1/4-19	32	8	22	
02NR08-02	1/2-14	1/8-28	31	7	27	
02NR08-04	1/2-14	1/4-19	35	10	27	
02NR08-06	1/2-14	3/8-19	37	10	27	
02NR10-04	5/8-14	1/4-19	37	10	27	
02NR10-06	5/8-14	3/8-19	39	10	30	
02NR10-08	5/8-14	1/2-14	40	10	30	
02NR12-04	3/4-14	1/4-19	38	10	32	
02NR12-06	3/4-14	3/8-19	40	10	32	
02NR12-08	3/4-14	1/2-14	40	10	32	
02NR12-10	3/4-14	5/8-14	43	10	32	
02NR16-04	1-11	1/4-19	42	12	41	
02NR16-06	1-11	3/8-19	44	12	41	
02NR16-08	1-11	1/2-14	45	12	41	
02NR16-10	1-11	5/8-14	45	10	38	
02NR16-12	1-11	3/4-14	47	12	41	
02NR20-08	1.1/4-11	1/2-14	48	12,5	50	
02NR20-12	1.1/4-11	3/4-14	53	17	50	
02NR20-16	1.1/4-11	1-11	56	17	50	
02NR24-08	1.1/2-11	1/2-14	50	14	55	
02NR24-12	1.1/2-11	3/4-14	52	13	55	
02NR24-20	1.1/2-11	1.1/4-11	56	14	55	
02NR32-10	2-11	5/8-14	60	17	70	
02NR32-16	2-11	1-11	62	17	70	
02NR32-20	2-11	1.1/4-11	65	17	70	
02NR32-24	2-11	1.1/2-11	65	17	70	
02NR40-24	2.1/2-11	1.1-2-11	74	21	85	
02NR40-32	2.1/2-11	2-11	79	21	85	
02NR48-40	3-11	2.1/2-11	92	25	100	

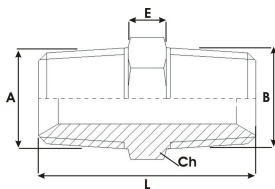
**NIPLO DI RIDUZIONE
M/M GAS CONICO**

CODICE	Filetto A	Filetto B	L	E	CH	
02CN04-02	1/4-19	1/8-28	30	8	14	
02CN06-04	3/8-19	1/4-19	38	8	22	
02CN08-04	1/2-14	1/4-19	40	9	24	
02CN08-06	1/2-14	3/8-19	42	9,5	24	
02CN12-08	3/4-14	1/2-14	47	9	32	
02CN16-12	1-11	3/4-14	56	13	36	
02CN20-16	1.1/4-11	1-11	61	14	50	
02CN24-20	1.1/2-11	1.1/4-11	64	14	50	

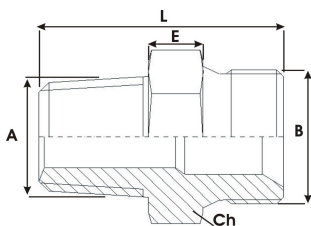
**NIPPLO M GAS
CONICO / M GAS
CILINDRICO**

CODICE	Filetto A	Filetto B	L	E	CH
02CC04-02	1/4-19	1/8-28	31	7	17
02CC06-04	3/8-19	1/4-19	32	7	19
02CC08-04	1/2-14	1/4-19	39	10	24
02CC08-06	1/2-14	3/8-19	39	8	24
02CC12-06	3/4-14	3/8-19	43	9	32
02CC12-08	3/4-14	1/2-14	43.5	10	32
02CC16-12	1-11	3/4-14	50	10	36
02CC04-06	1/4-19	3/8-19	32,5	7	19
02CC06-08	3/8-19	1/2-14	38	9	24
02CC08-10	1/2-14	5/8-14	59	9,5	28
02CC04-08	1/4-19	1/2-14	38	10	24
02CC08-12	1/2-14	3/4-14	43	8	27
02CC12-16	3/4-14	1-11	49	12	36
02CC16-20	1-11	1.1/4-11	57	13	50
02CC12-06	3/4-14	3/8-19	45	11	32

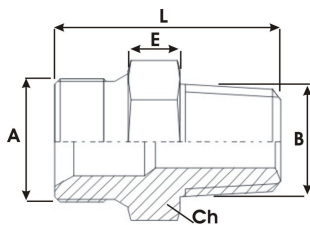
**NIPPLO M GAS / M
NPTF**

CODICE	Filetto A	Filetto B	L	E	CH
02GN02	1/8-28		24	6	14
02GN04	1/4-19		31	7	17
02GN06	3/8-19		34	8	19
02GN08	1/2-14		41	10	24
02GN12	3/4-14		46	11	30
02GN16	1-11		54	12	36
02GN20	1.1/4-11		60	16	50
02GN24	1.1/2-11		60	13	55
02GN32	2-11		64	15	65
02GN04-02	1/4-19	1/8-28	28	7	14
02GN04-08	1/4-19	1/2-14	36	10	22
02GN06-04	3/8-19	1/4-19	33	7	19
02GN06-08	3/8-19	1/2-14	39	9	24
02GN08-06	3/8-19	3/8-19	39	8	24
02GN08-04	3/8-19	1/4-19	36	8	24
02GN08-12	3/8-19	3/4-14	45	11	27
02GN12-08	3/4-14	1/2-14	43	9	27
02GN12-16	3/4-14	1-11	53	12	36
02GN16-12	1-11	3/4-14	52	11	36
02GN24-32	1.1/2-11	2-11	64	7	65

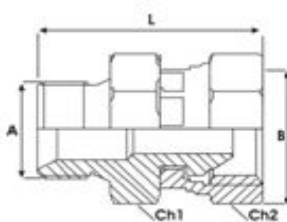
**RIDUZIONE M/F
GIREVOLE GAS**

CODICE	Filetto A	Filetto B	L	CH1	CH2
02MG04-06	1/4-19	3/8-19	35	19	22
02MG04-08	1/4-19	1/2-14	40	19	27
02MG06-08	3/8-19	1/2-14	42	22	27
02MG06-12	3/8-19	3/4-14	46,5	27	32
02MG08-12	1/2-14	3/4-14	52	27	32
02MG12-16	3/4-14	1-11	54	32	38
02MG06-04	3/8-19	1/4-19	36	22	19
02MG08-04	1/2-14	1/4-19	40	27	19
02MG08-06	1/2-14	3/8-19	42	27	22
02MG12-08	3/4-14	1/2-14	49	32	27
02MG16-08	1-11	1/2-14	51	40	27
02MG16-12	1-11	3/4-14	55	41	32
02MG20-16	1.1/4-11	1-11	60	38	50
02MG04-12A	1/4-19	12X1,5	32	17	17
02MG04-14A	1/4-19	14X1,5	32	17	17
02MG04-16A	1/4-19	16X1,5	35	19	22
02MG06-16A	3/8-19	16X1,5	40	22	22
02MG06-18A	3/8-19	18X1,5	39	22	22
02MG08-18A	1/2-14	18X1,5	43	27	22
02MG08-22A	1/2-14	22X1,5	41	27	27
02MG12-18A	3/4-14	18X1,5	53	31	24
02MG12-22A	3/4-14	22X1,5	48	32	27

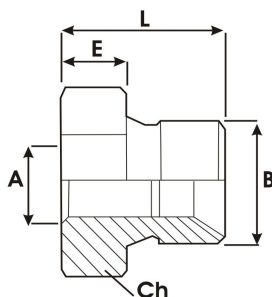
**RIDUZIONE F/M GAS
SERIE CORTA**

CODICE	Filetto A	Filetto B	L	E	CH
02FMB02-06	1/8-28	3/8-19	21	8	22
02FMB04-06	1/4-19	3/8-19	21	8	22
02FMB04-08	1/4-19	1/2-14	24	10	27
02FMB04-12	1/4-19	3/4-14	26	10	32
02FMB04-16	1/4-19	1-11	31	12	41
02FMB06-08	3/8-19	1/2-14	24	10	27
02FMB06-12	3/8-19	3/4-14	26	10	32
02FMB06-16	3/8-19	1-11	30	12	41
02FMB08-12	1/2-14	3/4-14	26	10	32
02FMB08-16	1/2-14	1-11	31	12	41
02FMB08-20	1/2-14	1.1/4-11	36	14	50
02FMB12-20	3/4-14	1.1/4-11	34	14	50
02FMB12-24	3/4-14	1.1/2-11	36	14	55
02FMB16-20	1-11	1.1/4-11	34	13	50
02FMB16-24	1-11	1.1/2-11	36	14	55
02FMB16-32	1-11	2-11	43	17	70
02FMB20-32	1.1/4-11	2-11	43	17.5	70
02FMB24-32	1.1/4-11	2-11	43	12	70
02FMB04-18A	1/4-19	18X1,5	20	7	22
02FMB04-22A	1/4-19	22X1,5	22	8	27
02FMB16A-14A	16X1,5	14X1,5	33	22	21
02FMB06-10C	3/8-19	10X1	20	7	21
02FMB12-18A	3/4-14	18X1,5	27	10	32
02FMB14A-18A	14X1,5	18X1,5	21	7	22
02FMB16A-20A	1-11	20X1,5	23	9	27

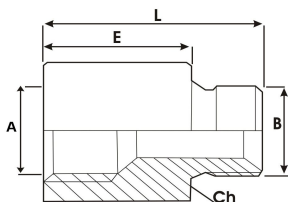
**RIDUZIONE F/M GAS
SERIE LUNGA**

CODICE	Filetto A	Filetto B	L	E	CH	
02FM02-04	1/8-28	1/4-19	26	15	19	
02FM02-08	1/8-28	1/2-14	24	10	27	
02FM04-06	1/4-19	3/8-19	35	22	22	
02FM04-08	1/4-19	1/2-14	36	22	27	
02FM06-08	3/8-19	1/2-14	36	22	27	
02FM06-12	3/8-19	3/4-14	39	22	32	
02FM08-12	1/2-14	3/4-14	43	27	32	
02FM08-16	1/2-14	1-11	46	26	38	
02FM12-16	3/4-14	1-11	50	31	41	
02FM16-20	1-11	1.1/4-11	53	32	50	
02FM20-24	1.1/4-11	1.1/2-11	54	32	55	
02FM04-02	1/4-19	1/8-28	29	20	19	
02FM06-02	3/8-19	1/8-28	29,5	22	22	
02FM06-04	3/8-19	1/4-19	33	22	22	
02FM08-02	1/2-14	1/8-28	33	25	27	
02FM08-04	1/2-14	1/4-19	34	23	27	
02FM08-06	1/2-14	3/8-19	39	26	27	
02FM12-04	3/4-14	1/4-19	41	30	32	
02FM12-06	3/4-14	3/8-19	42	29	32	
02FM12-08	3/4-14	1/2-14	43	29	32	
02FM16-06	1-11	3/8-19	45	32	41	
02FM16-08	1-11	1/2-14	46	32	41	
02FM20-12	1.1/4-11	3/4-14	49	32	50	
02FM20-16	1.1/4-11	1-11	51	32	50	
02FM24-08	1.1/2-11	1/2-14	53	39	55	
02FM24-16	1.1/2-11	1-11	54	34	55	
02FM24-20	1.1/2-11	1.1/4-11	56	34	55	
02FM32-16	2-11	1-11	60	40	70	
02FM32-24	2-11	1.1/2-11	57	35	70	
02FM10C-04	10X1	1/4-19	24.5	13	17	
02FM02-16A	1/8-28	16X1,5	33	20	22	
02FM12A-04	12X1,5	1/4-19	24	14	17	
02FM14A-04	14X1,5	1/4-19	27	16	17	
02FM16A-04	16X1,5	1/4-19	33	22	22	
02FM18A-04	18X1,5	1/4-19	34	22	24	
02FM20A-04	20X1,5	1/4-19	37	26	27	
02FM14A-06	14X1,5	3/8-19	32	20	22	
02FM16A-06	16X1,5	3/8-19	32	19	22	
02FM18A-06	18X1,5	3/8-19	35	22	24	
02FM14A-08	14X1,5	1/2-14	34	20	27	
02FM16A-08	16X1,5	1/2-14	34	20	27	
02FM18A-08	18X1,5	1/2-14	34	20	27	
02FM22A-14A	22X1,5	14X1,5	30	21	27	
02FM22A-16A	16X1,5	16X1,5	34	21	27	

**ADATTATORE A 90° DI
ESTREMITA' FILETT.
GAS CIL. / GAS CON.**

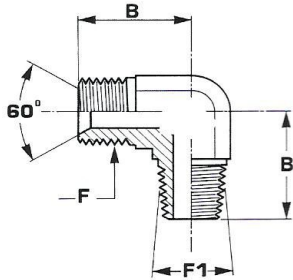

CODICE	F GAS CIL	F1 GAS CON	B			
03MM02	1/8"	1/8"	20			
03MM04	1/4"	1/4"	27			
03MM06	3/8"	3/8"	30			
03MM08	1/2"	1/2"	37			
03MM10	5/8"	1/2"	37			
03MM12	3/4"	3/4"	40			
03MM16	1"	1"	50			
03MM20	1"1/4"	1"1/4"	52			
03MM24	1"1/2"	1"1/2"	59			

**RACCORDO A 90°
FEMMINA FILETT.
GAS CILINDRICA**

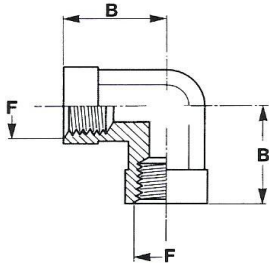

CODICE	F GAS CIL	B				
03FF02	1/8"	17				
03FF04	1/4"	22				
03FF06	3/8"	26				
03FF08	1/2"	31				
03FF12	3/4"	35				
03FF16	1"	44				
03FF20	1"1/4"	52				

**ADATTATORE A 90°
INTERMEDIO
FILETTATURA GAS
CILINDRICA**

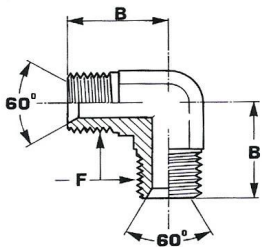

CODICE	F GAS CIL	B				
03MG02	1/8"	20				
03MG04	1/4"	28				
03MG06	3/8"	30				
03MG08	1/2"	37				
03MG10	5/8"	40				
03MG12	3/4"	40				
03MG16	1"	50				
03MG20	1"1/4"	52				
03MG24	1"1/2"	59				

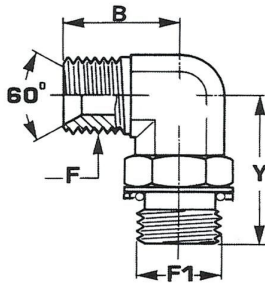
**ADATTATORE A 90°
ORIENTABILE FILET.
GAS CILINDRICA**

CODICE	F GAS CIL	F1 GAS CIL	B	Y		
03RMG04	1/4"	1/4"	27	31.5		
03RMG06-04	3/8"	1/4"	31.5	33.5		
03RMG06	3/8"	3/8"	31.5	37		
03RMG06-08	3/8"	1/2"	31.5	43		
03RMG08-06	1/2"	3/8"	37.5	39.5		
03RMG08	1/2"	1/2"	36.5	43		
03RMG12-08	3/4"	1/2"	40	45.5		
03RMG12	3/4"	3/4"	40	49		
03RMG16-12	1"	3/4"	50	49		
03RMG16	1"	1"	50	52		
03RMG20-16	1"1/4	1"	52	52		
03RMG20	1"1/4	1"1/4	52	57		
03RMG24	1"1/2	1"1/2	59	61		

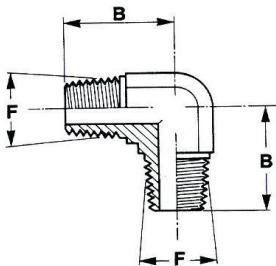
**ADATTATORE A 90°
FILETTATURA GAS
CONICA**

CODICE	F GAS CONICA	B				
03MK02	1/8"	20				
03MK04	1/4"	27				
03MK06	3/8"	31				
03MK08	1/2"	37				
03MK12	3/4"	40				
03MK16	1"	50				
03MK20	1"1/4	52				
03MK24	1"1/2	59				

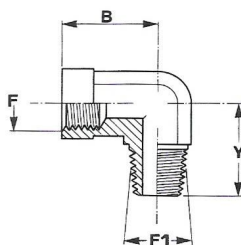
**RACCORDO A 90° DI
ESTREMITA' F/M FIL.
GAS CIL. / GAS CON.**

CODICE	F GAS CIL	F1 GAS CON	B	Y		
03MFF02	1/8"	1/8"	17	20		
03MFF04	1/4"	1/4"	22	28		
03MFF06	3/8"	3/8"	26	31		
03MFF08	1/2"	1/2"	31	37		
03MFF12	3/4"	3/4"	35	40		
03MFF16	1"	1"	44	56		

**ADATTATORE 90°
GAS CIL. M/F
GIREVOLE ORIENT.**

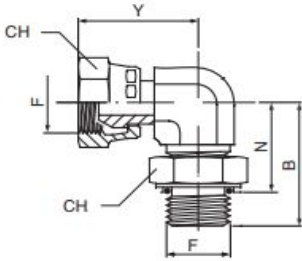

CODICE	Filetto	B	Y	N	CH
03RMFG04	1/4-19	31.5	29	22	19
03RMFG06	3/8-19	37	34	27,5	22
03RMFG08	1/2-14	43	40	32	27
03RMFG12	3/4-14	49	46	34,5	36
03RMFG16	1-11	52	51,5	38	41
03RMFG20	1.1/4-11	57	57	46	50

**ADATTATORE 90°
F GIR. GAS CIL. / M
GAS CON.**

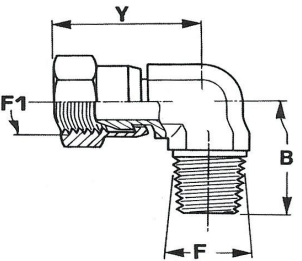

CODICE	F GAS CON	F1 GAS CIL	B	Y	
03MFG04	1/4"	1/4"	27.5	29	
03MFG06	3/8"	3/8"	31.5	34	
03MFG08	1/2"	1/2"	36	40	
03MFG10	5/8"	5/8"	36.5	42	
03MFG12	3/4"	3/4"	40	46	
03MFG16	1"	1"	50	51.5	
03MFG20	1"1/4	1"1/4	52	57	
03MFG24	1"1/2	1"1/2	59	64	

**RACCORDO A T
FEMMINA FIL. GAS
CILINDRICA**

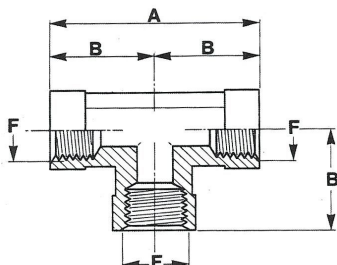

CODICE	F GAS CIL.	A	B			
04FF02	1/8"	34	17			
04FF04	1/4"	44	22			
04FF06	3/8"	52	26			
04FF08	1/2"	62	31			
04FF12	3/4"	70	35			
04FF16	1"	88	44			
04FF20	1"1/4	100	50			
04FF24	1"1/2	106	53			

**RACCORDO A T
INTERMEDIO CON
DADI GIR. GAS
CILINDRICA**

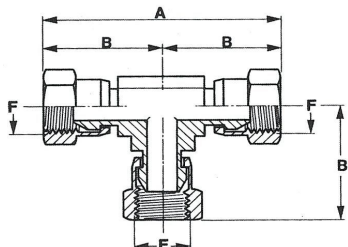

CODICE	F GAS CIL.	A	B			
04FG04	1/4"	58	29			
04FG06	3/8"	68	34			
04FG08	1/2"	80	40			
04FG10	5/8"	84	42			
04FG12	3/4"	91	45.5			
04FG16	1"	104	52			

**ADATTATORE A T
INTERMEDIO FIL. GAS
CILINDRICA**

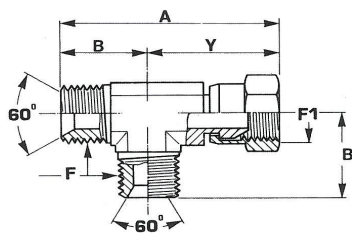

CODICE	F GAS CIL.	F1 GAS CIL.	A	B	Y	
04LMFG04	1/4"	1/4"	58	27	31	
04LMFG06	3/8"	3/8"	65.5	31.5	34	
04LMFG08	1/2"	1/2"	77	37	40	
04LMFG10	5/8"	5/8"	78	36	42	
04LMFG12	3/4"	3/4"	86	40	46	
04LMFG16	1"	1"	102	50	52	
04LMFG20	1"1/4	1"1/4	109	52	57	
04LMFG24	1"1/2	1"1/2	120	59	61	

**ADATTATORE A T
CON DADO GIR.
CENTR. FILET. GAS
CIL.**

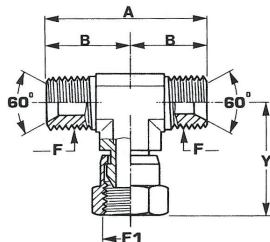

CODICE	F GAS CIL	F1 GAS CIL	A	B	Y	
04CMFG04	1/4	1/4	54	27	29	
04CMFG06	3/8	3/8	63	31,5	34	
04CMFG08	1/2	1/2	74	37	40	
04CMFG10	5/8	5/8	74	37	42	
04CMFG12	3/4	3/4	80	40	46	
04CMFG16	1"	1"	100	50	52	
04CMFG20	1"1/4	1"1/4	104	52	57	
04CMFG24	1"1/2	1"1/2	120	60	61	

**ADATTATORE A T
ORIENT. CON FILET.
CENTR. GAS CIL.**

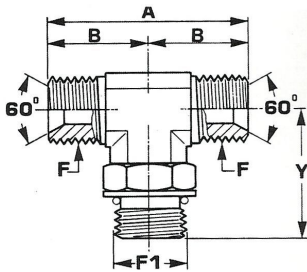

CODICE	F GAS CIL	F1 GAS CIL	A	B	Y	
04RCMG04	1/4	1/4	54	27	31,5	
04RCMG06-04	3/8	1/4	63	31,5	33,5	
04RCMG06	3/8	3/8	63	31,5	36,5	
04RCMG08-06	1/2	3/8	74	37	39,5	
04RCMG08	1/2	1/2	74	37	43	
04RCMG12-08	3/4	1/2	80	40	45,5	
04RCMG12	3/4	3/4	80	40	49	
04RCMG16-12	1"	3/4	100	50	52	
04RCMG16	1"	1"	100	50	52	
04RCMG20-16	1"1/4	1"	104	52	57	
04RCMG20	1"1/4	1"1/4	104	52	57	
04RCMG24	1"1/2	1"1/2	118	59	61	

**ADATTATORE A T
ORIENT. CON FILET.
LATERALE GAS CIL.**

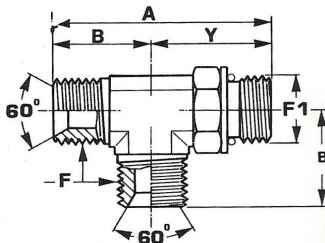

CODICE	F GAS CIL	F1 GAS CIL	A	B	Y	
04RLMG04	1/4	1/4	58,5	27	31,5	
04RLMG06-04	3/8	1/4	65	31,5	33,5	
04RLMG06	3/8	3/8	68,5	31,5	36,5	
04RLMG08-06	1/2	3/8	76	37	39	
04RLMG08	1/2	1/2	80	37	43	
04RLMG12-08	3/4	1/2	85,5	40	45,5	
04RLMG12	3/4	3/4	89	40	49	
04RLMG16-12	1"	3/4	102	50	52	
04RLMG16	1"	1"	102	50	52	
04RLMG20-16	1"1/4	1"	109	52	57	
04RLMG20	1"1/4	1"1/4	109	52	57	
04RLMG24	1"1/2	1"1/2	120	59	61	

**ADATTATORE A T
INTERMEDIO FIL. GAS
CILINDRICA**

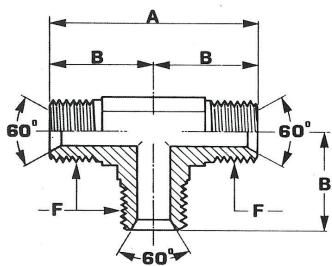

CODICE	F GAS CIL	A	B			
04MM02	1/8"	40	20			
04MM04	1/4"	54	27			
04MM06	3/8"	60	30			
04MM08	1/2"	74	37			
04MM10	5/8"	80	40			
04MM12	3/4"	80	40			
04MM16	1"	100	50			
04MM20	1 1/4"	104	52			
04MM24	1 1/2"	118	59			

**TAPPO FEMMINA GAS
SEDE OGIVA**

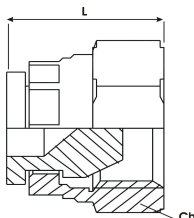

CODICE	Filetto	L	CH			
05TF02	1/8-28	14	15			
05TF04	1/4-19	19	17			
05TF06	3/8-19	22	20			
05TF08	1/2-14	27	23			
05TF10	5/8-14	30	25,5			
05TF12	3/4-14	32	28			
05TF16	1-11	38	29			
05TF20	1.1/4-11	50	35			
05TF24	1.1/2-11	55	39			
05TF32	2-11	70	44			

**TAPPO MASCHIO
GAS CIL. TESTA
ESAGONALE**

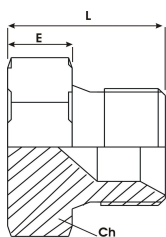

CODICE	Filetto	L	E	CH		
05TM02	1/8-28	15,5	6	14		
05TM04	1/4-19	18	7	19		
05TM06	3/8-19	20	8	22		
05TM08	1/2-14	23	9	27		
05TM10	5/8-14	26	10	30		
05TM12	3/4-14	26	10	32		
05TM16	1-11	31	12	41		
05TM20	1.1/4-11	34	14	50		
05TM24	1.1/2-11	36	14	55		
05TM32	2-11	43	17	70		

**VITE FORATA GAS
SINGOLA**

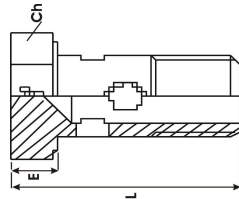

CODICE	F	L	E	CH	
06VS02	1/8-28	26	5	14	
06VS04	1/4-19	38	8	19	
06VS06	3/8-19	40,5	8,5	22	
06VS08	1/2-14	48	9,5	27	
06VS10	5/8-14	55	10	30	
06VS12	3/4-14	56	9,5	32	
06VS16	1-11	68	13,5	41	
06VS20	1.1/4-11	85	13,5	50	
06VS24	1.1/2-11	95	15	55	

**VITE FORATA GAS
DOPPIA**

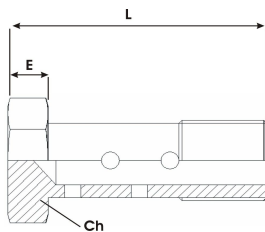

CODICE	Filetto	L	E	CH	
06VD02	1/8-28	38,5	6	14	
06VD04	1/4-19	50	7	19	
06VD06	3/8-19	58	8	22	
06VD08	1/2-14	72	9	27	
06VD12	3/4-14	89	11	32	
06VD16	1-11	106	12	41	

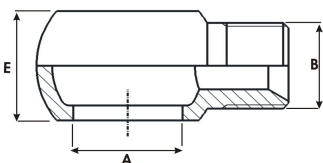
**OCCHIO FILETTATO
GAS SENZA BATTUTA**

CODICE	Filetto A	Filetto B	L	E		
07OF02-02	1/8-28	1/8-28	27	11		
07OF04-04	1/4-19	1/4-19	36	14		
07OF06-04	3/8-19	1/4-19	41	17		
07OF06-06	3/8-19	3/8-19	42	17		
07OF06-08	3/8-19	1/2-14	48	20		
07OF08-06	1/2-14	3/8-19	50	22		
07OF08-08	1/2-14	1/2-14	50	22		
07OF12-08	3/4-14	1/2-14	63	29		
07OF12-12	3/4-14	3/4-14	60	30		
07OF16-12	1-11	3/4-14	69	34		
07OF16-16	1-11	1-11	82	38		
07OF10-10	5/8-14	5/8-14	54	24		
07OF14-04	14	1/4-19	36	14		
07OF18-06	18	3/8-19	49	21		
07OF18-08	18	1/2-14	50	21		
07OF20-08	1.1/4-11	1/2-14	50	22		

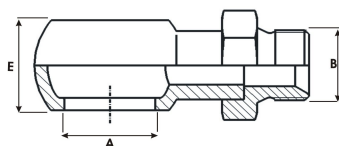
**OCCHIO FILETTATO
GAS CON BATTUTA**

CODICE	Filetto A	Filetto B	L	E	CH	
07OFB0404	1/4-19	1/4-19	51	14	17	
07OFB0606	3/8-19	3/8-19	57	17	22	
07OFB0808	1/2-14	1/2-14	69	22	22	
07OFB06-04	3/8-19	1/4-19	45	20	25	
07OFB06-08	3/8-19	1/2-14	62	17	27	
07OFB08-06	1/2-14	3/8-19	66	22	32	
07OFB18-06	18	3/8-19	75	22	38	
07OFB18-08	18	1/2-14	75	22	38	

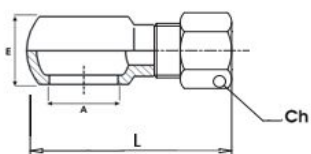
**OCCHIO FILETTO F.
GAS GIREVOLE**

CODICE	Filetto A	Filetto B	L	E	CH	
07OFG04-04	1/4-19	1/4-19	52	14	19	
07OFG06-06	3/8-19	3/8-19	62	18	22	
07OFG08-08	1/2-14	1/2-14	72	22	27	

OCCHIO FILETTATO
M/M GAS DOPPIA VIA

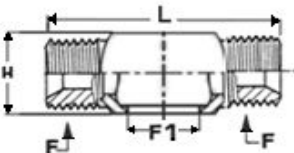

CODICE	Filetto F	Filetto F1	L	H	
07OFD04-04	1/4-19	1/4-19	48	14	
07OFD06-06	3/8-19	3/8-19	56	18	
07OFD18-08	1/2-14	18	56	20	

CANNETTE CON
OCCHIO

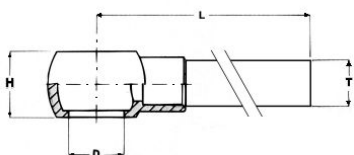

CODICE	D	H	L	T	
07OT04-8-550	1/4"	14	550	8	
07OT04-10-65	1/4"	14	65	10	
07OT04-10-100	1/4"	14	100	10	
07OT04-10-200	1/4"	14	200	10	
07OT04-10-300	1/4"	14	300	10	
07OT04-12-100	1/4"	14	100	12	
07OT04-12-150	1/4"	14	150	12	
07OT04-12-175	1/4"	14	175	12	
07OT04-12-200	1/4"	14	200	12	
07OT04-12-250	1/4"	14	250	12	
07OT06-12-33	3/8"	17	33	12	
07OT06-12-43	3/8"	17	43	12	
07OT06-12-60	3/8"	17	60	12	
07OT06-12-65	3/8"	17	65	12	
07OT06-12-70	3/8"	17	70	12	
07OT06-12-100	3/8"	17	100	12	
07OT06-12-150	3/8"	17	150	12	
07OT06-12-200	3/8"	17	200	12	
07OT06-12-400	3/8"	17	400	12	
07OT06-12-589	3/8"	17	589	12	
07OT08-15-100	1/2"	22	100	15	
07OT08-15-200	1/2"	22	200	15	
07OT08-15-300	1/2"	22	300	15	
07OT08-15-400	1/2"	22	400	15	
07OT08-15-500	1/2"	22	500	15	

* FORNIBILI ALTRE MISURE SU RICHIESTA

OCCHIO A SALDARE

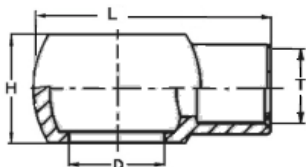

CODICE	D	H	L	T	
07OS02-6	1/8"	10	28	6	
07OS04-6	1/4"	14	36	6	
07OS04-8	1/4"	14	36	8	
07OS04-10	1/4"	14	36	10	
07OS04-12	1/4"	14	36	12	
07OS06-4	3/8"	18	42	4	
07OS06-8	3/8"	18	42	8	
07OS06-10	3/8"	18	42	10	
07OS06-12	3/8"	18	42	12	
07OS06-12X40	3/8"	18	80	12	
07OS06-12X80	3/8"	18	120	12	
07OS06-14	3/8"	18	48	14	
07OS08-6	8	8	22	6	
07OS08-12	1/2"	22	50	12	
07OS08-14	1/2"	22	50	14	
07OS08-15	1/2"	22	50	15	
07OS08-16	1/2"	22	50	16	
07OS08-18	1/2"	22	50	18	
07OS10-4	10	10	28	4	
07OS10-6	10	10	28	6	
07OS10-8	10	12	32	8	
07OS10-18	5/8"	23	52	18	
07OS12-6	12	12	32	6	
07OS12-8	12	12	32	8	
07OS12-20	3/4"	26	55	20	
07OS12-22	3/4"	28	55	22	
07OS14-8	14	14	36	8	
07OS14-10	14	14	36	10	
07OS14-12	14	14	36	12	
07OS16-10	16	16	70	10	
07OS16-12	16	16	70	12	
07OS16-25	1"	36	75	25	
07OS16-27	1"	36	75	27	
07OS16-28	1"	36	75	28	
07OS18-10	18	20	45	10	
07OS18-12	18	20	45	12	
07OS18-14	18	20	45	14	
07OS18-15	18	20	45	15	
07OS18-16	18	20	45	16	
07OS18-18	18	20	45	18	
07OS20-14	20	22	55	14	
07OS20-15	20	22	55	15	
07OS20-30	1.1/4"	24	70	30	
07OS22-15	22	26	60	15	
07OS22-16	22	26	60	16	
07OS22-18	22	26	60	18	
07OS24-17	24	28	65	17	
07OS24-18	24	28	65	18	
07OS24-35	1.1/2"	28	70	35	
07OS30-20	30	34	75	20	

OGGIVA CON DADO LIBERO A SALDARE

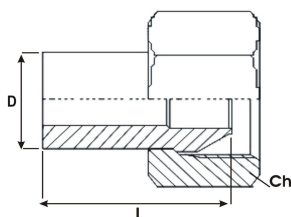

CODICE	Filetto	L	D	CH	
08SL04	1/4-19	30	9	17	
08SL06	3/8-19	39	13	22	
08SL08	1/2-14	41	16	27	
08SL12	3/4-14	40,5	22	32	
08SL16	1-11	47,6	25	38	
08SL20	1.1/4-11	55	36	50	
08SL32	2-11	53	51	65	

OGGIVA CON DADO PRESSATO A SALDARE DI TASCA

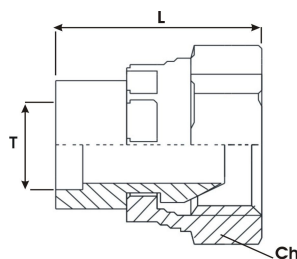

CODICE	Filetto	L	T	CH	
08OSS04	1/4-19	18	8	19	
08OSS06	3/8-19	28	12	22	
08OSS08	1/2-14	31	14	27	
08OSS10	5/8-14	34	17	28	
08OSS12	3/4-14	36	21	32	
08OSS16	1-11	41,5	26	41	
08OSS20	1.1/4-11	40	32	50	
08OSS24	1.1/2-11	42	38	55	

**BORCHIA FILETTATA
F. A SALDARE**

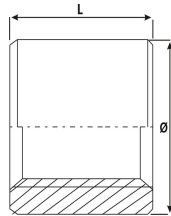

CODICE	Filetto	L	Ø			
09BS02	1/8-28	13	17			
09BS04	1/4-19	16	20			
09BS06	3/8-19	17	26			
09BS08	1/2-14	18	30			
09BS10	5/8-14	19	32			
09BS12	3/4-14	20	38			
09BS16	1-11	25	46			
09BS20	1.1/4-11	26	56			
09BS24	1.1/2-11	30	62			
09BS32	2-11	30	75			
09BS40	2.1/2-11	40	90			
09BS48	3-11	40	105			

**BORCHIA DOPPIA
FILETTATA F. A
SALDARE**

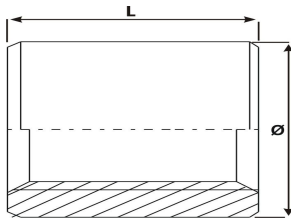

CODICE	Filetto	L	Ø			
09BSD04	1/4-19	32	20			
09BSD06	3/8-19	34	26			
09BSD08	1/2-14	36	30			
09BSD12	3/4-14	40	38			
09BSD16	1-11	50	46			
09BSD20	1.1/4-11	52	56			
09BSD24	1.1/2-11	60	62			
09BSD32	2-11	60	75			

**MANICOTTO
FILETTATO M. A
SALDARE**

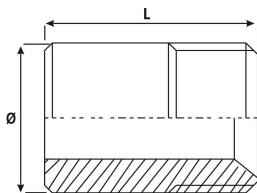

CODICE	Filetto	L	Ø			
09MS02	1/8-28	20	10			
09MS04	1/4-19	30	13			
09MS06	3/8-19	30	17			
09MS08	1/2-14	32	21			
09MS10	5/8-14	41	23			
09MS12	3/4-14	32.5	27			
09MS16	1-11	41	33			
09MS20	1.1/4-11	50	42			
09MS24	1.1/2-11	50	48			
09MS32	2-11	54	59.5			

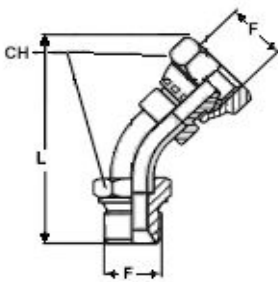
**ADATTATORE A 45°
M/F GIREVOLE GAS
CIL.**

CODICE	F	L	CH			
12AQ02	1/8-28	55	14			
12AQ04	1/4-19	65	19			
12AQ06	3/8-19	75	22			
12AQ08	1/2-14	85	27			
12AQ10	5/8-14	90	27			
12AQ12	3/4-14	100	32			
12AQ16	1-11	120	38			
12AQ20	1.1/4-11	130	50			
12AQ24	1.1/2-11	130	55			
12AQ32	2-11	160	65			

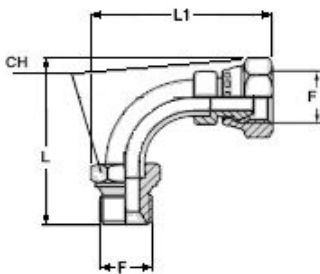
**ADATTATORE A 90°
M/F GIREVOLE GAS
CIL.**

CODICE	F	L	L1	CH		
12AN02	1/8-28	45	40	14		
12AN04	1/4-19	50	45	19		
12AN06	3/8-19	60	55	22		
12AN08	1/2-14	70	60	27		
12AN10	5/8-14	75	70	30		
12AN12	3/4-14	80	80	32		
12AN16	1-11	105	100	41		
12AN20	1.1/4-11	130	130	50		
12AN24	1.1/2-11	130	130	55		
12AN32	2-11	160	160	70		

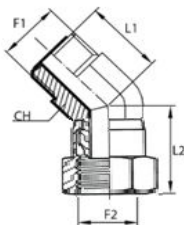
**ADATTATORE A 45°
M/F GIREVOLE GAS
CIL. - COMPATTO**

CODICE	F1 GAS CIL	F2 GAS CIL	L1	L2		
12AQST04	1/4"	1/4"	27	29		
12AQST06	3/8"	3/8"	31.5	34		
12AQST08	1/2"	1/2"	37	40		
12AQST12	3/4"	3/4"	40	46		
12AQST16	1"	1"	50	51.5		
12AQST20	1"1/4	1"1/4	52	57		
12AQST24	1"1/2	1"1/2	59	64		

**ADATTATORE A 90°
M/F GIREVOLE GAS
CIL. - COMPATTO**

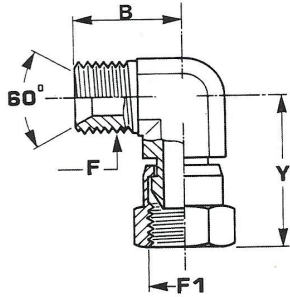

CODICE	F GAS CIL	F1 GAS CIL	B	Y		
12ANST04	1/4"	1/4"	27	29		
12ANST06	3/8"	3/8"	31.5	34		
12ANST08	1/2"	1/2"	37	40		
12ANST10	5/8"	5/8"	36	42		
12ANST12	3/4"	3/4"	40	46		
12ANST16	1"	1"	50	51.5		
12ANST20	1"1/4	1"1/4	52	57		
12ANST24	1"1/2	1"1/2	59	64		

**ADATTATORE A 45°
F/F GIREVOLE GAS**

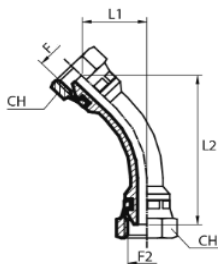

CODICE	F	L1	L2	CH		
14AQ04	1/4-19	18	52	19		
14AQ06	3/8-19	24	66	22		
14AQ08	1/2-14	28	78	27		
14AQ10	5/8-14	31	73	28		
14AQ12	3/4-14	33	101	32		
14AQ16	1-11	37	115	38		
14AQ20	1.1/4-11	37	119	50		
14AQ24	1.1/2-11	39	125	55		
14AQ32	2-11	41	132	70		

**ADATTATORE A 90°
F/F GIREVOLE GAS**

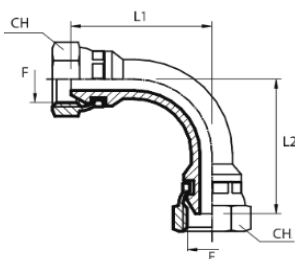

CODICE	F	L1	L2	CH		
14AN02	1/8-28	29	31	15		
14AN04	1/4-19	29	31	19		
14AN06	3/8-19	39	44	22		
14AN08	1/2-14	44	50	27		
14AN10	5/8-14	48	50	28		
14AN12	3/4-14	60	65	32		
14AN16	1-11	70	83	38		
14AN20	1.1/4-11	67	70	50		
14AN24	1.1/2-11	80	95	55		
14AN32	2-11	120	115	70		

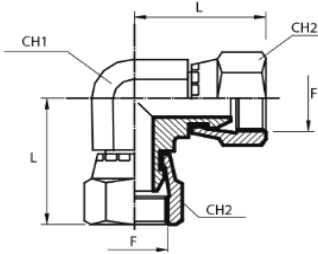
**ADATTATORE
COMPATTO A 90°
F/F GIREVOLE**

CODICE	F	L	CH1	CH2		
14ANST04	1/4-19	31	14	19		
14ANST06	3/8-19	36	19	22		
14ANST08	1/2-14	39	22	27		
14ANST12	3/4-14	45	27	32		
14ANST16	1-11	50	33	38		
14ANST20	1.1/4-11	64	41	50		
14ANST24	1.1/2-11	78	50	55		

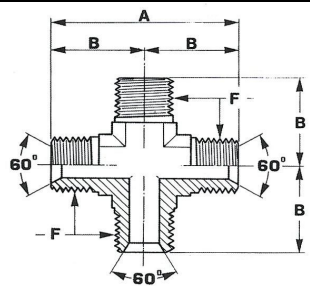
**RACCORDO A CROCE
MASCHIO GAS
CILINDRICA**

CODICE	F GAS CIL.	A	B			
19MM02	1/8"	40	20			
19MM04	1/4"	54	27			
19MM06	3/8"	60	30			
19MM08	1/2"	70	35			
19MM10	5/8"	80	40			
19MM12	3/4"	80	40			
19MM16	1"	96	48			

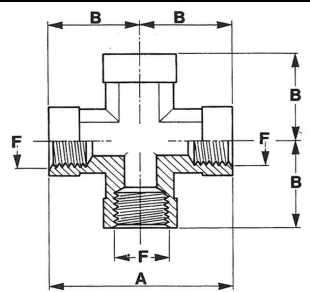
**RACCORDO A CROCE
FEMM. GAS
CILINDRICA**

CODICE	F GAS CIL.	A	B			
19FF02	1/8"	34	17			
19FF04	1/4"	44	22			
19FF06	3/8"	52	26			
19FF08	1/2"	62	31			
19FF12	3/4"	70	35			

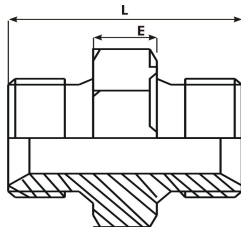
**NIPPOLO M/M
METRICO**

CODICE	F	L	E	CH		
01NP10C	10X1	22	6	14		
01NP12A	12X1,5	27	7	17		
01NP14A	14X1,5	31	7	19		
01NP16A	16X1,5	33	7	22		
01NP18A	18X1,5	36	8	24		
01NP20A	20X1,5	36	8	25		
01NP22A	22X1,5	38	8	27		
01NP24A	24X1,5	39	9	30		
01NP26A	26X1,5	43	9	32		
01NP30A	30X1,5	43	10	36		

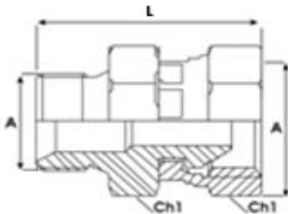
**NIPPOLO METRICO M/F
GIREVOLE**

CODICE	Filetto A	L	CH			
01MG14A	14X1,5	35	19			
01MG16A	16X1,5	37	22			
01MG18A	18X1,5	37	24			
01MG20A	20X1,5	42	27			
01MG22A	22X1,5	44	27			
01MG26A	26X1,5	49	32			

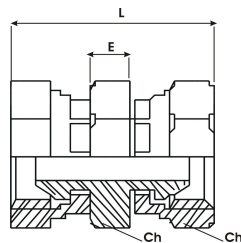
**GIUNZIONE METRICA
F/F GIREVOLE**

CODICE	Filetto	L	E	CH1	CH2	
01FG14A	14X1,5	40	7	19	17	
01FG16A	16X1,5	42	7	22	22	
01FG18A	18X1,5	43	7	24	24	
01FG20A	20X1,5	49	8	27	27	
01FG22A	22X1,5	49	8	27	27	
01FG24A	24X1,5	53	10	27	30	

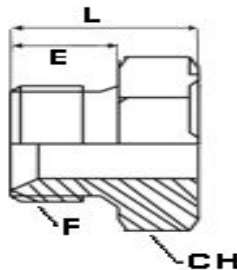
**MEZZO NIPPLO
METRICO A SALDARE**

CODICE	F	L	E	CH	
01NS10C	10X1	15	8	15	
01NS12A	12X1,5	18	11	17	
01NS14A	14X1,5	19	12	19	
01NS16A	16X1,5	21	13	22	
01NS18A	18X1,5	21	13	22	
01NS20A	20X1,5	23	14	27	
01NS22A	22X1,5	23	15	27	
01NS24A	24X1,5	25	16	30	
01NS26A	26X1,5	26	16	32	
01NS30A	30X1,5	29	18	36	

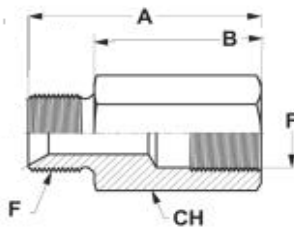
**COLONNETTA
METRICA M/F**

CODICE	F	A	B	CH	
01MF10C-20	10X1	29	20	14	
01MF10C-30	10X1	39	30	14	
01MF12A-20	12X1,5	32	20	17	
01MF12A-40	12X1,5	52	40	17	
01MF14A-20	14X1,5	32	20	19	
01MF14A-25	14X1,5	37	25	19	
01MF14A-35	14X1,5	47	35	19	
01MF14A-40	14X1,5	52	40	19	
01MF14A-50	14X1,5	62	50	19	
01MF16A-20	16X1,5	33	20	22	
01MF16A-35	16X1,5	48	35	22	
01MF16A-40	16X1,5	53	40	22	
01MF18A-20	18X1,5	35	20	24	
01MF18A-25	18X1,5	40	25	24	
01MF18A-30	18X1,5	45	30	24	
01MF18A-33	18X1,5	48	33	24	
01MF18A-40	18X1,5	55	40	24	
01MF18A-45	18X1,5	60	45	24	
01MF18A-50	18X1,5	65	50	24	
01MF18A-80	18X1,5	95	80	24	
01MF20A-45	20X1,5	60	45	27	
01MF22A-25	22X1,5	40	25	28	
01MF22A-45	22X1,5	60	45	28	
01MF22A-60	22X1,5	75	60	28	

**COLONNETTA
METRICA F/F**

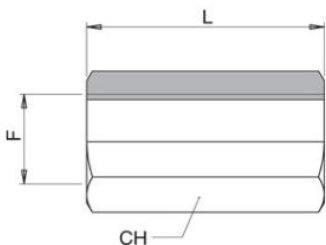

CODICE

F

L

CH

CODICE	F	L	CH		
01FF10C-25	10X1	25	14		
01FF12A-25	12X1,5	25	17		
01FF12A-35	12X1,5	35	17		
01FF12C-25	12X1	25	17		
01FF14A-35	14X1,5	35	19		
01FF16A-35	16X1,5	35	22		
01FF16A-45	16X1,5	45	22		
01FF18A-45	18X1,5	45	24		
01FF22A-70	22X1,5	70	27		

**RIDUZIONE
COMPATTA F GAS /
M METRICO**

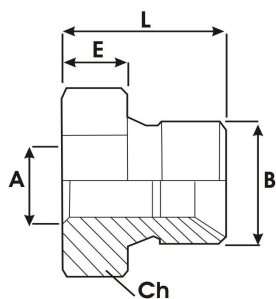

CODICE

Filetto A

Filetto B

L

E

CH

CODICE	Filetto A	Filetto B	L	E	CH
02FMB04-18A	1/4-19	18X1,5	20	7	22
02FMB04-22A	1/4-19	22X1,5	22	8	27
02FMB16A-14A	16X1,5	14X1,5	33	22	21
02FMB06-10C	3/8-19	10X1	20	7	21
02FMB12-18A	3/4-14	18X1,5	27	10	32
02FMB14A-18A	14X1,5	18X1,5	21	7	22
02FMB16A-20A	1-11	20X1,5	23	9	27

**RIDUZIONE F
METRICO / M GAS**

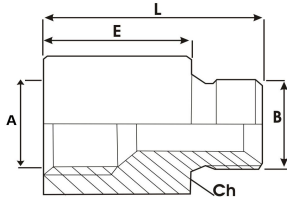

CODICE	Filetto A	Filetto B	L	E	CH
02FM10C-04	10X1	1/4-19	24.5	13	17
02FM02-16A	16X1,5	1/8-28	33	20	22
02FM12A-04	12X1,5	1/4-19	24	14	17
02FM14A-04	14X1,5	1/4-19	27	16	17
02FM16A-04	16X1,5	1/4-19	33	22	22
02FM18A-04	18X1,5	1/4-19	34	22	24
02FM20A-04	20X1,5	1/4-19	37	26	27
02FM14A-06	14X1,5	3/8-19	32	20	22
02FM16A-06	16X1,5	3/8-19	32	19	22
02FM18A-06	18X1,5	3/8-19	35	22	24
02FM14A-08	14X1,5	1/2-14	34	20	27
02FM16A-08	16X1,5	1/2-14	34	20	27
02FM18A-08	18X1,5	1/2-14	34	20	27
02FM22A-14A	22X1,5	14X1,5	30	21	27
02FM22A-16A	16X1,5	16X1,5	34	21	27

**RIDUZIONE F GAS / M
METRICI**

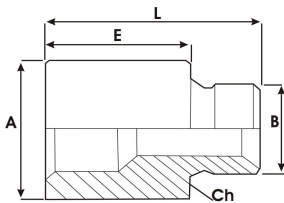

CODICE	Filetto A	Filetto B	L	E	CH
02FM02-10C	1/8-28	10X1	27	17	14
02FM04-10C	1/4-19	10X1	30	20	19
02FM04-16A	1/4-19	16X1,5	33	20	22
02FM04-18A	1/4-19	18X1,5	34	21	24
02FM04-20A	1/4-19	20X1,5	33	19	27
02FM06-14A	3/8-19	14X1,5	30	19	22
02FM06-16A	3/8-19	16X1,5	32	19	22
02FM06-18A	3/8-19	18X1,5	33	20	24
02FM06-22A	3/8-19	22X1,5	35	22	27
02FM08-18A	1/2-14	18X1,5	34	21	27
02FM08-22A	1/2-14	22X1,5	36	21	27
02FM12-18A	3/4-14	18X1,5	39	26	32
02FM12-22A	3/4-14	22X1,5	42	28	32
02FM12-26A	3/4-14	26X1,5	44	28	32
02FM14A-10C	14X1,5	10X1	30	20	19
02FM20A-08	20X1,5	1/2-14	38	25	27
02FM22A-08	22X1,5	1/2-14	36	21	27
02FM14A-16A	14X1,5	16X1,5	33	20	22

**GIUNZIONE M GAS / F
GIREVOLE METRICA**

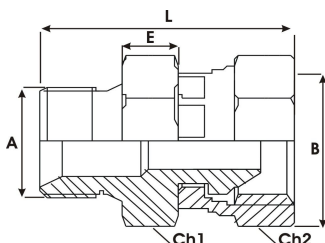

CODICE	Filetto A	Filetto B	L	CH1	CH2
02MG04-12A	1/4-19	12X1,5	32	17	17
02MG04-14A	1/4-19	14X1,5	32	17	17
02MG04-16A	1/4-19	16X1,5	35	19	22
02MG04-18A	1/4-19	18X1,5	42	24	19
02MG06-16A	3/8-19	16X1,5	40	22	22
02MG06-18A	3/8-19	18X1,5	39	22	22
02MG08-18A	1/2-14	18X1,5	43	27	22
02MG08-22A	1/2-14	22X1,5	41	27	27
02MG12-18A	3/4-14	18X1,5	53	31	24
02MG12-22A	3/4-14	22X1,5	48	32	27
02MG16A-18A	18X1,5	16X1,5	41	24	22
02MG18A-16A	16X1,5	18X1,5	39	22	22

**NIPPLO M/M DI
RIDUZIONE
GAS/METRICA**

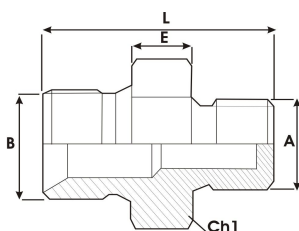

CODICE	Filetto A	Filetto B	L	E	CH
02NR02-10C	1/8-28	10X1	25	6	14
02NR04-10C	1/4-19	10X1	25	7	17
02NR04-10A	1/4-19	10X1,5	28	6	19
02NR04-12A	1/4-19	12X1,5	29	7	19
02NR04-14A	1/4-19	14X1,5	28	7	19
02NR04-16A	1/4-19	16X1,5	30	7	22
02NR04-18A	1/4-19	18X1,5	30	7	22
02NR06-12A	3/8-19	12X1,5	31	8	22
02NR06-14A	3/8-19	14X1,5	30	7	22
02NR06-16A	3/8-19	16X1,5	33	8	22
02NR06-18A	3/8-19	18X1,5	35	8	24
02NR06-20A	3/8-19	20X1,5	35	8	27
02NR06-22A	3/8-19	22X1,5	35	8	27
02NR08-14A	1/2-14	14X1,5	36	10	27
02NR08-16A	1/2-14	16X1,5	35	8	27
02NR08-18A	1/2-14	18X1,5	36	8	27
02NR08-20A	1/2-14	20X1,5	37	8	27
02NR08-22A	1/2-14	22X1,5	36	8	27
02NR08-24A	1/2-14	24X1,5	39	9	30
02NR08-26A	1/2-14	26X1,5	40	9	32
02NR10-18A	5/8-14	18X1,5	40	10	27
02NR10-22A	5/8-14	22X1,5	40	10	27
02NR12-18A	3/4-14	18X1,5	39	9	32
02NR12-22A	3/4-14	22X1,5	41	9	32
02NR12-24A	3/4-14	24X1,5	43	10	32
02NR12-26A	3/4-14	26X1,5	41	9	32
02NR16-26A	1-11	26X1,5	48	12	40
02NR16-30A	1-11	30X1,5	46	10	38
02NR12-33B	3/4-14	33X2	48	13	40
02NR12-30A	3/4-14	30X1,5	42	10	32

**RACCORDO MASCHIO
A T METRICO**

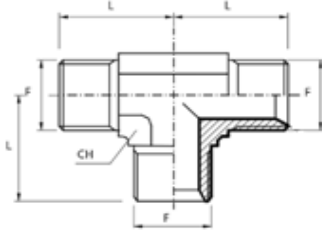

CODICE	F	L	CH			
04MW14A	14X1,5	27	14			
04MW16A	16X1,5	29	19			
04MW18A	18X1,5	29	19			
04MW22A	22X1,5	36,5	22			

**TAPPO METRICO
FEMMINA SEDE
OGIVA**

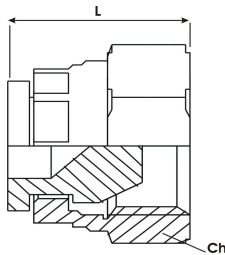

CODICE	L	CH				
05TF10C	17	15				
05TF14A	17	19				
05TF16A	19	22				
05TF18A	20	24				
05TF20A	22	27				
05TF22A	22	27				
05TF26A	25	32				

**TAPPO MASCHIO
METRICO TESTA
ESAGONALE**

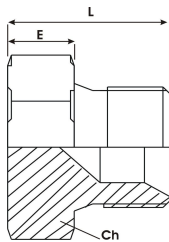

CODICE	L	E	CH			
05TM10C	14	6	14			
05TM12A	17	6	17			
05TM14A	18	7	19			
05TM16A	20	8	22			
05TM18A	21	8	24			
05TM20A	24	9	28			
05TM22A	24	9	28			
05TM24A	24	9	30			
05TM26A	25	9	32			
05TM30A	26	10	36			

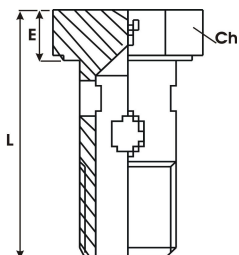
**VITE FORATA FIL.
METRICO**

CODICE	Filetto A	L	E	CH		
06VS10C	10X1	26	5	14		
06VS10A	10X1,5	27	6	14		
06VS14A	14X1,5	38	8	19		
06VS16A	16X1,5	40	8	22		
06VS18A	18X1,5	44	8,5	24		
06VS20A	20X1,5	45	8	27		
06VS22A	22X1,5	50	9	27		
06VS24A	24X1,5	49	9	30		
06VS26A	26X1,5	57	9,5	32		
06VS8D	8	29	4	13		
06VS6C	6X1	20	4	10		
06VS8C	8X1	22	4,5	12		
06VS10D	10	26	5	14		
06VS12C	12X1	28	5	17		
06VS12D	12	28	5	17		
06VS24B	24X2	56	10	30		
06VS30A	30X1,5	67	9	38		

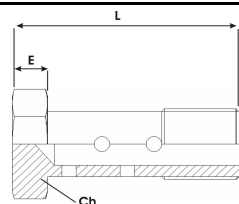
**VITE FORATA DOPPIA
FIL. METRICO**

CODICE	Filetto A	L	E	CH		
06VD10C	10X1	39	6	14		
06VD12A	12X1,5	47	7	17		
06VD14A	14X1,5	49	6,5	19		
06VD16A	16X1,5	58	8	22		
06VD18A	18X1,5	65	8	24		
06VD8C	8X1	30	4	12		
06VD12C	12X1,5	47	7	17		

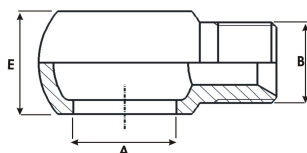
**OCCHIO FILETTATO
METRICO SENZA
BATTUTA**

CODICE	Filetto A	Filetto B	L	E		
07OF04-14A	1/4-19	14X1,5	36	14		
07OF06-16A	3/8-19	16X1,5	40	17		
07OF06-18A	3/8-19	18X1,5	44	20		
07OF08-18A	1/2-14	18X1,5	48	23		
07OF14-14A	ø 14	14X1,5	36	15		
07OF16-16A	ø 16	16X1,5	40	18		
07OF18-18A	ø 18	18X1,5	46	20		
07OF18-22A	ø 18	22X1,5	50	22		
07OF22-22A	ø 22	22X1,5	49	22		

**BORCHIA FILETTATA
F A SALDARE
METRICA**

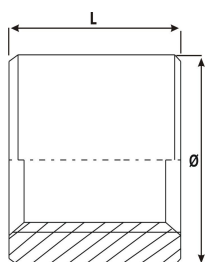

CODICE	F	L	Ø		
09BS10C	10X1	14	18		
09BS12A	12X1,5	14	20		
09BS14A	14X1,5	16	22		
09BS16A	16X1,5	17	26		
09BS18A	18X1,5	18	28		
09BS20A	20X1,5	18	28		
09BS22A	22X1,5	18	30		

**MANICOTTO
FILETTATO M A
SALDARE METRICA**

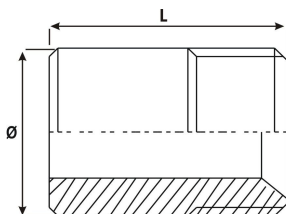

CODICE	F	L	Ø		
09MS14A	14X1,5	33	14		
09MS16A	16X1,5	35	16		
09MS18A	18X1,5	35	18		
09MS20A	20X1,5	38,5	20		

**ADATTATORE A 45°
M/F GIREVOLE
METRICO**

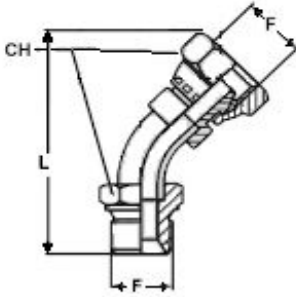

CODICE	F	L	CH		
12AQ10C	10X1	50	15		
12AQ12A	12X1,5	50	17		
12AQ14A	14X1,5	60	19		
12AQ16A	16X1,5	70	22		
12AQ18A	18X1,5	85	24		
12AQ20A	20X1,5	85	27		
12AQ22A	22X1,5	85	27		

**ADATTATORE A 90°
M/F GIREVOLE
METRICO**

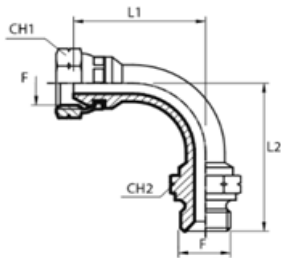

CODICE	F	L1	L2	CH	
12AN12A	12X1,5	35	33	17	
12AN14A	14X1,5	28	30	19	
12AN16A	16X1,5	39	48	22	
12AN18A	18X1,5	41	48	24	
12AN20A	20X1,5	44,5	61,5	27	
12AN22A	22X1,5	44,5	61,5	27	
12AN26A	26X1,5	54	69	30	

**ADATTATORE A 90°
F/F GIREVOLE
METRICO**

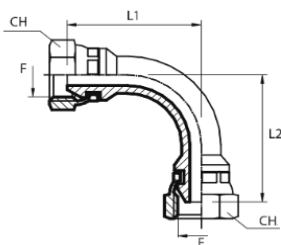

CODICE	F	L1	L2	CH	
14AN10C	10X1	29	31	15	
14AN12A	12X1,5	29	31	17	
14AN14A	14X1,5	30	30	19	
14AN16A	16X1,5	43	43	22	
14AN18A	18X1,5	43	43	22	
14AN20A	20X1,5	48	48	27	
14AN22A	22X1,5	47	47	27	
14AN26A	26X1,5	61	61	32	

**NIPPLIO MASCHIO
ORFS**

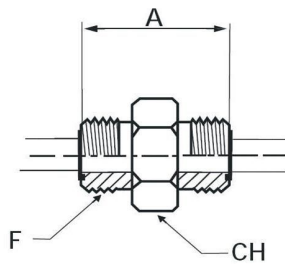

CODICE	F	A	CH		
01NP04FRS	9/16-18	27.5	17		
01NP06FRS	11/16-16	31	19		
01NP08FRS	13/16-16	35.5	22		
01NP10FRS	1-14	42.5	27		
01NP12FRS	1-3/16-12	47	32		
01NP16FRS	1-7/16-12	49.5	41		
01NP20FRS	1-11/16-12	51.5	46		
01NP24FRS	2-12	53	55		

**RACCORDO ORFS
PASSAPARETE**

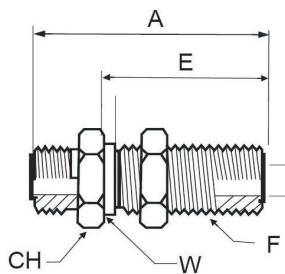

CODICE	F	A	E	W	CH
01PSP04FRS	9/16-18	48	31,5	14.28	22
01PSP06FRS	11/16-16	53	34	17.45	27
01PSP08FRS	13/16-16	58,5	36,5	20.63	30
01PSP10FRS	1-14	66,5	40,5	25.4	36
01PSP12FRS	1-3/16-12	70	42	36.5	41
01PSP16FRS	1-7/16-12	70	42	36.5	46
01PSP20FRS	1-11/16-12	70	42	42.8	50
01PSP24FRS	2-12	70	42	50.8	60

disponibili anche a 90° (cod. 01PSP90--FRS)

**MEZZO NIPPO A
SALDARE ORFS**

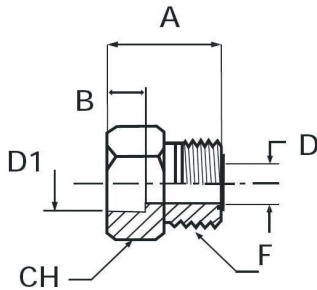

CODICE	F	A	S	D	D1
01NS04FRS	9/16-18	22	8.5	6.15	5
01NS04FRS	9/16-18	22	8.5	10.15	5
01NS06FRS	11/16-16	23	8.5	10.15	6.5
01NS06FRS	11/16-16	23	8.5	12.15	6.5
01NS08FRS	13/16-16	24.5	8.5	12.5	9.5
01NS08FRS	13/16-16	24.5	8.5	16.15	9.5
01NS10FRS	1-14	27.5	9.5	16.15	12.5
01NS10FRS	1-14	27.5	9.5	18.15	12.5
01NS12FRS	1-3/16-12	33.5	12.5	18.5	15.5

**RACCORDO DIRITTO
ORFS / GAS CIL.**

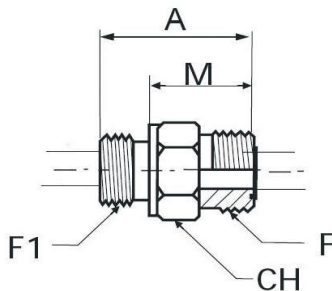

CODICE	F	F1 GAS	A	M	CH
02NR02-04FRS	9/16-18	1/8-28	25,5	17,5	17
02NR04-04FRS	9/16-18	1/4-19	30,5	18,5	19
02NR06-04FRS	9/16-18	3/8-19	31,5	19,5	22
02NR08-04FRS	9/16-18	1/2-14	35,5	24,5	27
02NR02-06FRS	11/16-16	1/8-28	31	23	19
02NR04-06FRS	11/16-16	1/4-19	32	20	19
02NR08-06FRS	11/16-16	1/2-14	37	24,5	27
02NR12-06FRS	11/16-16	3/4-14	40,5	24,5	32
02NR06-06FRS	11/16-16	3/8-16	33	21,5	22
02NR04-08FRS	13/16-16	1/4-19	34,5	25,5	22
02NR06-08FRS	13/16-16	3/8-19	34,5	22,5	22
02NR08-08FRS	13/16-16	1/2-14	38,5	24,5	27
02NR12-08FRS	13/16-16	3/4-14	42	26	32
02NR06-10FRS	1-14	3/8-19	43	32	27
02NR08-10FRS	1-14	1/2-14	41	27	27
02NR12-10FRS	1-14	3/4-14	44,5	28,5	32
02NR16-10FRS	1-14	1-11	48	30	41
02NR08-12FRS	1-3/16-12	1/2-14	48,5	34,5	32
02NR12-12FRS	1-3/16-12	3/4-14	46	30	32
02NR16-12FRS	1-3/16-12	1-11	49	31	41
02NR20-12FRS	1-3/16-12	1-1/4-11	53,5	33,5	50
02NR12-16FRS	1-7/16-12	3/4-14	52	36	41
02NR16-16FRS	1-7/16-12	1-11	50	31,5	41
02NR20-16FRS	1-7/16-12	1-1/4-11	54	34	50
02NR24-16FRS	1-7/16-12	1-1/2-11	57,5	35,5	55
02NR16-20FRS	1-11/16-12	1-11	57,5	39,5	46
02NR20-20FRS	1-11/16-12	1-1/4-11	54	34	50
02NR24-20FRS	1-11/16-12	1-1/2-11	57,5	35,5	50
02NR32-24FRS	2-12	2-11	57,5	35,5	55

**RACCORDO DIRITTO
ORFS / UNF-2A**

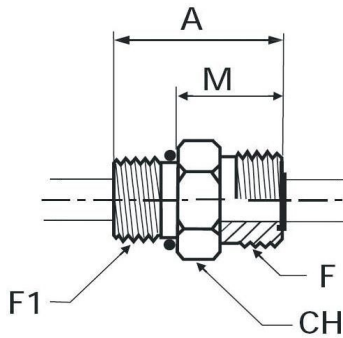

CODICE	F ORFS	F1 UNF	A mm	M	CH mm	
02NR04MS-04FRS	9/16-18	7/16-20	28,7	18,7	17	
02NR06MS-04FRS	9/16-18	9/16-18	30,5	18,5	19	
02NR08MS-04FRS	9/16-18	3/4-16	33,5	19,5	22	
02NR06MS-06FRS	11/16-16	9/16-18	32	21	19	
02NR08MS-06FRS	11/16-16	3/4-16	35	21	22	
02NR10MS-06FRS	11/16-16	7/8-14	38,8	28	27	
02NR04MS-06FRS	11/16-16	7/16-20	34	23	19	
02NR06MS-08FRS	13/16-16	9/16-18	37,5	26,5	22	
02NR08MS-08FRS	13/16-16	3/4-16	36,5	22,5	22	
02NR10MS-08FRS	13/16-16	7/8-14	40,4	24,4	27	
02NR12MS-08FRS	13/16-16	1-1/16-12	44,4	25,9	32	
02NR16MS-08FRS	13/16-16	1-5/16-12	45,5	27	38	
02NR08MS-10FRS	1-14	3/4-16	45	31	27	
02NR10MS-10FRS	1-14	7/8-14	43	27	27	
02NR12MS-10FRS	1-14	1-1/16-12	47	28,5	32	
02NR08MS-12FRS	1-3/16-12	3/4-16	48,5	34,5	32	
02NR10MS-12FRS	1-3/16-12	7/8-14	50,5	34,5	32	
02NR12MS-12FRS	1-3/16-12	1-1/16-12	48,5	30	32	
02NR16MS-12FRS	1-3/16-12	1/5-16-12	50	31,5	38	
02NR12MS-16FRS	1-7/16-12	1-1/16-12	56	37,5	38	
02NR20MS-16FRS	1-7/16-12	1-5/8-12	52,5	34	46	
02NR16MS-16FRS	1-7/16-12	1-5/16-12	50	32	38	
02NR16MS-20FRS	1-11/16-12	1-5/16-12	58	39,5	46	
02NR20MS-20FRS	1-11/16-12	1-5/8-12	52,5	34	46	
02NR24MS-20FRS	1-11/16-12	1-7/8-12	54	35,5	54	
02NR24MS-20FRS	1-11/16-12	1-7/8-12	54	35,5	55	
02NR20MS-24FRS	2-12	1-5/8-12	59,5	41	55	
02NR24MS-24FRS	2-12	1-7/8-12	54	35,5	55	
02NR24MS-24FRS	2-12	1-7/8-12	59,5	35,5	55	

**RACCORDO DIRITTO
ORFS / METRICO CIL.**

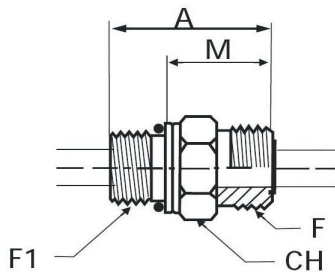

CODICE	F	F1 UNF	A	M	CH	
02NR12AMW-04FRS	9/16-18	M12X1,5	28,5	17,5	17	
02NR14AMW-04FRS	9/16-18	M14X1,5	29,5	18,5	19	
02NR12AMW-06FRS	11/16-16	M12X1,5	32	21	19	
02NR14AMW-06FRS	11/16-16	M14X1,5	32,5	20	22	
02NR16AMW-06FRS	11/16-16	M16X1,5	32,5	20	22	
02NR18AMW-08FRS	13/16-16	M18X1,5	36,5	22,5	24	
02NR22AMW-08FRS	13/16-16	M22X1,5	39,5	27	27	
02NR18AMW-10FRS	1-14	M18X1,5	41	27	27	
02NR22AMW-10FRS	1-14	M22X1,5	42	27	27	
02NR22AMW-12FRS	1-3/16-12	M22X1,5	45	27	32	
02NR27BMW-12FRS	1-3/16-12	M27X2	48,5	30	32	
02NR33BMW-12FRS	1-3/16-12	M33X2	51,5	33	32	
02NR33BMW-16FRS	1-7/16-12	M33X2	50,5	32	41	
02NR33BMW-20FRS	1-11/16-12	M33X2	53	34,5	46	
02NR42BMW-20FRS	1-11/16-12	M42X2	53	34	50	
02NR48BMW-24FRS	2-12	M48X2	57	35,5	55	

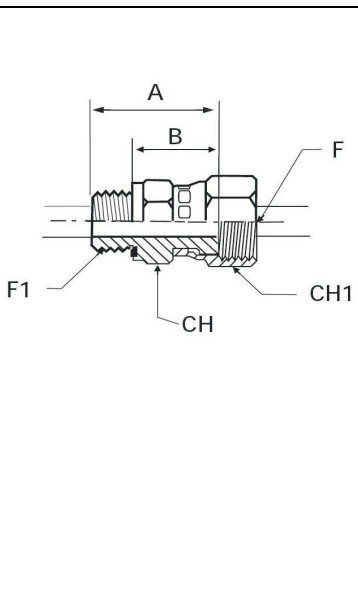
**RACCORDO DIRITTO
FEMMINA GIR. ORFS
MASCHIO GAS CIL.**

CODICE	F	F1	B	CH	CH1
02MG02-04FRS	9/16-18	1/8-28	26.2	14	19
02MG04-04FRS	9/16-18	1/4-19	26.2	19	19
02MG04-06FRS	11/16-16	1/4-19	20.8	19	22
02MG06-06FRS	11/16-16	3/8-19	28.2	22	22
02MG06-08FRS	13/16-16	3/8-19	35.8	22	24
02MG08-08FRS	13/16-16	1/2-14	35.5	27	24
02MG08-10FRS	1-14	1/2-14	38	27	30
02MG12-12FRS	1-3/16-12	3/4-14	41.4	32	36
02MG16-16FRS	1-7/16-12	1-11	49	41	46
02MG20-20FRS	1-11/16-12	1-1/4-11	49	50	50
02MG24-24FRS	2-12	1-1/2-11	49.8	55	60

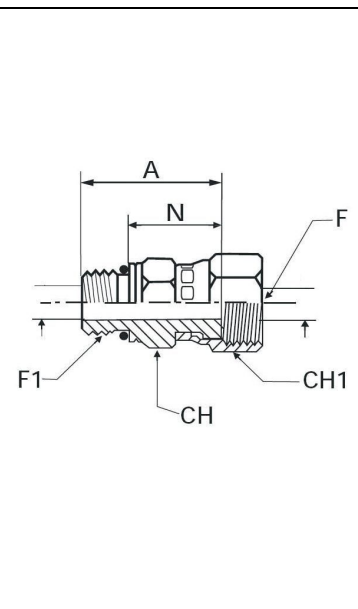
**RACCORDO DIRITTO
FEMMINA GIR. ORFS
MASCHIO METR. CIL.**

CODICE	F	F1	B	CH	CH1
02MG12AMW-04FRS	9/16-18	M12X1,5	26,2	17	19
02MG14AMW-06FRS	11/16-16	M14X1,5	28,2	19	22
02MG16AMW-06FRS	11/16-16	M16X1,5	28,2	22	22
02MG16AMW-08FRS	13/16-16	M16X1,5	35,3	22	24
02MG22AMW-10FRS	1-14	M22X1,5	37,8	27	30
02MG27BMW-12FRS	1-3/16-12	M27X2	41,2	32	36
02MG33BMW-16FRS	1-7/16-12	M33X2	49	41	46
02MG42BMW-20FRS	1-11/16-12	M42X2	49	50	50
02MG48BMW-24FRS	2-12	M48X2	49	55	60

**RACCORDO
INTERMEDIO A 90°
M/M ORFS**

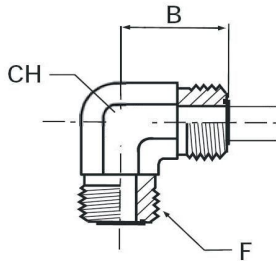

CODICE	F	B	D	CH		
03MM04FRS	9/16-18	21,5	5	14		
03MM06FRS	11/16-16	25	6,5	19		
03MM08FRS	13/16-16	28	9,5	19		
03MM10FRS	1-14	33,5	12,5	27		
03MM12FRS	1-3/16-12	37,5	15,5	30		
03MM16FRS	1-7/16-12	41,5	20,5	36		
03MM20FRS	1-11/16-12	44,5	26	41		
03MM24FRS	2-12	49	32	48		

**RACCORDO
INTERMEDIO MMM A
T ORFS**

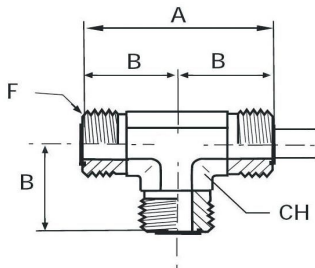

CODICE	F	B	D	CH		
04MM04FRS	9/16-18	21,5	5	14		
04MM06FRS	11/16-16	25	6,5	19		
04MM08FRS	13/16-16	28	9,5	19		
04MM10FRS	1-14	33,5	12,5	27		
04MM12FRS	1-3/16-12	37,5	15,5	30		
04MM16FRS	1-7/16-12	41,5	20,5	36		
04MM20FRS	1-11/16-12	44,5	26	41		
04MM24FRS	2-12	49	32	48		

**RACCORDO A T ORFS
CON DADO GIREVOLE
CENTRALE**

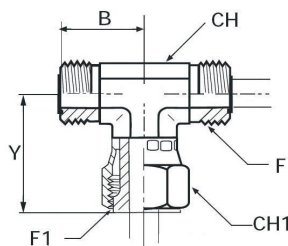

CODICE	F	F1	B	Y	CH1	
04CMFG04FRS	9/16-18	9/16-18	21,5	26,5	14	
04CMFG06FRS	11/16-16	11/16-16	25	29,5	19	
04CMFG08FRS	13/16-16	13/16-16	28	38	24	
04CMFG10FRS	1-14	1-14	33,5	41	27	
04CMFG12FRS	1-3/16-16	1-3/16-12	37,5	46,5	32	
04CMFG16FRS	1-7/16-12	1-7/16-12	41,5	53	38	
04CMFG20FRS	1-11/16-12	1-11/16-12	44,5	58	50	
04CMFG24FRS	2-12	2-12	49	61	55	

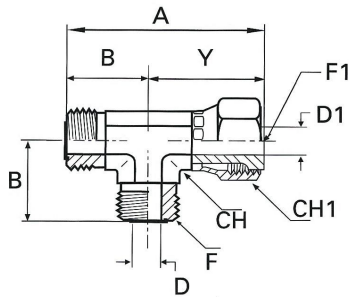
**RACCORDO ORFS A T
CON DADO GIREVOLE
LATERALE**

CODICE	F	F1	B	Y	CH1	
04LMFG04FRS	9/16-18	9/16-18	21,5	26,5	14	
04LMFG06FRS	11/16-16	11/16-16	25	29,5	19	
04LMFG08FRS	13/16-16	13/16-16	28	38	24	
04LMFG10FRS	1-14	1-14	33,5	41	27	
04LMFG12FRS	1-3/16-12	1-3/16-12	37,5	46,5	32	
04LMFG16FRS	1-7/16-12	1-7/16-12	41,5	53	38	
04LMFG20FRS	1-11/16-12	1-11/16-12	44,5	58	50	
04LMFG24FRS	2-12	2-12	49	61	55	

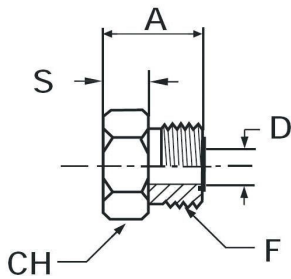
**TAPPO ORFS
MASCHIO**

CODICE	F	A	S	D	CH	
05TM04FRS	9/16-18	16,5	6,5	5	17	
05TM06FRS	11/16-16	19	8	6,5	19	
05TM08FRS	13/16-16	22	9	9,5	22	
05TM10FRS	1-14	26	10,5	12,5	27	
05TM12FRS	1-3/16-12	27,5	10,5	15,5	32	
05TM16FRS	1-7/16-12	28	10,5	20,5	41	
05TM20FRS	1-11/16-12	28	10,5	26	46	
05TM24FRS	2-12	28	10,5	32	55	

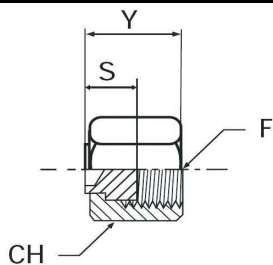
**TAPPO ORFS
FEMMINA**

CODICE	F	Y	S	CH		
05TF04FRS	9/16-18	16,5	8,5	17		
05TF06FRS	11/16-16	18	9,5	22		
05TF06FRS	11/16-16	18	8	22		
05TF08FRS	13/16-16	22	12	24		
05TF10FRS	1-14	24,5	12	30		
05TF12FRS	1-3/16-12	27	13,5	36		
05TF16FRS	1-7/16-12	28,5	15	41		
05TF20FRS	1-11/16-12	28,5	15	50		
05TF24FRS	2-12	28,5	15	60		

**RACCORDO MASCHIO
ORFS INTERMEDIO A
CROCE**

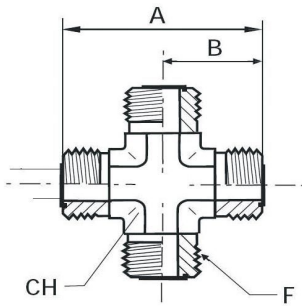

CODICE	F	A	B	CH		
19MM04FRS	9/16-18	43	21,5	5		
19MM06FRS	11/16-16	50	25	6,5		
19MM08FRS	13/16-16	56	28	9,5		
19MM10FRS	1-14	67	33,5	12,5		
19MM12FRS	1-3/16-12	75	37,5	15,5		
19MM16FRS	1-7/16-12	83	41,5	20,5		
19MM20FRS	1-11/16-12	89	44,5	26		
19MM24FRS	2-12	98	49	32		

**RACC. DI ESTREMITA'
A T ORIENT. ORFS /
CENTR. FIL. UNF-2A**

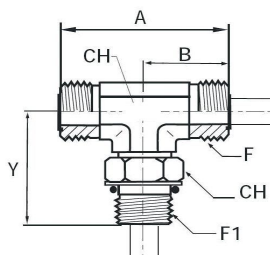

CODICE	F	F1	A	B	CH1	
33RCMRS04-MS04	9/16-18	7/16-20	21,5	30,2	14	
33RCMRS06-MS06	11/16-16	9/16-18	23,5	33,5	19	
33RCMRS08-MS08	13/16-16	3/4-16	25	35,5	19	
33RCMRS10-MS10	1"-14	7/8-14	26,5	38	27	
33RCMRS12-MS12	1-3/16-12	1-1/16-12	28	38	30	
33RCMRS16-MS16	1-7/16-12	1-5/16-12	33,5	51,4	36	
33RCMRS20-MS20	1-11/16-12	1-5/8-12	33,5	48,6	41	
33RCMRS24-MS24	2-12	1-7/8-12	33,5	40,7	48	

**RACC. DI ESTREMITA'
A T ORIENT. ORFS /
CENTR. FIL. GAS CIL.**

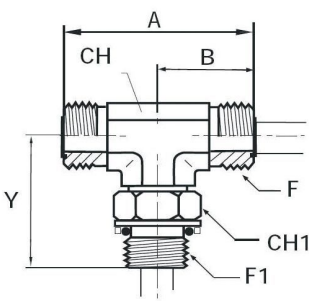

CODICE	F	F1	A	B	Y	
33RCM04FRS-MG02	9/16-18	1/8	43	21,5	30,2	
33RCM04FRS-MG04	9/16-18	1/4	47	23,5	36	
33RCM06FRS-MG04	11/16-16	1/4	50	25	36	
33RCM06FRS-MG06	11/16-16	3/8	53	26,5	38	
33RCM08FRS-MG06	13/16-16	3/8	56	28	38	
33RCM08FRS-MG08	13/16-16	1/2	56	28	38	
33RCM10FRS-MG08	1-14	1/2	67	33,5	48,6	
33RCM10FRS-MG12	1-14	3/4	71,6	35,8	51,5	
33RCM12FRS-MG12	1-3/16-12	3/4	75	37,5	51,5	
33RCM16FRS-MG16	1-7/16-12	1	83	41,5	58,4	
33RCM20FRS-MG20	1-11/16-12	1-14	85	44,5	61	
33RCM24FRS-MG20	2-12	1-14	98	49	65	

RACCORDI DI ESTREMITA' A T ORIENT. CON FILETT. LATER. UNF-2A

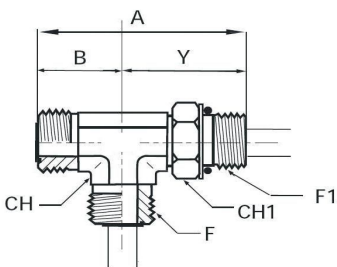

CODICE	F	F1	A	B	CH1
33RLMRS04-MS04	9/16-18	7/16-20	21,5	30,2	14
33RLMRS06-MS06	11/16-16	9/16-18	23,5	33,5	19
33RLMRS06-MS06	11/16-16	9/16-18	23,5	38	19
33RLMRS08-MS08	13/16-16	3/4-16	25	35,5	19
33RLMRS10-MS10	1"-14	7/8-14	28	35,5	27
33RLMRS12-MS12	1-3/16-12	1-1/16-12	28	38	30
33RLMRS16-MS16	1-7/16-12	1-5/16-12	33,5	51,4	36
33RLMRS20-MS20	1-11/16-12	1-5/8-12	33,5	48,6	41
33RLMRS24-MS24	2-12	1-7/8-12	33,5	40,7	48

RACCORDI DI ESTREMITA' A T ORIENT. CON FILETT. LATER. GAS CIL.

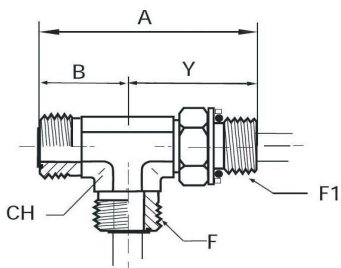

CODICE	F	F1	A	B	Y
33RLM04FRS-MG02	9/16-18	1/8	51,5	21,5	30
33RLM04FRS-MG04	9/16-18	1/4	59,5	23,5	36
33RLM06FRS-MG04	11/16-16	1/4	61	25	36
33RLM06FRS-MG06	11/16-16	3/8	64,5	26,5	38
33RLM08FRS-MG06	13/16-16	3/8	66	28	38
33RLM08FRS-MG08	13/16-16	1/2	79,3	30,8	48,5
33RLM10FRS-MG08	1-14	1/2	82	33,5	48,5
33RLM10FRS-MG12	1-14	3/4	87,5	36	51,5
33RLM12FRS-MG12	1-3/16-12	3/4	89	37,5	51,5
33RLM12FRS-MG16	1-3/16-12	1	100	41,5	58,5
33RLM16FRS-MG16	1-7/16-12	1	100	41,5	58,5
33RLM20FRS-MG20	1-11/16-12	1-14	105,5	44,5	61
33RLM24FRS-MG24	2-12	1-12	114	49	65

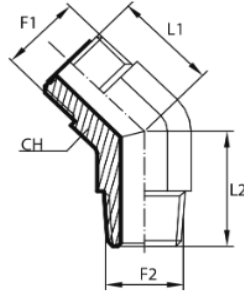
**RACCORDO A 45°
M ORFS / M GAS**

CODICE	F1 ORFS	F2 GAS	L1	L2	CH
34RMG04-04FRS	9/16-18	1/4-19	16	22	14
34RMG04-06FRS	11/16-16	1/4-19	19	24	19
34RMG06-06FRS	11/16-16	3/8-19	19	24	19
34RMG06-08FRS	13/16-16	3/8-19	20.5	24	22
34RMG08-08FRS	13/16-16	1/2-14	21	29.5	22

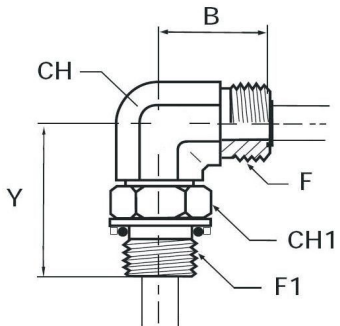
**RACCORDO DI
ESTREMITA' 90°
ORIENT. CON FIL.
TERMINALE GAS CIL.**

CODICE	F	F1	B	Y	CH
39RMG02-04FRS	9/16-18	1/8	21,5	30,2	14
39RMG04-04FRS	9/16-18	1/4	23,5	33,5	14
39RMG06-04FRS	9/16-18	3/8	23,5	38	19
39RMG04-06FRS	11/16-16	1/4	25	35,5	19
39RMG06-06FRS	11/16-16	3/8	26,5	38	19
39RMG08-06FRS	11/16-16	1/2	29,2	48,6	27
39RMG04-08FRS	13/16-16	1/4	28	35,5	19
39RMG06-08FRS	13/16-16	3/8	28	38	19
39RMG08-08FRS	13/16-16	1/2	30,8	48,6	27
39RMG12-08FRS	13/16-16	3/4	33,5	51,4	30
39RMG06-10FRS	1"-14	3/8	33,5	40,7	27
39RMG08-10FRS	1"-14	1/2	33,5	48,6	27
39RMG12-10FRS	1"-14	3/4	35,8	51,4	30
39RMG16-10FRS	1"-14	1	39,7	58,4	36
39RMG08-12FRS	1-3/16-12	1/2	37,5	49,5	30
39RMG12-12FRS	1-3/16-12	3/4	37,5	51,4	30
39RMG16-12FRS	1-3/16-12	1	41,2	58,4	36
39RMG12-16FRS	1-7/16-12	3/4	44,5	55,9	36
39RMG16-16FRS	1-7/16-12	1	41,5	58,4	36
39RMG20-16FRS	1-7/16-12	1-1/4	44,5	60,9	41
39RMG20-12FRS	1-3/16-12	1-1/4	44,5	60,9	41
39RMG24-12FRS	1-3/16-12	1-1/2	49	64,7	48
39RMG16-12FRS	1-3/16-12	1	44,5	60,9	41
39RMG24-24FRS	2"-12	1-1/2	49	64,7	48

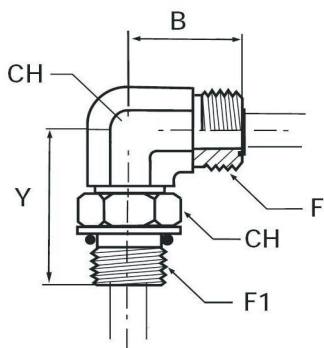
**RACCORDO ORFS DI
ESTREMITA' A 90°
ORIENT. CON FIL.
TERMINALE UNF-2A**

CODICE	F	F1	B	Y	CH	
39RMS04-04FRS	9/16-18	7/16-20	21,5	33	14	
39RMS06-04FRS	9/16-18	9/16-18	23,5	36,8	19	
39RMS04-06FRS	11/16-16	7/16-20	25	34,8	19	
39RMS06-06FRS	11/16-16	9/16-18	25	36,8	19	
39RMS08-06FRS	11/16-16	3/4-16	26,5	40,6	19	
39RMS10-06FRS	11/16-16	7/8-14	29,2	50	27	
39RMS06-08FRS	13/16-16	9/16-18	28	38,5	19	
39RMS08-08FRS	13/16-16	3/4-16	28	40,6	19	
39RMS10-08FRS	13/16-16	7/8-14	38,8	50	27	
39RMS12-08FRS	13/16-16	1-1/16-12	33,5	50	30	
39RMS08-10FRS	1-14	3/4-16	33,5	45,7	27	
39RMS10-10FRS	1-14	7/8-14	33,5	50	27	
39RMS12-10FRS	1-14	1-1/16-12	35,8	55,1	30	
39RMS08-12FRS	1-3/16-12	3/4-16	37,5	46,7	30	
39RMS10-12FRS	1-3/16-12	7/8-14	37,5	51	30	
39RMS12-12FRS	1-3/16-12	1-1/16-12	38,5	55,1	30	
39RMS16-12FRS	1-3/16-12	1-5/16-12	41,2	59,7	36	
39RMS08-12FRS	1-3/16-12	3/4-16	37,5	46,7	30	
39RMS12-16FRS	1-7/16-12	1-1/16-12	41,5	59	36	
39RMS16-16FRS	1-7/16-12	1-5/16-12	41,5	59,7	36	
39RMS20-16FRS	1-7/16-12	1-5/8-12	44,5	62,2	41	
39RMS12-16FRS	1-7/16-12	1-1/16-12	41,5	59	36	
39RMS16-20FRS	1-11/16-12	1-5/16-12	44,5	61,5	41	
39RMS20-20FRS	1-11/16-12	1-5/8-12	44,5	62,3	41	
39RMS24-20FRS	1-11/16-12	1-7/8-12	49	65,8	48	
39RMS20-24FRS	2-12	1-5/8-12	49	65	48	
39RMS24-12FRS	2-12	1-7/8-12	49	66	48	

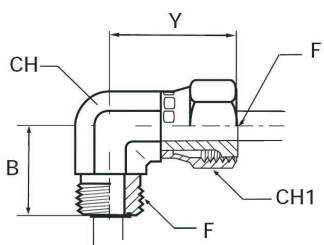
**RACCORDO
INTERMEDIO A 90°
ORFS CON DADO
GIREVOLE**

CODICE	F	F1	B	Y	CH1	
39MRS-FRS04	9/16-18	9/16-18	21,5	26,5	17	
39MRS-FRS06	11/16-16	11/16-16	25	29,5	22	
39MRS-FRS08	13/16-16	13/16-16	28	38	24	
39MRS-FRS10	1-14	1-14	33,5	41	30	
39MRS-FRS12	1-3/16-12	1-3/16-12	37,5	46,5	36	
39MRS-FRS16	1-7/16-12	1-7/16-12	41,5	53,5	41	
39MRS-FRS20	1-11/16-12	1-11/16-12	44,5	58	50	
39MRS-FRS24	2-12	2-12	49	61	60	

TAPPO FEMMINA JIC

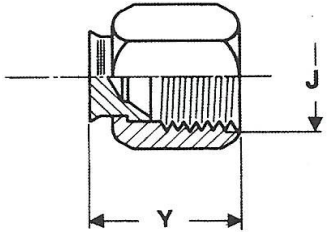

CODICE

J

Y

30TFI04
30TFI05
30TFI06
30TFI08
30TFI10
30TFI12
30TFI16
30TFI20
30TFI24

7/16-20
1/2-20
9/16-18
3/4-16
7/8-14
1"1/16-12
1"5/16-12
1"5/8-12
1"7/8-12

18
20
22
24
27
30
31.5
33
39

TAPPO MASCHIO JIC

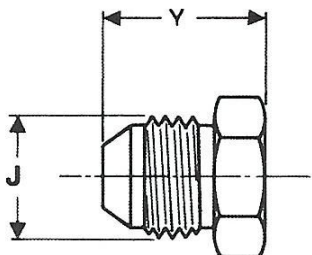

CODICE

J

Y

30TMI04
30TMI05
30TMI06
30TMI08
30TMI10
30TMI12
30TMI16
30TMI20
30TMI24

7/16-20
1/2-20
9/16-18
3/4-16
7/8-14
1"1/16-12
1"5/16-12
1"5/8-12
1"7/8-12

20.5
20.5
21.5
24.5
28
32.5
34
37
42

NIPPLO M/M JIC

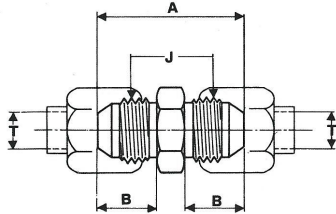

CODICE

J

A

B

32MI04	7/16-20	34,5	14
32MI05	1/2-20	34,5	14
32MI06	9/16-18	35,5	14
32MI08	3/4-16	41	17
32MI10	7/8-14	47,5	19,5
32MI12	1"1/16-12	55	22
32MI16	1"5/16-12	57	23
32MI20	1"5/8-12	61,5	24,5
32MI24	1"7/8-12	69,5	27,5

RACCORDO
INTERMEDIO DIRITTO
PASSAPARETE JIC

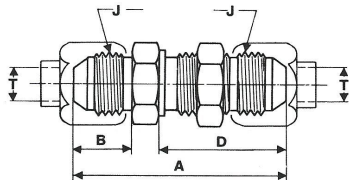

CODICE

J

A

B

D

32PMI04	7/16-20	52,5	14	30,5
32PMI05	1/2-20	52,5	14	30,5
32PMI06	9/16-18	55,5	14	32,5
32PMI08	3/4-16	62	17	36,5
32PMI10	7/8-14	69,5	19,5	40
32PMI12	1"1/16-12	78,5	22	44,5
32PMI16	1"5/16-12	80	23	44,5
32PMI20	1"5/8-12	84	24,5	45,7
32PMI24	1"7/8-12	89,5	27,5	46

RACCORDO M JIC /
F GIREVOLE JIC

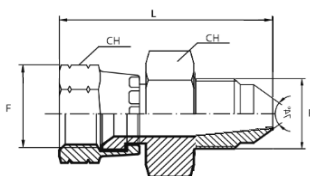

CODICE

F

L

CH

32FI-MI04	7/16-20	36	13
32FI-MI05	1/2-20	40	15
32FI-MI06	9/16-18	44	17
32FI-MI08	3/4-16	48	22
32FI-MI10	7/8-14	55	27
32FI-MI12	1"1/16-12	60	32
32FI-MI16	1"5/16-12	65	41

**RACCORDO DIRITTO
CON FILETTATURA
MASCHIO JIC / NPTF**

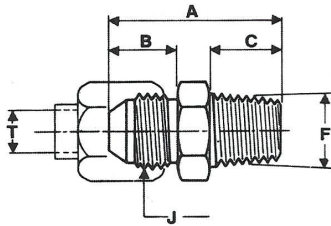

CODICE	J	F NPTF	A	B	C
32MI04NPT02	7/16-20	1/8"	31	14	10
32MI04NPT04	7/16-20	1/4"	35.5	14	14.5
32MI05NPT02	1/2-20	1/8"	31	14	10
32MI05NPT04	1/2-20	1/4"	35.5	14	14.5
32MI06NPT02	9/16-18	1/8"	31.5	14	10
32MI06NPT04	9/16-18	1/4"	36	14	14.5
32MI06NPT06	9/16-18	3/8"	36	14	14.5
32MI06NPT08	9/16-18	1/2"	42.5	14	19
32MI08NPT04	3/4-16	1/4"	39	17	14.5
32MI08NPT06	3/4-16	3/8"	39	17	14.5
32MI08NPT08	3/4-16	1/2"	45.5	17	19
32MI08NPT12	3/4-16	3/4"	47.5	17	19
32MI10NPT06	7/8-14	3/8"	43.5	19.5	14.5
32MI10NPT08	7/8-14	1/2"	48	19.5	19
32MI10NPT12	7/8-14	3/4"	50	19.5	19
32MI12NPT08	1"1/16-12	1/2"	52.5	22	19
32MI12NPT12	1"1/16-12	3/4"	52.5	22	19
32MI12NPT16	1"1/16-12	1"	57	22	24
32MI16NPT12	1"5/16-12	3/4"	53.5	23	19
32MI16NPT16	1"5/16-12	1"	58.5	23	24
32MI16NPT20	1"5/16-12	1"1/4	61.5	23	24.5
32MI20NPT16	1"5/8-12	1"	61.5	24.5	24
32MI20NPT20	1"5/8-12	1"1/4	62	24.5	24.5
32MI24NPT20	1"7/8-12	1"1/4	67	27.5	24.5
32MI24NPT24	1"7/8-12	1"1/2	68	27.5	25.5

RACCORDO DIRITTO
CON FILETTATURA
MASCHIO JIC / GAS
CONICO

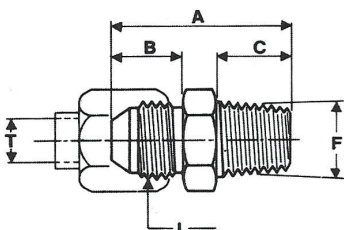

CODICE	J	F GAS CON.	A	B	C
32MI04MGC02	7/16-20	1/8"	31	14	8
32MI04MGC04	7/16-20	1/4"	35.5	14	12
32MI05MGC02	1/2-20	1/8"	31	14	8
32MI05MGC04	1/2-20	1/4"	35.5	14	12
32MI06MGC04	9/16-18	1/4"	36	14	12
32MI06MGC06	9/16-18	3/8"	36	14	12
32MI06MGC08	9/16-18	1/2"	42.5	14	14
32MI08MGC04	3/4-16	1/4"	38	17	12
32MI08MGC06	3/4-16	3/8"	38	17	12
32MI08MGC08	3/4-16	1/2"	43.5	17	14
32MI08MGC12	3/4-16	3/4"	47.5	17	19
32MI10MGC06	7/8-14	3/8"	43.5	19.5	12
32MI10MGC08	7/8-14	1/2"	48	19.5	14
32MI10MGC12	7/8-14	3/4"	50	19.5	16
32MI10MGC06	7/8-14	3/8"	41	19.5	12
32MI10MGC08	7/8-14	1/2"	43	19.5	14
32MI10MGC12	7/8-14	3/4"	47	19.5	16
32MI12MGC08	1"1/16-12	1/2"	52.5	22	14
32MI12MGC12	1"1/16-12	3/4"	52.5	22	16
32MI12MGC16	1"1/16-12	1"	51.5	22	18
32MI12MGC16	1"1/16-12	1"	57	22	18
32MI16MGC12	1"5/16-12	3/4"	53.5	23	16
32MI16MGC16	1"5/16-12	1"	58.5	23	18
32MI20MGC16	1"5/8-12	1"	61.5	24.5	18
32MI20MGC20	1"5/8-12	1"1/4	62	24.5	20
32MI24MGC20	1"7/8-12	1"1/4	68	27.5	24.5
32MI24MGC20	1"7/8-12	1"1/2	68	27.5	20

**RACCORDO DIRITTO
F. GIR. JIC / MASCHIO
FIL. UNF-2A**

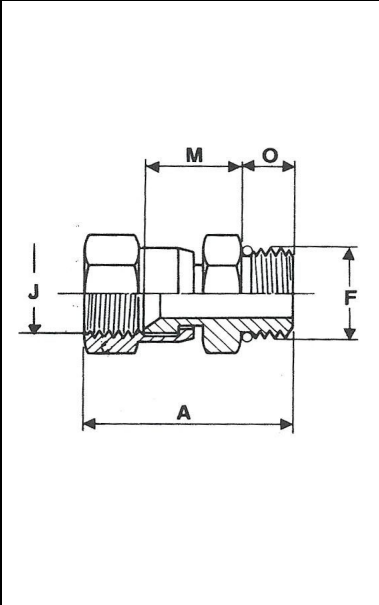

CODICE	J	F UNF-2A	A	M	O
32FI04MS04	7/16-20	7/16-20	34	14.5	9
32FI05MS05	1/2-20	1/2-20	35.5	16.5	9
32FI06MS06	9/16-18	9/16-18	38	18.5	10
32FI08MS08	3/4-16	3/4-16	42.5	20.5	11
32FI10MS10	7/8-14	7/8-14	48	22.5	12.5
32FI12MS12	1"1/16-12	1"1/16-12	53.5	24.5	15
32FI16MS16	1"5/16-12	1"5/16-12	57	27.5	15
32FI20MS20	1"5/8-12	1"5/8-12	63.5	32	15
32FI24MS24	1"7/8-12	1"7/8-12	70	38	15

**RACCORDO DIRITTO
F. GIR. JIC / MASCHIO
METRICO CIL.**

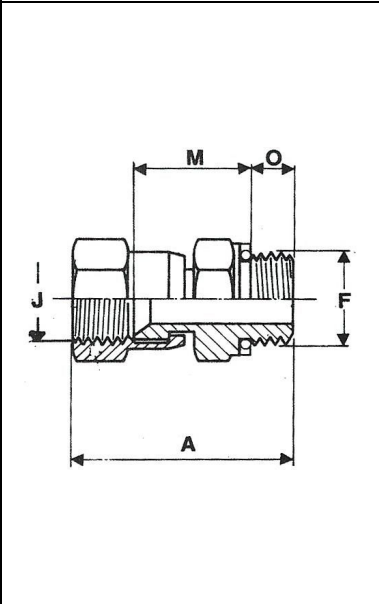

CODICE	J	F METR. CIL.	A	M	O
32FI04MW10C	7/16-20	M 10X1	33.5	18.5	8
32FI05MW12A	1/2-20	M 12X1,5	35.5	20.5	8
32FI06MW14A	9/16-18	M 14X1,5	36.5	20.5	8
32FI08MW16A	3/4-16	M 16X1,5	41.5	22.5	10
32FI10MW22A	7/8-14	M 22X1,5	48.5	24.5	12
32FI12MW27B	1"1/16-12	M 27X2	53.5	25.5	14
32FI16MW33B	1"5/16-12	M 32X2	57.5	30.5	15.5
32FI20MW42B	1"5/8-12	M 42X2	63.5	32.5	17
32FI24MW50B	1"7/8-12	M 50X2	71	35	19.5

**RACCORDO DIRITTO
F. GIR. JIC / MASCHIO
GAS CON.**

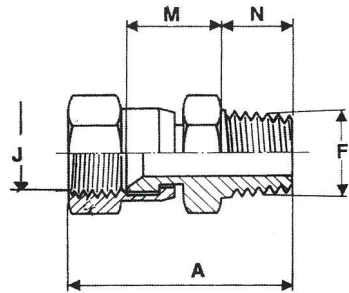

CODICE	J	F GAS CON.	A	M	N
32FI04MGC04	7/16-20	1/4"	38.5	15.5	14
32FI05MGC04	1/2-20	1/4"	39.5	15.5	14
32FI06MGC04	9/16-18	1/4"	40	16.5	14
32FI08MGC04	3/4-16	1/4"	43	17.8	14
32FI08MGC06	3/4-16	3/8"	43	17.8	14
32FI10MGC08	7/8-14	1/2"	51	19.5	19
32FI12MGC08	1"1/16-12	1/2"	54.5	21	19
32FI12MGC12	1"1/16-12	3/4"	54.5	21	19
32FI16MGC12	1"5/16-12	3/4"	59	24	19
32FI16MGC16	1"5/16-12	1"	64	24	24
32FI20MGC20	1"5/8-12	1"1/4"	69	28	24.5

**RACCORDO DIRITTO
F. GIR. JIC / MASCHIO
GAS CIL.**

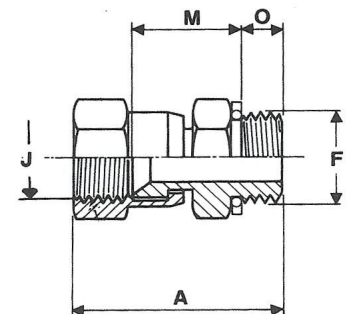

CODICE	J	F GAS CIL.	A	M	O
32FI04MGSP02	7/16-20	1/8"	32	16.5	6.5
32FI05MGSP04	1/2-20	1/4"	36.5	17	9.5
32FI06MGSP04	9/16-18	1/4"	37	18	9.5
32FI06MGSP06	9/16-18	3/8"	38	19	9.5
32FI08MGSP06	3/4-16	3/8"	41	20.5	9.5
32FI10MGSP06	7/8-14	3/8"	34	22	12
32FI08MGSP08	3/4-16	1/2"	36	22	14
32FI10MGSP08	7/8-14	1/2"	48	23	13
32FI14MGSP08	1"1/16-12	1/2"	38	24	14
32FI14MGSP12	1"1/16-12	3/4"	51.5	24	13
32FI16MGSP12	1"5/16-12	3/4"	44	28	16
32FI16MGSP16	1"5/16-12	1"	59.5	28	16
32FI20MGSP20	1"5/8-12	1"1/4"	64.5	32.5	16
32FI24MGSP24	1"7/8-12	1"1/2"	70	35	16

RACCORDO MASCHIO INTERMEDIO A T JIC

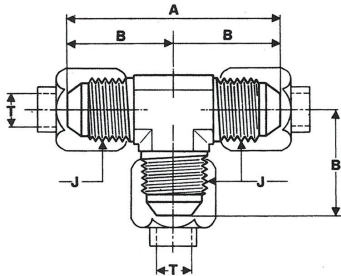

CODICE	J	A	B		
33MI04	7/16-20	45	22.5		
33MI05	1/2-20	48	24		
33MI06	9/16-18	54	27		
33MI08	3/4-16	63	31.5		
33MI10	7/8-14	73	36.5		
33MI12	1"1/16-12	84	42		
33MI16	1"5/16-12	92	46		
33MI20	1"5/8-12	104	52		
33MI24	1"7/8-12	118	59		

RACCORDO A T F. CENTRALE GIREVOLE JIC

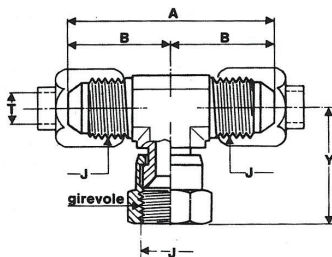

CODICE	J	A	B	Y	
33CMI-FI04	7/16-20	45	22.5	26	
33CMI-FI05	1/2-20	48	24	28	
33CMI-FI06	9/16-18	54	27	31	
33CMI-FI08	3/4-16	63	31.5	35.5	
33CMI-FI10	7/8-14	73	36.5	42	
33CMI-FI12	1"1/16-12	84	42	45.5	
33CMI-FI16	1"5/16-12	92	46	51.5	
33CMI-FI20	1"5/8-12	105	52.5	59	
33CMI-FI24	1"7/8-12	118	59	65.5	

RACCORDO A T F. LATERALE GIREVOLE JIC

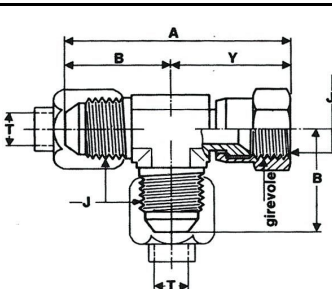

CODICE	J	A	B	Y	
33LMI-FI04	7/16-20	48,5	22,5	26	
33LMI-FI05	1/2-20	52	24	28	
33LMI-FI06	9/16-18	58	27	31	
33LMI-FI08	3/4-16	67	31,5	35,5	
33LMI-FI10	7/8-14	78,5	36,5	42	
33LMI-FI12	1"1/16-12	87,5	42	45,5	
33LMI-FI16	1"5/16-12	97,5	46	51,5	
33LMI-FI20	1"5/8-12	111,5	52,5	59	
33LMI-FI24	1"7/8-12	124,5	59	65,5	

RACCORDO A T JIC
ORIENT. / FIL.
CENTRALE GAS CIL

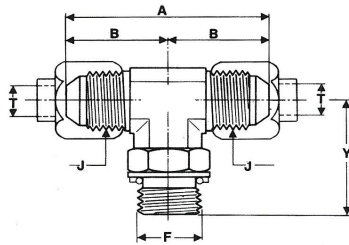

CODICE	J	F GAS CIL.	A	B	Y
33RCMI04MG02	7/16-20	1/8	45	22	26
33RCMI04MG04	7/16-20	1/4	54	27	31.5
33RCMI05MG04	1/2-20	1/4	54	27	31.5
33RCMI06MG04	9/16-18	1/4	54	27	31.5
33RCMI08MG06	3/4-16	3/8	63	31.5	36.5
33RCMI08MG08	3/4	1/2	68	34	43
33RCMI10MG08	7/8-14	1/2	73.5	36.5	43
33RCMI12MG12	1"1/16-12	3/4	84	42	49
33RCMI16MG16	1"5/16-12	1"	92	46	52
33RCMI20MG16	1"5/8-12	1"	104	52	57
33RCMI20MG20	1"5/8-12	1"1/4	104	52	57
33RCMI24MG24	1"7/8-12	1"1/2	118	59	61

RACCORDO A T JIC
ORIENT. / FIL.
LATERALE GAS CIL

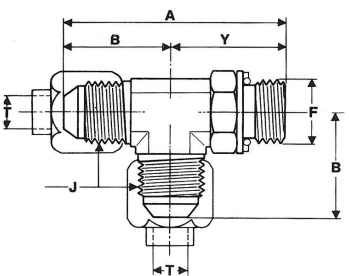

CODICE	J	F GAS CIL.	A	B	Y
33RLMI04MG02	7/16-20	1/8	48.5	22.5	26
33RLMI04MG04	7/16-20	1/4	58.5	27	31.5
33RLMI05MG04	1/2-20	1/4	58.5	27	31.5
33RLMI06MG04	9/16-18	1/4	58.5	27	31.5
33RLMI08MG06	3/4-16	3/8	68	31.5	36.5
33RLMI08MG08	3/4	1/2	77	34	43
33RLMI10MG08	7/8-14	1/2	79.5	36.5	43
33RLMI10MG08	7/8-14	1/2	79.5	36.5	43
33RLMI12MG12	1"1/16-12	3/4	91	42	49
33RLMI12MG08	1"1/16-12	1/2	91	42	49
33RLMI16MG16	1"5/16-12	1"	98	46	52
33RLMI20MG16	1"5/8-12	1"	109	52	57
33RLMI20MG20	1"5/8-12	1"1/4	102	59	43
33RLMI24MG24	1"7/8-12	1"1/2	120	59	61

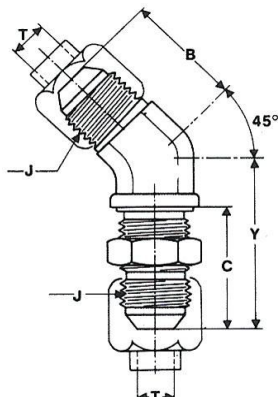
RACCORDO
PASSAPARETE A 45°
JIC

CODICE	J	B	Y	C	
34PMI-04	7/16-20	18	39	28.5	
34PMI-05	1/2-20	19.5	39	28.5	
34PMI-06	9/16-18	21	42.5	30	
34PMI-08	3/4-16	25	49	35	
34PMI-10	7/8-14	28	55	38.5	
34PMI-12	1"1/16-12	32.5	62	42.5	
34PMI-16	1"5/16-12	37	65	42.5	

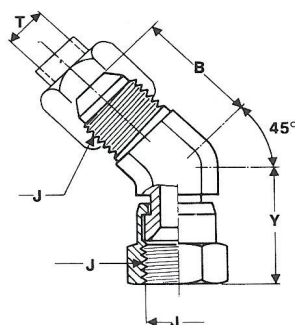
RACCORDO A 45° JIC
CON FEMMINA
GIREVOLE

CODICE	J	B	Y		
34MI-FI04	7/16-20	18	24.5		
34MI-FI05	1/2-20	19,5	26.5		
34MI-FI06	9/16-18	21	28.5		
34MI-FI08	3/4-16	25	32		
34MI-FI10	7/8-14	28	37		
34MI-FI12	1"1/16-12	32,5	45,5		
34MI-FI16	1"5/16-12	37	45		

**RACCORDO A 45°
ORIENT. M JIC /
M GAS CIL.**

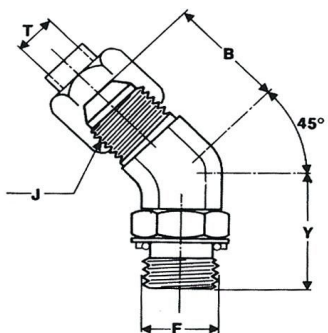

CODICE	J	F GAS CIL	B	Y	
34RMI04MGSP02	7/16-20	1/8	18	26.5	
34RMI05MGSP04	1/2-20	1/4	21	29	
34RMI06MGSP04	9/16-18	1/4	21	29	
34RMI08MGSP06	3/4-16	3/8	25	33	
34RMI08MGSP08	3/4-16	1/2	25.5	38.5	
34RMI10MGSP08	7/8-14	1/2	28	38.5	
34RMI12MGSP08	1"1/16-12	1/2	32.5	40.5	
34RMI12MGSP12	1"1/16-12	3/4	32.5	44	
34RMI16MGSP16	1"5/16-12	1"	37	47	

**RACCORDO A 45°
ORIENT. M JIC /
M GAS CON.**

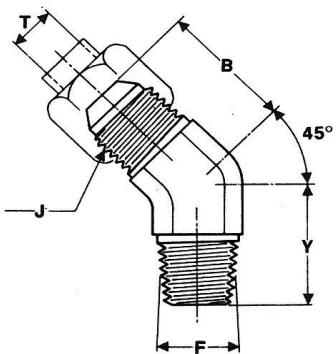

CODICE	J	F GAS CON	B	Y	
34MI04MGC02	7/16-20	1/8	18	16	
34MI04MGC04	7/16-20	1/4	21	21.5	
34MI05MGC02	1/2-20	1/8	19.5	16	
34MI05MGC04	1/2-20	1/4	21	21.5	
34MI06MGC04	9/16-18	1/4	21	21.5	
34MI06MGC06	9/16-18	3/8	22	24	
34MI06MGC08	9/16-18	1/2	22.5	29.5	
34MI08MGC04	3/4-16	1/4	25	24	
34MI08MGC06	3/4-16	3/8	25	24	
34MI08MGC08	3/4-16	1/2	25	29.5	
34MI10MGC06	7/8-14	3/8	28	24.5	
34MI10MGC08	7/8-14	1/2	28	29.5	
34MI12MGC08	1"1/16-12	1/2	32.5	30.5	
34MI12MGC12	1"1/16-12	3/4	32.5	30.5	
34MI16MGC12	1"5/16-12	3/4	37	32.5	
34MI16MGC16	1"5/16-12	1"	37	32.5	

**RACCORDO M/M JIC
INTERMEDIO A 90°**

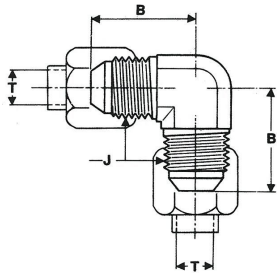

CODICE	J	B			
39MI04	7/16-20	22,5			
39MI05	1/2-20	24			
39MI06	9/16-18	27			
39MI08	3/4-16	31,5			
39MI10	7/8-14	36,5			
39MI12	1"1/16-12	42			
39MI16	1"5/16-12	46			
39MI20	1"5/8-12	52			
39MI24	1"7/8-12	59			

**RACCORDO
INTERMEDIO M/F JIC
90° CON DADO
GIREVOLE**

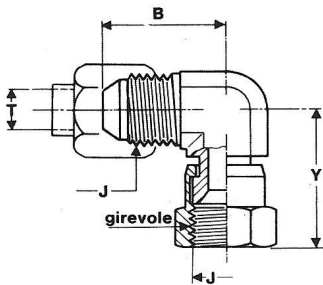

CODICE	J	B	Y		
39MIF04	7/16-20	22,5	26		
39MIF05	1/2-20	24	28,5		
39MIF06	9/16-18	27	30		
39MIF08	3/4-16	31,5	35,5		
39MIF10	7/8-14	36,5	42		
39MIF12	1"1/16-12	42	44,5		
39MIF16	1"5/16-12	46	50		
39MIF20	1"5/8-12	52,5	59		
39MIF24	1"7/8-12	59	65,5		

**RACCORDO
INTERMEDIO JIC 90°
PASSAPARETE**

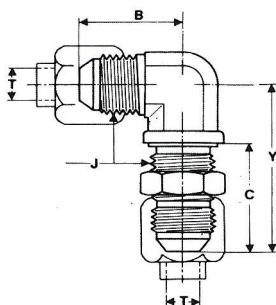

CODICE	J	B	Y	C	
39PMI04	7/16-20	24,5	40,5	28,5	
39PMI05	1/2-20	26	41	28,5	
39PMI06	9/16-18	27,5	46	30	
39PMI08	3/4-16	34,5	53,5	35	
39PMI10	7/8-14	39,5	60,5	38,5	
39PMI12	1"1/16-12	45	68	42,5	
39PMI16	1"5/16-12	49	71	42,5	

**RACC. DI ESTREMITA'
A 90° M JIC / M FIL.
TERM. GAS CONICO**

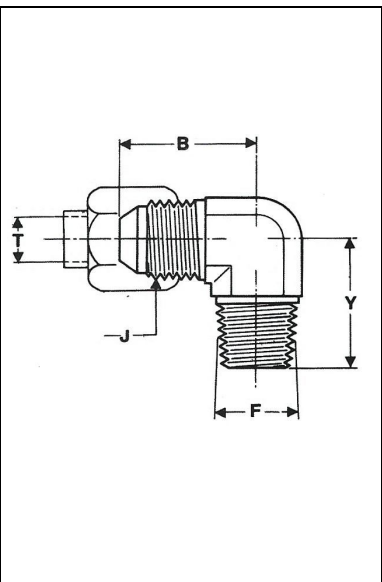

CODICE	J	F GAS CON	B	Y	
39MI04MGC02	7/16-20	1/8"	22.5	19.5	
39MI04MGC04	7/16-20	1/4"	27	27.5	
39MI05MGC02	1/2-20	1/8"	24	19.5	
39MI05MGC04	1/2-20	1/4"	27	27.5	
39MI06MGC04	9/16-18	1/4"	27	27.5	
39MI06MGC06	9/16-18	3/8"	28.5	31	
39MI06MGC08	9/16-18	1/2"	31	37	
39MI08MGC04	3/4-16	1/4"	31.5	31	
39MI08MGC06	3/4-16	3/8"	31.5	31	
39MI08MGC08	3/4-16	1/2"	34	37	
39MI08MGC12	3/4-16	3/4"	36.5	40.5	
39MI10MGC06	7/8-14	3/8"	36.5	32	
39MI10MGC08	7/8-14	1/2"	36.5	37	
39MI10MGC12	7/8-14	3/4"	39.5	40.5	
39MI12MGC08	1"1/16-12	1/2"	42	40.5	
39MI12MGC12	1"1/16-12	3/4"	42	40.5	
39MI16MGC12	1"5/16-12	3/4"	46	45	
39MI16MGC16	1"5/16-12	1"	46	50	
39MI20MGC16	1"5/8-12	1"	52	59	
39MI20MGC20	1"5/8-12	1"1/4"	52	60	
39MI24MGC24	1"7/8-12	1"1/2"	59	67	

**RACC. DI ESTREMITA'
A 90° M JIC / M FIL.
TERM. GAS CILIN.**

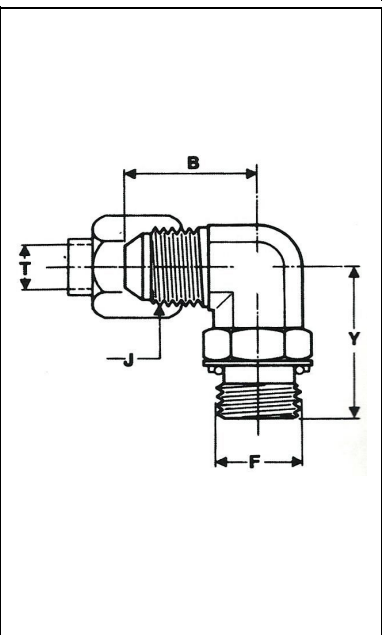

CODICE	J	F GAS CIL.	B	Y	
39RMI04MG02	7/16-20	1/8"	22.5	26	
39RMI04MG04	7/16-20	1/4"	27	31.5	
39RMI05MG02	1/2-20	1/8"	24	27.5	
39RMI05MG04	1/2-20	1/4"	27	31.5	
39RMI06MG04	9/16-18	1/4"	27	31.5	
39RMI06MG06	9/16-18	3/8"	28.5	36.5	
39RMI06MG08	9/16-18	1/2"	31	43	
39RMI08MG04	3/4-16	1/4"	31.5	33.5	
39RMI08MG06	3/4-16	3/8"	31.5	36.5	
39RMI08MG08	3/4-16	1/2"	34	43	
39RMI10MG08	7/8-14	1/2"	36.5	43	
39RMI10MG06	7/8-14	3/8"	36.5	39.5	
39RMI10MG12	7/8-14	3/4"	36.5	49	
39RMI12MG12	1"1/16-12	3/4"	42	49	
39RMI12MG08	1"1/16-12	1/2"	42	45.5	
39RMI12MG16	1"1/16-12	1"	44.5	52	
39RMI16MG12	1"5/16-12	3/4"	46	52	
39RMI16MG16	1"5/16-12	1"	46	52	
39RMI16MG20	1"5/16-12	1"1/4"	51	57	
39RMI20MG16	1"5/8-12	1"	52	57	
39RMI20MG20	1"5/8-12	1"1/4"	52	57	
39RMI24MG20	1"7/8-12	1"1/4"	59	57	
39RMI24MG24	1"7/8-12	1"1/2"	59	61	

**RACC. DI ESTREMITA'
A 90° M JIC / M FIL.
TERM. NPTF**

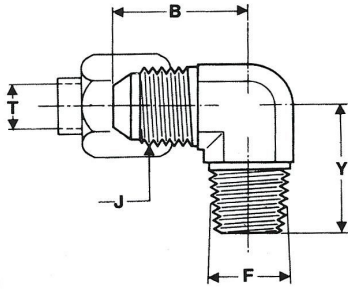

CODICE	J	F NPTF	B	Y	
39MI04NPT02	7/16-20	1/8"	22.5	19.5	
39MI04NPT04	7/16-20	1/4"	27	27.5	
39MI05NPT02	1/2-20	1/8"	24	19.5	
39MI05NPT04	1/2-20	1/4"	27	27.5	
39MI06NPT04	9/16-18	1/4"	27	27.5	
39MI06NPT06	9/16-18	3/8"	28.5	31	
39MI06NPT08	9/16-18	1/2"	31	37	
39MI08NPT04	3/4-16	1/4"	31.5	31	
39MI08NPT06	3/4-16	3/8"	31.5	31	
39MI08NPT08	3/4-16	1/2"	34	37	
39MI10NPT06	7/8-14	3/8"	36.5	32	
39MI10NPT08	7/8-14	1/2"	36.5	37	
39MI10NPT12	7/8-14	3/4"	39.5	40.5	
39MI12NPT08	1"1/16-12	1/2"	42	40.5	
39MI12NPT12	1"1/16-12	3/4"	42	40.5	
39MI16NPT12	1"5/16-12	3/4"	46	45	
39MI16NPT16	1"5/16-12	1"	46	50	
39MI20NPT16	1"5/8-12	1"	52	59	
39MI20NPT20	1"5/8-12	1"1/4"	52	60	
39MI24NPT24	1"7/8-12	1"1/2"	59	67	

**RACC. DI ESTREMITA'
A 90° M JIC / M FIL.
TERM. UNF-2A**

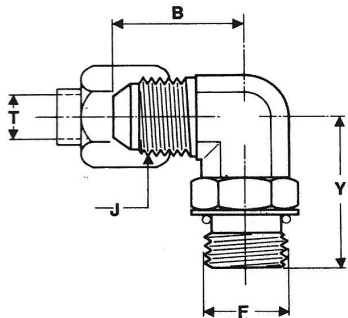

CODICE	J	F UNF-2A	B	Y	
39RMI04MS04	7/16-20	7/16-20	22.5	26	
39RMI04MS05	7/16-20	1/2-20	24	27.5	
39RMI04MS06	7/16-20	9/16-18	27	31.5	
39RMI05MS05	1/2-20	1/2-20	24	27.5	
39RMI06MS06	9/16-18	9/16-18	27	31.5	
39RMI06MS08	9/16-18	3/4-16	28.5	36	
39RMI08MS08	3/4-16	3/4-16	31.5	36.5	
39RMI08MS10	3/4-16	7/8-14	34	43	
39RMI10MS08	7/8-14	3/4-16	36.5	39.5	
39RMI10MS10	7/8-14	7/8-14	36.5	43	
39RMI12MS10	1"1/16-12	7/8-14	42	45.5	
39RMI12MS12	1"1/16-12	1"1/16-12	42	49	
39RMI16MS12	1"5/16-12	1"1/16-12	46	52	
39RMI16MS16	1"5/16-12	1"5/16-12	46	52	
39RMI20MS20	1"5/8-12	1"5/8-12	52	57	
39RMI24MS24	1"7/8-12	1"7/8-12	59	61	

DADO LIBERO FRS

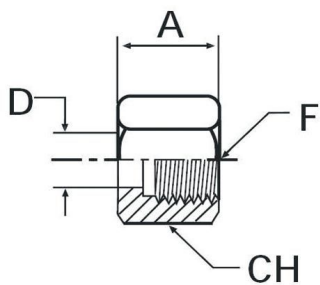

CODICE	F	A	D	CH	
DL04FRS	9/16-18	14.5	10.5	17	
DL06FRS	11/16-16	17	13.5	22	
DL08FRS	13/16-16	20	16.6	24	
DL10FRS	1-14	24	21.1	30	
DL12FRS	1-3/16-12	26.5	24.5	36	
DL16FRS	1-7/16-12	27.5	29.1	41	
DL20FRS	1-11/16-12	27.5	36	50	
DL24FRS	2-12	27.5	44	60	

DADO LIBERO UNF

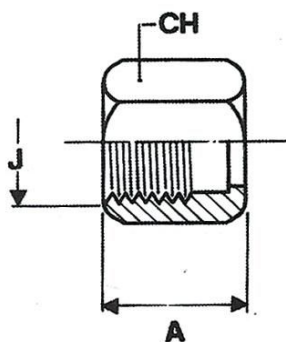

CODICE	J	A	CH		
DL04FI	7/16-20	15.5	14		
DL05FI	1/2-20	17	16		
DL06FI	9/16-18	18.5	19		
DL08FI	3/4-16	21.5	22		
DL10FI	7/8-14	24.5	27		
DL12FI	1"1/16-12	26	32		
DL16FI	1"5/16-12	28.5	38		
DL20FI	1"5/8-12	31	50		
DL24FI	1"7/8-12	36	57		



Sede: 60035 JESI (AN) - Via G. di Vittorio, 9 - Tel 0731 207231 - Fax 0731 64312

Filiale: 41100 MODENA - Via Respighi, 78 - Tel 059 270966 - Fax 059 3680302

e-mail: om@omoleodinamica.com - www.omoleodinamica.com - C.F. e P.IVA 00478760424