

o.m.
OLEODINAMICA

CATALOGO ADATTATORI



CATALOGO ADATTATORI

REV. 02

Sede: 60035 JESI (AN) Via G. di Vittorio, 9 – Tel 0731 207231

Filiale: 41100 MODENA – Via Respighi, 78 – Tel 059 270966

e-mail: om@omoleodinamica.com - www.omoleodinamica.com C.F. e P.IVA 00478760424

Indice:

DA PAG. 1 A 26 - FILETTO GAS

- 1,2 - NIPPLI
- 3,4,5 - COLONNETTE
- 6 - PASSAPARETI
- 7,8,9 - NIPPLI DI RIDUZIONE **GAS/GAS-NPTF-UNF-2A**
- 10,11 - RIDUZIONE F/M
- 12,13 - RACCORDI 90°
- 14 - ADATTATORI 90° M/F
- 15,16 - RACCORDI A T
- 17 - ADATTATORI A T e TAPPI
- 18 - VITI FORATE
- 19,20 - OCCHI FILETTATI
- 21 - OCCHI A SALDARE
- 22 - OGIVA CON DADO A SALDARE
- 23 - BORCHIE E MANICOTTI A SALDARE
- 24 - ADATTATORI M/F 45° e 90°
- 25 - ADATTATORI F/F 45° e 90°
- 26 - RACCORDI A CROCE

DA PAG. 27 A 35 - FILETTO METRICO

- 27 - NIPPLI
- 28,29 - RACCORDI DRITTI e COLLONETTE **METRICO/GAS**
- 30,31 - RIDUZIONI **METRICO/GAS**
- 32 - RACCORDO A T e TAPPI
- 33 - VITI FORATE e OCCHI FILETTATI
- 34 - BORCHIE A SALDARE
- 35 - ADATTATORI A 45° e 90°

DA PAG. 36 A 45 - FILETTO ORFS

- 36** - NIPPLI e PASSAPARETE
- 37** - MEZZO NIPPLO A SALDARE e RACCORDI DRITTI **ORFS/GAS**
- 38,39** - RACCORDI DRITTI **ORFS/UNF-MET-GAS**
- 40** - RACCORDI 90° e T
- 41** - RACCORDI A T e TAPPI
- 42** - RACCORDI e RIDUZIONI
- 43** - RACCORDI DI ESTREMITA' A T
- 44** - RACCORDI 45° e 90°
- 45** - RACCORDI 90°

DA PAG. 46 A 62 - FILETTO JIC

- 46** - TAPPI
 - 47** - RACCORDI **JIC/JIC**
 - 48** - RACCORDI M **JIC** / M **NPTF**
 - 49** - RACCORDI M **JIC** / M **UNF-2A**
 - 50** - RACCORDI M **JIC** / M **GAS CON.**
 - 51** - RACCORDI M **JIC** / M **GAS CIL.**
 - 52** - RACCORDI M **JIC** / M **METR. CIL**
 - 53,54** - RACCORDI DIRITTI F/M
 - 55,56** - RACCORDI A T
 - 57,58** - RACCORDI 45°
 - 59,60,61,62** - RACCORDI 90°
-
- 63** - BUSSOLE
 - 64** - DADI LIBERI
-
- 65** - SERIE TOYOTA e KOMATSU

**NIPPLO M/M GAS
CICLINDRICO**

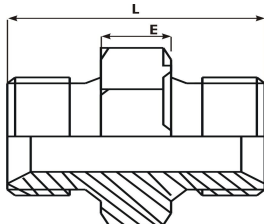

| CODICE | Filetto | L | E | CH | | |
|--|----------|------|-----|--------------------|--------|--|
| 01NP02 | 1/8-28 | 25 | 6 | 14 | | |
| 01NP04 | 1/4-19 | 29 | 7 | 19 | | |
| 01NP06 | 3/8-19 | 34 | 8 | 22 | | |
| 01NP08 | 1/2-14 | 37,5 | 9,5 | 27 | | |
| 01NP10 | 5/8-14 | 42 | 10 | 30 | | |
| 01NP12 | 3/4-14 | 42 | 10 | 32 | | |
| 01NP16 | 1-11 | 50 | 12 | 41 | | |
| 01NP20 | 1.1/4-11 | 57 | 17 | 50 | | |
| 01NP24 | 1.1/2-11 | 60 | 16 | 55 | | |
| 01NP32 | 2-11 | 70 | 17 | 70 | | |
| 01NP40 | 2.1/2-11 | 85 | 21 | 85 | | |
| 01NP48 | 3-11 | 95 | 25 | 100 | | |
| Serie con foro calibrato su un lato | | | | Misura foro | | |
| 01NP04-0 | 1/4-19 | 29 | 7 | 19 | 0 | |
| 01NP04-006 | 1/4-19 | 29 | 7 | 19 | 0,6 mm | |
| 01NP04-008 | 1/4-19 | 29 | 7 | 19 | 0,8 mm | |
| 01NP04-01 | 1/4-19 | 29 | 7 | 19 | 1 mm | |

**NIPPLO M GAS
CONICO / M GAS
CILINDRICO**

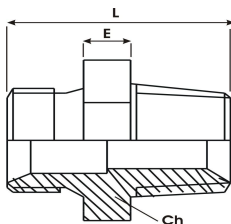

| CODICE | Filetto | L | E | CH | | |
|--------|----------|------|------|-------|--|--|
| 01CC02 | 1/8-28 | 23 | 6 | 14 | | |
| 01CC04 | 1/4-19 | 32 | 7 | 17/16 | | |
| 01CC06 | 3/8-19 | 35 | 8 | 19 | | |
| 01CC08 | 1/2-14 | 42,5 | 9,5 | 24 | | |
| 01CC12 | 3/4-14 | 45 | 10 | 32 | | |
| 01CC16 | 1-11 | 55 | 12 | 36 | | |
| 01CC24 | 1.1/2-11 | 60,5 | 13,5 | 50 | | |
| 01CC32 | 2-11 | 64 | 12 | 65 | | |
| 01CC40 | 2.1/2-11 | 68 | 13 | 75 | | |

**NIPPLO M/M GAS
CONICO**

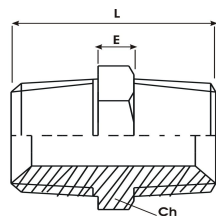

| CODICE | Filetto | L | E | CH | | |
|--------|----------|------|----|----|--|--|
| 01CN02 | 1/8-28 | 26 | 6 | 14 | | |
| 01CN04 | 1/4-19 | 35 | 7 | 17 | | |
| 01CN06 | 3/8-19 | 36,5 | 8 | 19 | | |
| 01CN08 | 1/2-14 | 48 | 9 | 22 | | |
| 01CN12 | 3/4-14 | 48 | 10 | 27 | | |
| 01CN16 | 1-11 | 59 | 10 | 36 | | |
| 01CN20 | 1.1/4-11 | 63,5 | 14 | 46 | | |
| 01CN24 | 1.1/2-11 | 67 | 14 | 50 | | |
| 01CN32 | 2-11 | 68 | 12 | 60 | | |
| 01CN40 | 2.1/2-11 | 78 | 21 | 80 | | |

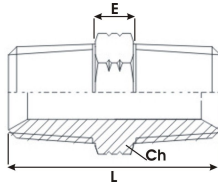
NIPPLO NPTF

| CODICE | Filetto | L | E | CH | | |
|--------|---------|----|----|----|--|--|
| 01NN02 | 1/8-28 | 29 | 6 | 13 | | |
| 01NN04 | 1/4-19 | 32 | 7 | 17 | | |
| 01NN06 | 3/8-19 | 38 | 8 | 19 | | |
| 01NN08 | 1/2-14 | 40 | 8 | 27 | | |
| 01NN16 | 1-11 | 60 | 18 | 36 | | |
| 01NN32 | 2-11 | 75 | 22 | 65 | | |
| | | | | | | |
| | | | | | | |
| | | | | | | |
| | | | | | | |
| | | | | | | |
| | | | | | | |
| | | | | | | |
| | | | | | | |
| | | | | | | |

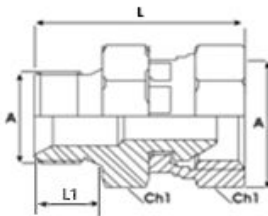
**NIPPLO GAS M/F
GIREVOLE**

| CODICE | Filetto A | L | L1 | CH | | |
|--------|-----------|----|----|----|--|--|
| 01MG02 | 1/8-28 | 29 | 6 | 14 | | |
| 01MG04 | 1/4-19 | 34 | 6 | 19 | | |
| 01MG06 | 3/8-19 | 40 | 8 | 22 | | |
| 01MG08 | 1/2-14 | 41 | 8 | 27 | | |
| 01MG10 | 5/8-14 | 49 | 10 | 27 | | |
| 01MG12 | 3/4-14 | 54 | 11 | 32 | | |
| 01MG16 | 1-11 | 60 | 13 | 41 | | |
| 01MG20 | 1.1/4-11 | 66 | 13 | 50 | | |
| 01MG24 | 1.1/2-11 | 70 | 14 | 55 | | |
| 01MG32 | 2-11 | 84 | 20 | 70 | | |
| | | | | | | |
| | | | | | | |
| | | | | | | |
| | | | | | | |
| | | | | | | |
| | | | | | | |
| | | | | | | |
| | | | | | | |

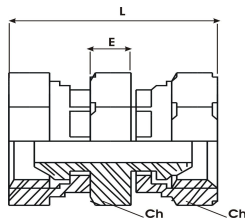
**GIUNZIONE GAS F/F
GIREVOLE**

| CODICE | Filetto | L | E | CH | | |
|--------|----------|------|-----|----|--|--|
| 01FG02 | 1/8-28 | 34 | 7 | 15 | | |
| 01FG04 | 1/4-19 | 37 | 7 | 19 | | |
| 01FG06 | 3/8-19 | 44 | 8 | 22 | | |
| 01FG08 | 1/2-14 | 50 | 9,5 | 27 | | |
| 01FG10 | 5/8-14 | 55 | 10 | 28 | | |
| 01FG12 | 3/4-14 | 59 | 10 | 32 | | |
| 01FG16 | 1-11 | 66,5 | 12 | 41 | | |
| 01FG20 | 1.1/4-11 | 76 | 9 | 50 | | |
| 01FG24 | 1.1/2-11 | 83 | 14 | 55 | | |
| 01FG32 | 2-11 | 91,5 | 17 | 70 | | |
| | | | | | | |
| | | | | | | |
| | | | | | | |
| | | | | | | |
| | | | | | | |
| | | | | | | |
| | | | | | | |
| | | | | | | |

**MEZZO NIPPLO A
SALDARE GAS**

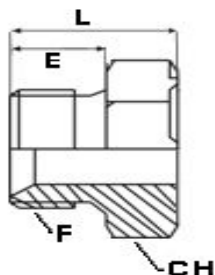

| CODICE | Filetto | L | E | CH | |
|--------|----------|------|----|-----|--|
| 01NS02 | 1/8-28 | 16.5 | 5 | 14 | |
| 01NS04 | 1/4-19 | 18 | 7 | 19 | |
| 01NS06 | 3/8-19 | 21 | 8 | 22 | |
| 01NS08 | 1/2-14 | 25 | 10 | 27 | |
| 01NS10 | 5/8-14 | 26 | 10 | 30 | |
| 01NS12 | 3/4-14 | 27 | 10 | 32 | |
| 01NS16 | 1-11 | 30 | 12 | 41 | |
| 01NS20 | 1.1/4-11 | 34 | 13 | 50 | |
| 01NS24 | 1.1/2-11 | 36 | 14 | 55 | |
| 01NS32 | 2-11 | 40 | 16 | 65 | |
| 01NS40 | 2.1/2-11 | 50 | 20 | 70 | |
| 01NS48 | 3-11 | 60 | 25 | 100 | |
| 01NS56 | 3.1/2-11 | 60 | 25 | 110 | |

**COLONNETTA GAS
M/F**

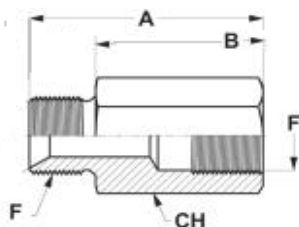

| CODICE | Filetto | A | B | CH | |
|------------|---------|-----|-----|----|--|
| 01MF02-10 | 1/8 | 18 | 10 | 14 | |
| 01MF02-17 | 1/8 | 25 | 17 | 14 | |
| 01MF02-20 | 1/8 | 28 | 20 | 14 | |
| 01MF02-21 | 1/8 | 29 | 21 | 14 | |
| 01MF02-30 | 1/8 | 38 | 30 | 14 | |
| 01MF02-40 | 1/8 | 48 | 40 | 14 | |
| 01MF04-16 | 1/4 | 28 | 16 | 19 | |
| 01MF04-20 | 1/4 | 32 | 20 | 19 | |
| 01MF04-25 | 1/4 | 37 | 25 | 19 | |
| 01MF04-30 | 1/4 | 42 | 30 | 19 | |
| 01MF04-35 | 1/4 | 47 | 35 | 19 | |
| 01MF04-40 | 1/4 | 52 | 40 | 19 | |
| 01MF04-45 | 1/4 | 57 | 45 | 19 | |
| 01MF04-50 | 1/4 | 62 | 50 | 19 | |
| 01MF04-60 | 1/4 | 72 | 60 | 19 | |
| 01MF04-75 | 1/4 | 87 | 75 | 19 | |
| 01MF04-100 | 1/4 | 112 | 100 | 19 | |
| 01MF06-20 | 3/8 | 32 | 20 | 22 | |
| 01MF06-22 | 3/8 | 34 | 22 | 22 | |
| 01MF06-25 | 3/8 | 37 | 25 | 22 | |
| 01MF06-30 | 3/8 | 42 | 30 | 22 | |
| 01MF06-35 | 3/8 | 47 | 35 | 22 | |
| 01MF06-40 | 3/8 | 52 | 40 | 22 | |
| 01MF06-45 | 3/8 | 57 | 45 | 22 | |
| 01MF06-50 | 3/8 | 62 | 50 | 22 | |
| 01MF06-60 | 3/8 | 72 | 60 | 22 | |
| 01MF08-20 | 1/2 | 36 | 20 | 27 | |
| 01MF08-23 | 1/2 | 39 | 23 | 27 | |
| 01MF08-25 | 1/2 | 41 | 25 | 27 | |
| 01MF08-30 | 1/2 | 46 | 30 | 27 | |
| 01MF08-35 | 1/2 | 51 | 35 | 27 | |

COLONNETTA GAS
F/F

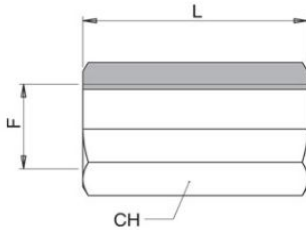

| CODICE | Filetto | L | CH | | |
|-----------|----------|----|----|--|--|
| 01FF02-22 | 1/8-28 | 22 | 14 | | |
| 01FF02-25 | 1/8-28 | 25 | 14 | | |
| 01FF02-30 | 1/8-28 | 30 | 14 | | |
| 01FF04-25 | 1/4-19 | 25 | 19 | | |
| 01FF04-30 | 1/4-19 | 30 | 19 | | |
| 01FF04-35 | 1/4-19 | 35 | 19 | | |
| 01FF04-50 | 1/4-19 | 50 | 19 | | |
| 01FF06-30 | 3/8-19 | 30 | 22 | | |
| 01FF06-35 | 3/8-19 | 35 | 22 | | |
| 01FF06-45 | 3/8-19 | 45 | 22 | | |
| 01FF06-52 | 3/8-19 | 52 | 22 | | |
| 01FF08-45 | 1/2-14 | 45 | 27 | | |
| 01FF12-45 | 3/4-14 | 45 | 32 | | |
| 01FF16-38 | 1-11 | 38 | 38 | | |
| 01FF16-45 | 1-11 | 45 | 38 | | |
| 01FF16-50 | 1-11 | 50 | 38 | | |
| 01FF16-60 | 1-11 | 60 | 38 | | |
| 01FF16-80 | 1-11 | 80 | 38 | | |
| 01FF20-50 | 1.1/4-11 | 50 | 55 | | |
| 01FF20-60 | 1.1/4-11 | 60 | 55 | | |
| 01FF20-90 | 1.1/4-11 | 90 | 55 | | |
| 01FF24-70 | 1.1/2-11 | 70 | 55 | | |

COLONNETTA GAS
M/M

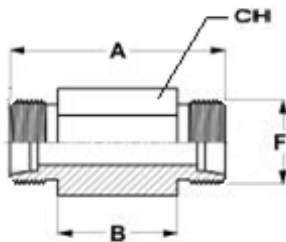

| CODICE | Filetto | A | B | CH | |
|------------|----------|-----|-----|----|--|
| 01MM04-20 | 1/4-19 | 43 | 20 | 19 | |
| 01MM04-25 | 1/4-19 | 48 | 25 | 19 | |
| 01MM04-90 | 1/4-19 | 113 | 90 | 19 | |
| 01MM04-115 | 1/4-19 | 138 | 115 | 19 | |
| 01MM06-25 | 3/8-19 | 51 | 25 | 22 | |
| 01MM06-34 | 3/8-19 | 60 | 34 | 22 | |
| 01MM06-35 | 3/8-19 | 61 | 35 | 22 | |
| 01MM06-40 | 3/8-19 | 66 | 40 | 22 | |
| 01MM06-45 | 3/8-19 | 71 | 45 | 22 | |
| 01MM06-50 | 3/8-19 | 76 | 50 | 22 | |
| 01MM06-55 | 3/8-19 | 81 | 55 | 22 | |
| 01MM08-25 | 1/2-14 | 53 | 25 | 27 | |
| 01MM08-35 | 1/2-14 | 63 | 35 | 27 | |
| 01MM08-40 | 1/2-14 | 68 | 40 | 27 | |
| 01MM08-50 | 1/2-14 | 78 | 50 | 27 | |
| 01MM08-60 | 1/2-14 | 88 | 60 | 27 | |
| 01MM12-40 | 3/4-14 | 74 | 40 | 32 | |
| 01MM12-45 | 3/4-14 | 79 | 45 | 32 | |
| 01MM16-30 | 1-11 | 70 | 30 | 38 | |
| 01MM16-45 | 1-11 | 85 | 45 | 38 | |
| 01MM16-60 | 1-11 | 100 | 60 | 38 | |
| 01MM20-90 | 1.1/4-11 | 134 | 90 | 50 | |
| 01MM32-50 | 2-11 | 100 | 50 | 70 | |

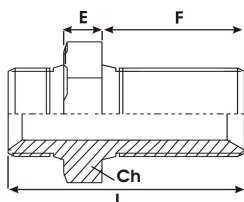
**PASSAPARETE
 DIRITTA GAS**

| CODICE | Filetto | L | F | E | CH | |
|---------|----------|-----|----|----|----|--|
| 01PSP04 | 1/4-19 | 45 | 28 | 6 | 19 | |
| 01PSP06 | 3/8-19 | 53 | 33 | 7 | 22 | |
| 01PSP08 | 1/2-14 | 59 | 37 | 8 | 27 | |
| 01PSP10 | 5/8-14 | 71 | 45 | 10 | 30 | |
| 01PSP12 | 3/4-14 | 80 | 53 | 10 | 32 | |
| 01PSP16 | 1-11 | 81 | 51 | 11 | 41 | |
| 01PSP20 | 1.1/4-11 | 96 | 61 | 13 | 50 | |
| 01PSP24 | 1.1/2-11 | 110 | 71 | 15 | 60 | |
| | | | | | | |
| | | | | | | |
| | | | | | | |
| | | | | | | |

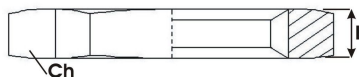
**GHIERA GAS PER
 PASSAPARETE**

| CODICE | Filetto | E | CH | | | |
|--------|----------|----|----|--|--|--|
| CD04FG | 1/4-19 | 6 | 19 | | | |
| CD06FG | 3/8-19 | 7 | 22 | | | |
| CD08FG | 1/2-14 | 7 | 27 | | | |
| CD10FG | 5/8-14 | 10 | 30 | | | |
| CD12FG | 3/4-14 | 10 | 32 | | | |
| CD16FG | 1-11 | 12 | 41 | | | |
| CD20FG | 1.1/4-11 | 13 | 50 | | | |
| CD24FG | 1.1/2-11 | 13 | 55 | | | |
| CD32FG | 2-11 | 8 | 70 | | | |
| | | | | | | |
| | | | | | | |
| | | | | | | |
| | | | | | | |

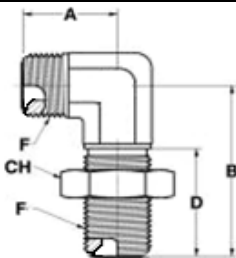
**PASSAPARETE GAS
 M/M 90°**

| CODICE | Filetto | A | B | D | CH | |
|-----------|----------|----|----|----|----|--|
| 01PSP9002 | 1/8-28 | 20 | 40 | 20 | 15 | |
| 01PSP9004 | 1/4-19 | 24 | 45 | 28 | 19 | |
| 01PSP9006 | 3/8-19 | 28 | 52 | 32 | 24 | |
| 01PSP9008 | 1/2-14 | 36 | 56 | 34 | 27 | |
| 01PSP9012 | 3/4-14 | 42 | 65 | 39 | 36 | |
| 01PSP9016 | 1-11 | 45 | 70 | 41 | 41 | |
| 01PSP9020 | 1.1/4-11 | 60 | 90 | 55 | 50 | |
| 01PSP9024 | 1.1/2-11 | 65 | 95 | 60 | 60 | |
| | | | | | | |
| | | | | | | |
| | | | | | | |
| | | | | | | |

**NIPPLO DI
RIDUZIONE M/M GAS
CILINDRICA**

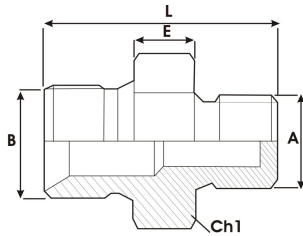

| CODICE | Filetto A | Filetto B | L | E | CH | |
|-----------|-----------|-----------|------|------|-----|--|
| 02NR04-02 | 1/4-19 | 1/8-28 | 27,5 | 7 | 19 | |
| 02NR06-02 | 3/8-19 | 1/8-28 | 28 | 6,5 | 19 | |
| 02NR06-04 | 3/8-19 | 1/4-19 | 32 | 8 | 22 | |
| 02NR08-02 | 1/2-14 | 1/8-28 | 31 | 7 | 27 | |
| 02NR08-04 | 1/2-14 | 1/4-19 | 35 | 10 | 27 | |
| 02NR08-06 | 1/2-14 | 3/8-19 | 37 | 10 | 27 | |
| 02NR10-04 | 5/8-14 | 1/4-19 | 37 | 10 | 27 | |
| 02NR10-06 | 5/8-14 | 3/8-19 | 39 | 10 | 30 | |
| 02NR10-08 | 5/8-14 | 1/2-14 | 40 | 10 | 30 | |
| 02NR12-04 | 3/4-14 | 1/4-19 | 38 | 10 | 32 | |
| 02NR12-06 | 3/4-14 | 3/8-19 | 40 | 10 | 32 | |
| 02NR12-08 | 3/4-14 | 1/2-14 | 40 | 10 | 32 | |
| 02NR12-10 | 3/4-14 | 5/8-14 | 43 | 10 | 32 | |
| 02NR16-04 | 1-11 | 1/4-19 | 42 | 12 | 41 | |
| 02NR16-06 | 1-11 | 3/8-19 | 44 | 12 | 41 | |
| 02NR16-08 | 1-11 | 1/2-14 | 45 | 12 | 41 | |
| 02NR16-10 | 1-11 | 5/8-14 | 45 | 10 | 38 | |
| 02NR16-12 | 1-11 | 3/4-14 | 47 | 12 | 41 | |
| 02NR20-08 | 1.1/4-11 | 1/2-14 | 48 | 12,5 | 50 | |
| 02NR20-12 | 1.1/4-11 | 3/4-14 | 53 | 17 | 50 | |
| 02NR20-16 | 1.1/4-11 | 1-11 | 56 | 17 | 50 | |
| 02NR24-08 | 1.1/2-11 | 1/2-14 | 50 | 14 | 55 | |
| 02NR24-12 | 1.1/2-11 | 3/4-14 | 52 | 13 | 55 | |
| 02NR24-20 | 1.1/2-11 | 1.1/4-11 | 56 | 14 | 55 | |
| 02NR32-10 | 2-11 | 5/8-14 | 60 | 17 | 70 | |
| 02NR32-16 | 2-11 | 1-11 | 62 | 17 | 70 | |
| 02NR32-20 | 2-11 | 1.1/4-11 | 65 | 17 | 70 | |
| 02NR32-24 | 2-11 | 1.1/2-11 | 65 | 17 | 70 | |
| 02NR40-24 | 2.1/2-11 | 1.1-2-11 | 74 | 21 | 85 | |
| 02NR40-32 | 2.1/2-11 | 2-11 | 79 | 21 | 85 | |
| 02NR48-40 | 3-11 | 2.1/2-11 | 92 | 25 | 100 | |

**NIPPLO DI
RIDUZIONE M/M GAS
CONICO**

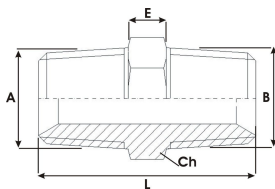

| CODICE | Filetto A | Filetto B | L | E | CH | |
|-----------|-----------|-----------|----|-----|----|--|
| 02CN04-02 | 1/4-19 | 1/8-28 | 30 | 8 | 14 | |
| 02CN06-04 | 3/8-19 | 1/4-19 | 38 | 8 | 22 | |
| 02CN08-04 | 1/2-14 | 1/4-19 | 40 | 9 | 24 | |
| 02CN08-06 | 1/2-14 | 3/8-19 | 42 | 9,5 | 24 | |
| 02CN12-08 | 3/4-14 | 1/2-14 | 47 | 9 | 32 | |
| 02CN16-12 | 1-11 | 3/4-14 | 56 | 13 | 36 | |
| 02CN20-16 | 1.1/4-11 | 1-11 | 61 | 14 | 50 | |
| 02CN24-20 | 1.1/2-11 | 1.1/4-11 | 64 | 14 | 50 | |

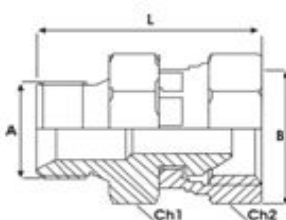
**RIDUZIONE M/F
GIREVOLE GAS**

| CODICE | Filetto A | Filetto B | L | CH1 | CH2 |
|------------|-----------|-----------|------|-----|-----|
| 02MG04-06 | 1/4-19 | 3/8-19 | 35 | 19 | 22 |
| 02MG04-08 | 1/4-19 | 1/2-14 | 40 | 19 | 27 |
| 02MG06-08 | 3/8-19 | 1/2-14 | 42 | 22 | 27 |
| 02MG06-12 | 3/8-19 | 3/4-14 | 46,5 | 27 | 32 |
| 02MG08-12 | 1/2-14 | 3/4-14 | 52 | 27 | 32 |
| 02MG12-16 | 3/4-14 | 1-11 | 54 | 32 | 38 |
| 02MG06-04 | 3/8-19 | 1/4-19 | 36 | 22 | 19 |
| 02MG08-04 | 1/2-14 | 1/4-19 | 40 | 27 | 19 |
| 02MG08-06 | 1/2-14 | 3/8-19 | 42 | 27 | 22 |
| 02MG12-08 | 3/4-14 | 1/2-14 | 49 | 32 | 27 |
| 02MG16-08 | 1-11 | 1/2-14 | 51 | 40 | 27 |
| 02MG16-12 | 1-11 | 3/4-14 | 55 | 41 | 32 |
| 02MG20-16 | 1.1/4-11 | 1-11 | 60 | 38 | 50 |
| 02MG04-12A | 1/4-19 | 12X1,5 | 32 | 17 | 17 |
| 02MG04-14A | 1/4-19 | 14X1,5 | 32 | 17 | 17 |
| 02MG04-16A | 1/4-19 | 16X1,5 | 35 | 19 | 22 |
| 02MG06-16A | 3/8-19 | 16X1,5 | 40 | 22 | 22 |
| 02MG06-18A | 3/8-19 | 18X1,5 | 39 | 22 | 22 |
| 02MG08-18A | 1/2-14 | 18X1,5 | 43 | 27 | 22 |
| 02MG08-22A | 1/2-14 | 22X1,5 | 41 | 27 | 27 |
| 02MG12-18A | 3/4-14 | 18X1,5 | 53 | 31 | 24 |
| 02MG12-22A | 3/4-14 | 22X1,5 | 48 | 32 | 27 |

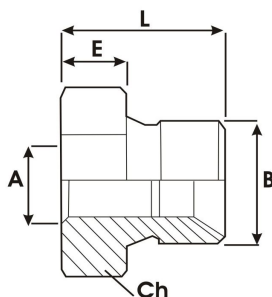
**RIDUZIONE F/M GAS
SERIE CORTA**

| CODICE | Filetto A | Filetto B | L | E | CH |
|--------------|-----------|-----------|----|------|----|
| 02FMB02-06 | 1/8-28 | 3/8-19 | 21 | 8 | 22 |
| 02FMB04-06 | 1/4-19 | 3/8-19 | 21 | 8 | 22 |
| 02FMB04-08 | 1/4-19 | 1/2-14 | 24 | 10 | 27 |
| 02FMB04-12 | 1/4-19 | 3/4-14 | 26 | 10 | 32 |
| 02FMB04-16 | 1/4-19 | 1-11 | 31 | 12 | 41 |
| 02FMB06-08 | 3/8-19 | 1/2-14 | 24 | 10 | 27 |
| 02FMB06-12 | 3/8-19 | 3/4-14 | 26 | 10 | 32 |
| 02FMB06-16 | 3/8-19 | 1-11 | 30 | 12 | 41 |
| 02FMB08-12 | 1/2-14 | 3/4-14 | 26 | 10 | 32 |
| 02FMB08-16 | 1/2-14 | 1-11 | 31 | 12 | 41 |
| 02FMB08-20 | 1/2-14 | 1.1/4-11 | 36 | 14 | 50 |
| 02FMB12-20 | 3/4-14 | 1.1/4-11 | 34 | 14 | 50 |
| 02FMB12-24 | 3/4-14 | 1.1/2-11 | 36 | 14 | 55 |
| 02FMB16-20 | 1-11 | 1.1/4-11 | 34 | 13 | 50 |
| 02FMB16-24 | 1-11 | 1.1/2-11 | 36 | 14 | 55 |
| 02FMB16-32 | 1-11 | 2-11 | 43 | 17 | 70 |
| 02FMB20-32 | 1.1/4-11 | 2-11 | 43 | 17.5 | 70 |
| 02FMB24-32 | 1.1/4-11 | 2-11 | 43 | 12 | 70 |
| 02FMB04-18A | 1/4-19 | 18X1,5 | 20 | 7 | 22 |
| 02FMB04-22A | 1/4-19 | 22X1,5 | 22 | 8 | 27 |
| 02FMB16A-14A | 16X1,5 | 14X1,5 | 33 | 22 | 21 |
| 02FMB06-10C | 3/8-19 | 10X1 | 20 | 7 | 21 |
| 02FMB12-18A | 3/4-14 | 18X1,5 | 27 | 10 | 32 |
| 02FMB14A-18A | 14X1,5 | 18X1,5 | 21 | 7 | 22 |
| 02FMB16A-20A | 1-11 | 20X1,5 | 23 | 9 | 27 |

**ADATTATORE A 90°
FILETT. GAS CIL. /
GAS CON.**

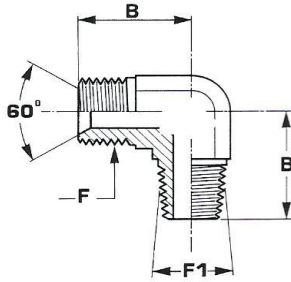

| CODICE | F GAS CIL | F1 GAS CON | B | | | |
|--------|--------------|---------------|----|--|--|--|
| 03MM02 | 1/8" | 1/8" | 20 | | | |
| 03MM04 | 1/4" | 1/4" | 27 | | | |
| 03MM06 | 3/8" | 3/8" | 30 | | | |
| 03MM08 | 1/2" | 1/2" | 37 | | | |
| 03MM10 | 5/8" | 1/2" | 37 | | | |
| 03MM12 | 3/4" | 3/4" | 40 | | | |
| 03MM16 | 1" | 1" | 50 | | | |
| 03MM20 | 1"1/4 | 1"1/4 | 52 | | | |
| 03MM24 | 1"1/2 | 1"1/2 | 59 | | | |
| | | | | | | |
| | | | | | | |
| | | | | | | |
| | | | | | | |
| | | | | | | |
| | | | | | | |
| | | | | | | |
| | | | | | | |
| | | | | | | |
| | | | | | | |

**ADATTATORE A 90°
FILETTATURA GAS
CONICA**

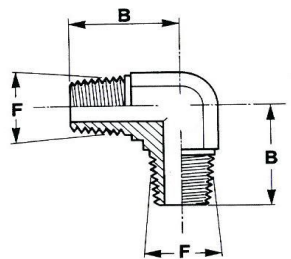

| CODICE | F GAS CONICA | B | | | | |
|--------|-----------------|----|--|--|--|--|
| 03MK02 | 1/8" | 20 | | | | |
| 03MK04 | 1/4" | 27 | | | | |
| 03MK06 | 3/8" | 31 | | | | |
| 03MK08 | 1/2" | 37 | | | | |
| 03MK12 | 3/4" | 40 | | | | |
| 03MK16 | 1" | 50 | | | | |
| 03MK20 | 1"1/4 | 52 | | | | |
| 03MK24 | 1"1/2 | 59 | | | | |
| | | | | | | |
| | | | | | | |
| | | | | | | |
| | | | | | | |
| | | | | | | |
| | | | | | | |
| | | | | | | |
| | | | | | | |
| | | | | | | |
| | | | | | | |
| | | | | | | |

**ADATTATORE A 90°
FILETTATURA GAS
CILINDRICA**

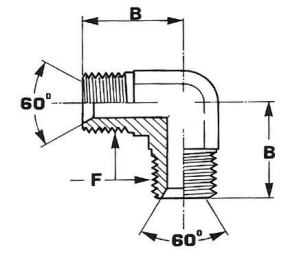

| CODICE | F GAS CIL | B | | | | |
|--------|--------------|----|--|--|--|--|
| 03MG02 | 1/8" | 20 | | | | |
| 03MG04 | 1/4" | 28 | | | | |
| 03MG06 | 3/8" | 30 | | | | |
| 03MG08 | 1/2" | 37 | | | | |
| 03MG10 | 5/8" | 40 | | | | |
| 03MG12 | 3/4" | 40 | | | | |
| 03MG16 | 1" | 50 | | | | |
| 03MG20 | 1"1/4 | 52 | | | | |
| 03MG24 | 1"1/2 | 59 | | | | |
| | | | | | | |
| | | | | | | |
| | | | | | | |
| | | | | | | |
| | | | | | | |
| | | | | | | |
| | | | | | | |
| | | | | | | |
| | | | | | | |
| | | | | | | |

**ADATTATORE A 90°
ORIENTABILE FILET.
GAS CILINDRICA**

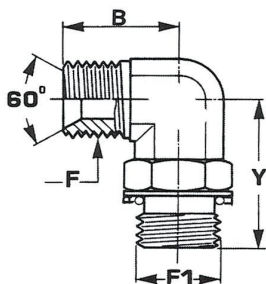

| CODICE | F GAS CIL | F1 GAS CIL | B | Y | | |
|------------|--------------|---------------|------|------|--|--|
| 03RMG04 | 1/4" | 1/4" | 27 | 31.5 | | |
| 03RMG06-04 | 3/8" | 1/4" | 31.5 | 33.5 | | |
| 03RMG06 | 3/8" | 3/8" | 31.5 | 37 | | |
| 03RMG06-08 | 3/8" | 1/2" | 31.5 | 43 | | |
| 03RMG08-06 | 1/2" | 3/8" | 37.5 | 39.5 | | |
| 03RMG08 | 1/2" | 1/2" | 36.5 | 43 | | |
| 03RMG12-08 | 3/4" | 1/2" | 40 | 45.5 | | |
| 03RMG12 | 3/4" | 3/4" | 40 | 49 | | |
| 03RMG16-12 | 1" | 3/4" | 50 | 49 | | |
| 03RMG16 | 1" | 1" | 50 | 52 | | |
| 03RMG20-16 | 1"1/4 | 1" | 52 | 52 | | |
| 03RMG20 | 1"1/4 | 1"1/4 | 52 | 57 | | |
| 03RMG24 | 1"1/2 | 1"1/2 | 59 | 61 | | |

**RACCORDO A 90°
FEMMINA FILETT.
GAS CILINDRICA**

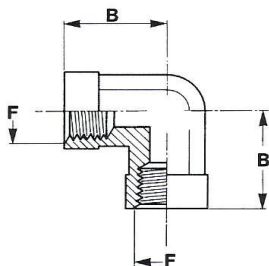

| CODICE | F GAS CIL | B | | | | |
|--------|--------------|----|--|--|--|--|
| 03FF02 | 1/8" | 17 | | | | |
| 03FF04 | 1/4" | 22 | | | | |
| 03FF06 | 3/8" | 26 | | | | |
| 03FF08 | 1/2" | 31 | | | | |
| 03FF12 | 3/4" | 35 | | | | |
| 03FF16 | 1" | 44 | | | | |
| 03FF20 | 1"1/4 | 52 | | | | |
| | | | | | | |
| | | | | | | |
| | | | | | | |
| | | | | | | |
| | | | | | | |
| | | | | | | |
| | | | | | | |
| | | | | | | |
| | | | | | | |

**RACCORDO A 90°
FIL. F.GAS CIL. /
M.GAS CON.**

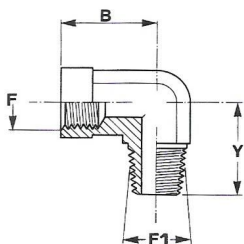

| CODICE | F GAS CIL | F1 GAS CON | B | Y | | |
|---------|--------------|---------------|----|----|--|--|
| 03MFF02 | 1/8" | 1/8" | 17 | 20 | | |
| 03MFF04 | 1/4" | 1/4" | 22 | 28 | | |
| 03MFF06 | 3/8" | 3/8" | 26 | 31 | | |
| 03MFF08 | 1/2" | 1/2" | 31 | 37 | | |
| 03MFF12 | 3/4" | 3/4" | 35 | 40 | | |
| 03MFF16 | 1" | 1" | 44 | 56 | | |
| | | | | | | |
| | | | | | | |
| | | | | | | |
| | | | | | | |
| | | | | | | |
| | | | | | | |
| | | | | | | |
| | | | | | | |
| | | | | | | |
| | | | | | | |

**ADATTATORE A T
CON DADO GIR.
CENTR. FILET. GAS
CIL.**

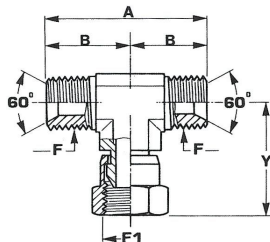

| CODICE | F GAS CIL | F1 GAS CIL | A | B | Y | |
|----------|--------------|---------------|-----|------|----|--|
| 04CMFG04 | 1/4 | 1/4 | 54 | 27 | 29 | |
| 04CMFG06 | 3/8 | 3/8 | 63 | 31,5 | 34 | |
| 04CMFG08 | 1/2 | 1/2 | 74 | 37 | 40 | |
| 04CMFG10 | 5/8 | 5/8 | 74 | 37 | 42 | |
| 04CMFG12 | 3/4 | 3/4 | 80 | 40 | 46 | |
| 04CMFG16 | 1" | 1" | 100 | 50 | 52 | |
| 04CMFG20 | 1"1/4 | 1"1/4 | 104 | 52 | 57 | |
| 04CMFG24 | 1"1/2 | 1"1/2 | 120 | 60 | 61 | |
| | | | | | | |
| | | | | | | |

**ADATTATORE A T
ORIENT. CON FILET.
CENTR. GAS CIL.**

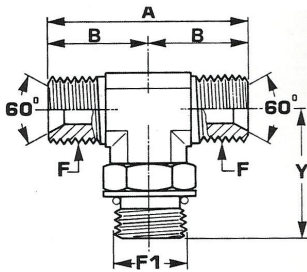

| CODICE | F GAS CIL | F1 GAS CIL | A | B | Y | |
|-------------|--------------|---------------|-----|------|------|--|
| 04RCMG04 | 1/4 | 1/4 | 54 | 27 | 31,5 | |
| 04RCMG06-04 | 3/8 | 1/4 | 63 | 31,5 | 33,5 | |
| 04RCMG06 | 3/8 | 3/8 | 63 | 31,5 | 36,5 | |
| 04RCMG08-06 | 1/2 | 3/8 | 74 | 37 | 39,5 | |
| 04RCMG08 | 1/2 | 1/2 | 74 | 37 | 43 | |
| 04RCMG12-08 | 3/4 | 1/2 | 80 | 40 | 45,5 | |
| 04RCMG12 | 3/4 | 3/4 | 80 | 40 | 49 | |
| 04RCMG16-12 | 1" | 3/4 | 100 | 50 | 52 | |
| 04RCMG16 | 1" | 1" | 100 | 50 | 52 | |
| 04RCMG20-16 | 1"1/4 | 1" | 104 | 52 | 57 | |
| 04RCMG20 | 1"1/4 | 1"1/4 | 104 | 52 | 57 | |
| 04RCMG24 | 1"1/2 | 1"1/2 | 118 | 59 | 61 | |

**ADATTATORE A T
ORIENT. CON FILET.
LATERALE GAS CIL.**

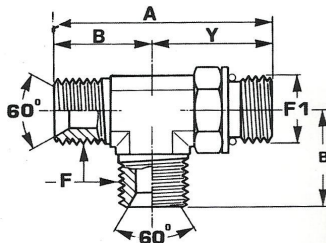

| CODICE | F GAS CIL | F1 GAS CIL | A | B | Y | |
|-------------|--------------|---------------|------|------|------|--|
| 04RLMG04 | 1/4 | 1/4 | 58,5 | 27 | 31,5 | |
| 04RLMG06-04 | 3/8 | 1/4 | 65 | 31,5 | 33,5 | |
| 04RLMG06 | 3/8 | 3/8 | 68,5 | 31,5 | 36,5 | |
| 04RLMG08-06 | 1/2 | 3/8 | 76 | 37 | 39 | |
| 04RLMG08 | 1/2 | 1/2 | 80 | 37 | 43 | |
| 04RLMG12-08 | 3/4 | 1/2 | 85,5 | 40 | 45,5 | |
| 04RLMG12 | 3/4 | 3/4 | 89 | 40 | 49 | |
| 04RLMG16-12 | 1" | 3/4 | 102 | 50 | 52 | |
| 04RLMG16 | 1" | 1" | 102 | 50 | 52 | |
| 04RLMG20-16 | 1"1/4 | 1" | 109 | 52 | 57 | |
| 04RLMG20 | 1"1/4 | 1"1/4 | 109 | 52 | 57 | |
| 04RLMG24 | 1"1/2 | 1"1/2 | 120 | 59 | 61 | |

**ADATTATORE A T
INTERMEDIO FIL.
GAS CILINDRICA**

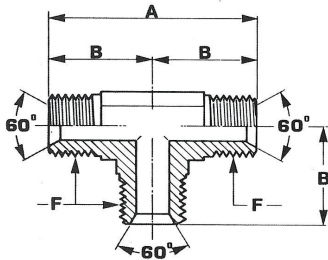

| CODICE | F GAS CIL | A | B | | | |
|--------|--------------|-----|----|--|--|--|
| 04MM02 | 1/8" | 40 | 20 | | | |
| 04MM04 | 1/4" | 54 | 27 | | | |
| 04MM06 | 3/8" | 60 | 30 | | | |
| 04MM08 | 1/2" | 74 | 37 | | | |
| 04MM10 | 5/8" | 80 | 40 | | | |
| 04MM12 | 3/4" | 80 | 40 | | | |
| 04MM16 | 1" | 100 | 50 | | | |
| 04MM20 | 1"1/4 | 104 | 52 | | | |
| 04MM24 | 1"1/2 | 118 | 59 | | | |
| | | | | | | |
| | | | | | | |
| | | | | | | |

**TAPPO FEMMINA
GAS SEDE OGIVA**

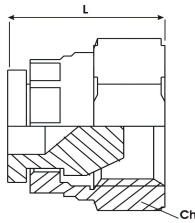

| CODICE | Filetto | L | CH | | | |
|--------|----------|----|------|--|--|--|
| 05TF02 | 1/8-28 | 14 | 15 | | | |
| 05TF04 | 1/4-19 | 19 | 17 | | | |
| 05TF06 | 3/8-19 | 22 | 20 | | | |
| 05TF08 | 1/2-14 | 27 | 23 | | | |
| 05TF10 | 5/8-14 | 30 | 25,5 | | | |
| 05TF12 | 3/4-14 | 32 | 28 | | | |
| 05TF16 | 1-11 | 38 | 29 | | | |
| 05TF20 | 1.1/4-11 | 50 | 35 | | | |
| 05TF24 | 1.1/2-11 | 55 | 39 | | | |
| 05TF32 | 2-11 | 70 | 44 | | | |
| | | | | | | |
| | | | | | | |
| | | | | | | |

**TAPPO MASCHIO
GAS CIL. TESTA
ESAGONALE**

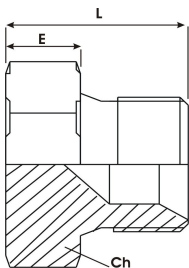

| CODICE | Filetto | L | E | CH | | |
|--------|----------|------|----|----|--|--|
| 05TM02 | 1/8-28 | 15,5 | 6 | 14 | | |
| 05TM04 | 1/4-19 | 18 | 7 | 19 | | |
| 05TM06 | 3/8-19 | 20 | 8 | 22 | | |
| 05TM08 | 1/2-14 | 23 | 9 | 27 | | |
| 05TM10 | 5/8-14 | 26 | 10 | 30 | | |
| 05TM12 | 3/4-14 | 26 | 10 | 32 | | |
| 05TM16 | 1-11 | 31 | 12 | 41 | | |
| 05TM20 | 1.1/4-11 | 34 | 14 | 50 | | |
| 05TM24 | 1.1/2-11 | 36 | 14 | 55 | | |
| 05TM32 | 2-11 | 43 | 17 | 70 | | |
| 05TM40 | 2.1/2-11 | 53 | 21 | 85 | | |
| 05TM48 | 3-11 | | | | | |
| | | | | | | |
| | | | | | | |
| | | | | | | |

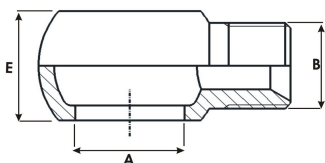
**OCCHIO FILETTATO
GAS SENZA BATTUTA**

| CODICE | Filetto A | Filetto B | L | E | | |
|-----------|-----------|-----------|----|----|--|--|
| 07OF02-02 | 1/8-28 | 1/8-28 | 27 | 11 | | |
| 07OF04-04 | 1/4-19 | 1/4-19 | 36 | 14 | | |
| 07OF06-04 | 3/8-19 | 1/4-19 | 41 | 17 | | |
| 07OF06-06 | 3/8-19 | 3/8-19 | 42 | 17 | | |
| 07OF06-08 | 3/8-19 | 1/2-14 | 48 | 20 | | |
| 07OF08-06 | 1/2-14 | 3/8-19 | 50 | 22 | | |
| 07OF08-08 | 1/2-14 | 1/2-14 | 50 | 22 | | |
| 07OF12-08 | 3/4-14 | 1/2-14 | 63 | 29 | | |
| 07OF12-12 | 3/4-14 | 3/4-14 | 60 | 30 | | |
| 07OF16-12 | 1-11 | 3/4-14 | 69 | 34 | | |
| 07OF16-16 | 1-11 | 1-11 | 82 | 38 | | |
| 07OF10-10 | 5/8-14 | 5/8-14 | 54 | 24 | | |
| 07OF14-04 | 14 | 1/4-19 | 36 | 14 | | |
| 07OF18-06 | 18 | 3/8-19 | 49 | 21 | | |
| 07OF18-08 | 18 | 1/2-14 | 50 | 21 | | |
| 07OF20-08 | 1.1/4-11 | 1/2-14 | 50 | 22 | | |

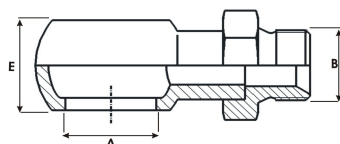
**OCCHIO FILETTATO
GAS CON BATTUTA**

| CODICE | Filetto A | Filetto B | L | E | CH | |
|------------|-----------|-----------|----|----|----|--|
| 07OFB0404 | 1/4-19 | 1/4-19 | 51 | 14 | 17 | |
| 07OFB0606 | 3/8-19 | 3/8-19 | 57 | 17 | 22 | |
| 07OFB0808 | 1/2-14 | 1/2-14 | 69 | 22 | 22 | |
| 07OFB06-04 | 3/8-19 | 1/4-19 | 45 | 20 | 25 | |
| 07OFB06-08 | 3/8-19 | 1/2-14 | 62 | 17 | 27 | |
| 07OFB08-06 | 1/2-14 | 3/8-19 | 66 | 22 | 32 | |
| 07OFB18-06 | 18 | 3/8-19 | 75 | 22 | 38 | |
| 07OFB18-08 | 18 | 1/2-14 | 75 | 22 | 38 | |
| | | | | | | |
| | | | | | | |
| | | | | | | |
| | | | | | | |
| | | | | | | |
| | | | | | | |
| | | | | | | |
| | | | | | | |

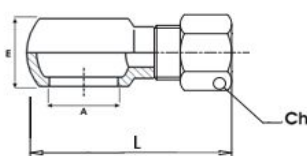
**OCCHIO FILETTO F.
GAS GIREVOLE**

| CODICE | Filetto A | Filetto B | L | E | CH | |
|------------|-----------|-----------|----|----|----|--|
| 07OFG04-04 | 1/4-19 | 1/4-19 | 52 | 14 | 19 | |
| 07OFG06-06 | 3/8-19 | 3/8-19 | 62 | 18 | 22 | |
| 07OFG08-08 | 1/2-14 | 1/2-14 | 72 | 22 | 27 | |
| | | | | | | |
| | | | | | | |
| | | | | | | |
| | | | | | | |
| | | | | | | |
| | | | | | | |
| | | | | | | |

**BORCHIA FILETTATA
F. A SALDARE**

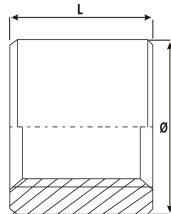

| CODICE | Filetto | L | Ø | | | |
|--------|----------|----|-----|--|--|--|
| 09BS02 | 1/8-28 | 13 | 17 | | | |
| 09BS04 | 1/4-19 | 16 | 20 | | | |
| 09BS06 | 3/8-19 | 17 | 26 | | | |
| 09BS08 | 1/2-14 | 18 | 30 | | | |
| 09BS10 | 5/8-14 | 19 | 32 | | | |
| 09BS12 | 3/4-14 | 20 | 38 | | | |
| 09BS16 | 1-11 | 25 | 46 | | | |
| 09BS20 | 1.1/4-11 | 26 | 56 | | | |
| 09BS24 | 1.1/2-11 | 30 | 62 | | | |
| 09BS32 | 2-11 | 30 | 75 | | | |
| 09BS40 | 2.1/2-11 | 40 | 90 | | | |
| 09BS48 | 3-11 | 40 | 105 | | | |

**BORCHIA DOPPIA
FILETTATA F. A
SALDARE**

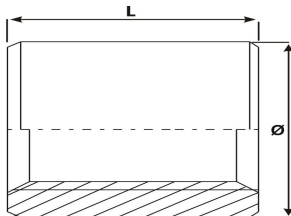

| CODICE | Filetto | L | Ø | | | |
|---------|----------|----|----|--|--|--|
| 09BSD04 | 1/4-19 | 25 | 20 | | | |
| 09BSD06 | 3/8-19 | 30 | 25 | | | |
| 09BSD08 | 1/2-14 | 35 | 30 | | | |
| 09BSD12 | 3/4-14 | 40 | 38 | | | |
| 09BSD16 | 1-11 | 40 | 45 | | | |
| 09BSD20 | 1.1/4-11 | 45 | 55 | | | |
| 09BSD24 | 1.1/2-11 | 48 | 62 | | | |
| 09BSD32 | 2-11 | | | | | |

**MANICOTTO
FILETTATO M. A
SALDARE**

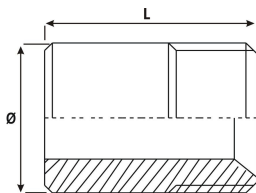

| CODICE | Filetto | L | Ø | | | |
|--------|----------|------|------|--|--|--|
| 09MS02 | 1/8-28 | 20 | 10 | | | |
| 09MS04 | 1/4-19 | 30 | 13 | | | |
| 09MS06 | 3/8-19 | 30 | 17 | | | |
| 09MS08 | 1/2-14 | 32 | 21 | | | |
| 09MS10 | 5/8-14 | 41 | 23 | | | |
| 09MS12 | 3/4-14 | 32.5 | 27 | | | |
| 09MS16 | 1-11 | 41 | 33 | | | |
| 09MS20 | 1.1/4-11 | 50 | 42 | | | |
| 09MS24 | 1.1/2-11 | 50 | 48 | | | |
| 09MS32 | 2-11 | 54 | 59.5 | | | |

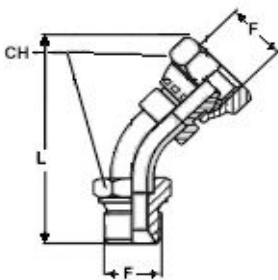
**ADATTATORE A 45°
M/F GIREVOLE GAS
CIL.**

| CODICE | F | L | CH | | | |
|--------|----------|-----|----|--|--|--|
| 12AQ02 | 1/8-28 | 55 | 14 | | | |
| 12AQ04 | 1/4-19 | 65 | 19 | | | |
| 12AQ06 | 3/8-19 | 75 | 22 | | | |
| 12AQ08 | 1/2-14 | 85 | 27 | | | |
| 12AQ10 | 5/8-14 | 90 | 27 | | | |
| 12AQ12 | 3/4-14 | 100 | 32 | | | |
| 12AQ16 | 1-11 | 120 | 38 | | | |
| 12AQ20 | 1.1/4-11 | 130 | 50 | | | |
| 12AQ24 | 1.1/2-11 | 130 | 55 | | | |
| 12AQ32 | 2-11 | 160 | 65 | | | |
| | | | | | | |
| | | | | | | |

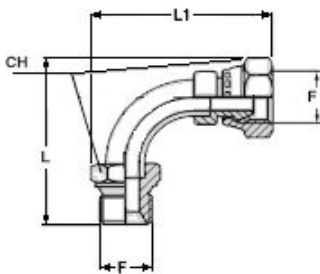
**ADATTATORE A 90°
M/F GIREVOLE GAS
CIL.**

| CODICE | F | L | L1 | CH | | |
|--------|----------|-----|-----|----|--|--|
| 12AN02 | 1/8-28 | 45 | 40 | 14 | | |
| 12AN04 | 1/4-19 | 50 | 45 | 19 | | |
| 12AN06 | 3/8-19 | 60 | 55 | 22 | | |
| 12AN08 | 1/2-14 | 70 | 60 | 27 | | |
| 12AN10 | 5/8-14 | 75 | 70 | 30 | | |
| 12AN12 | 3/4-14 | 80 | 80 | 32 | | |
| 12AN16 | 1-11 | 105 | 100 | 41 | | |
| 12AN20 | 1.1/4-11 | 130 | 130 | 50 | | |
| 12AN24 | 1.1/2-11 | 130 | 130 | 55 | | |
| 12AN32 | 2-11 | 160 | 160 | 70 | | |
| | | | | | | |
| | | | | | | |

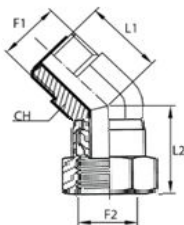
**ADATTATORE A 45°
M/F GIREVOLE GAS
CIL. - COMPATTO**

| CODICE | F1 GAS CIL | F2 GAS CIL | L1 | L2 | | |
|----------|---------------|---------------|------|------|--|--|
| 12AQST04 | 1/4" | 1/4" | 27 | 29 | | |
| 12AQST06 | 3/8" | 3/8" | 31.5 | 34 | | |
| 12AQST08 | 1/2" | 1/2" | 37 | 40 | | |
| 12AQST12 | 3/4" | 3/4" | 40 | 46 | | |
| 12AQST16 | 1" | 1" | 50 | 51.5 | | |
| 12AQST20 | 1"1/4 | 1"1/4 | 52 | 57 | | |
| 12AQST24 | 1"1/2 | 1"1/2 | 59 | 64 | | |
| | | | | | | |
| | | | | | | |

**ADATTATORE A 90°
M/F GIREVOLE GAS
CIL. - COMPATTO**

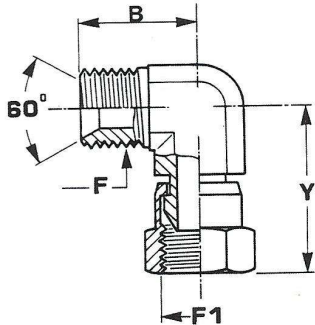

| CODICE | F GAS CIL | F1 GAS CIL | B | Y | | |
|----------|--------------|---------------|------|----|--|--|
| 12ANST02 | 1/8" | 1/8" | 20 | 25 | | |
| 12ANST04 | 1/4" | 1/4" | 25,4 | 29 | | |
| 12ANST06 | 3/8" | 3/8" | 28,5 | 34 | | |
| 12ANST08 | 1/2" | 1/2" | 35 | 40 | | |
| 12ANST12 | 3/4" | 3/4" | 47 | 46 | | |
| 12ANST16 | 1" | 1" | 52 | 52 | | |
| 12ANST20 | 1"1/4 | 1"1/4 | 60 | 55 | | |
| 12ANST24 | 1"1/2 | 1"1/2 | 60 | 66 | | |
| 12ANST32 | 2" | 2" | 60 | 78 | | |
| | | | | | | |
| | | | | | | |
| | | | | | | |
| | | | | | | |

**ADATTATORE A 45°
F/F GIREVOLE GAS**

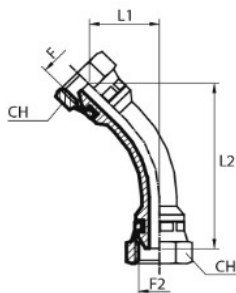

| CODICE | F | L1 | L2 | CH | | |
|--------|----------|----|-----|----|--|--|
| 14AQ04 | 1/4-19 | 18 | 52 | 19 | | |
| 14AQ06 | 3/8-19 | 24 | 66 | 22 | | |
| 14AQ08 | 1/2-14 | 28 | 78 | 27 | | |
| 14AQ10 | 5/8-14 | 31 | 73 | 28 | | |
| 14AQ12 | 3/4-14 | 33 | 101 | 32 | | |
| 14AQ16 | 1-11 | 37 | 115 | 38 | | |
| 14AQ20 | 1.1/4-11 | 37 | 119 | 50 | | |
| 14AQ24 | 1.1/2-11 | 39 | 125 | 55 | | |
| 14AQ32 | 2-11 | 41 | 132 | 70 | | |
| | | | | | | |
| | | | | | | |
| | | | | | | |
| | | | | | | |

**ADATTATORE A 90°
F/F GIREVOLE GAS**

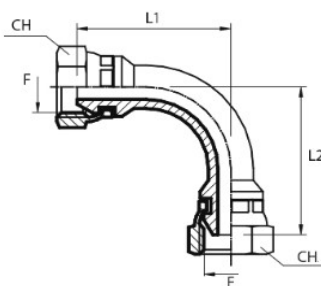

| CODICE | F | L1 | L2 | CH | | |
|--------|----------|-----|-----|----|--|--|
| 14AN02 | 1/8-28 | 29 | 31 | 15 | | |
| 14AN04 | 1/4-19 | 29 | 31 | 19 | | |
| 14AN06 | 3/8-19 | 39 | 44 | 22 | | |
| 14AN08 | 1/2-14 | 44 | 50 | 27 | | |
| 14AN10 | 5/8-14 | 48 | 50 | 28 | | |
| 14AN12 | 3/4-14 | 60 | 65 | 32 | | |
| 14AN16 | 1-11 | 70 | 83 | 38 | | |
| 14AN20 | 1.1/4-11 | 67 | 70 | 50 | | |
| 14AN24 | 1.1/2-11 | 80 | 95 | 55 | | |
| 14AN32 | 2-11 | 120 | 115 | 70 | | |
| | | | | | | |
| | | | | | | |
| | | | | | | |
| | | | | | | |

**ADATTATORE
COMPATTO A 90°
F/F GIREVOLE**

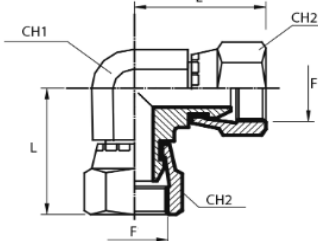

| CODICE | F | L | CH1 | CH2 | | |
|----------|----------|----|-----|-----|--|--|
| 14ANST04 | 1/4-19 | 31 | 14 | 19 | | |
| 14ANST06 | 3/8-19 | 36 | 19 | 22 | | |
| 14ANST08 | 1/2-14 | 39 | 22 | 27 | | |
| 14ANST12 | 3/4-14 | 45 | 27 | 32 | | |
| 14ANST16 | 1-11 | 50 | 33 | 38 | | |
| 14ANST20 | 1.1/4-11 | 64 | 41 | 50 | | |
| 14ANST24 | 1.1/2-11 | 78 | 50 | 55 | | |
| | | | | | | |
| | | | | | | |
| | | | | | | |
| | | | | | | |
| | | | | | | |
| | | | | | | |
| | | | | | | |
| | | | | | | |

**RACCORDO A
CROCE MASCHIO
GAS CILINDRICA**

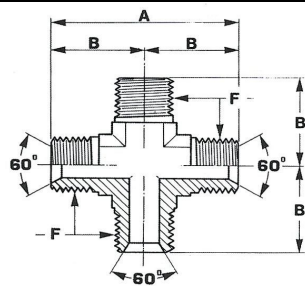

| CODICE | F GAS CIL. | A | B | | | |
|--------|---------------|----|----|--|--|--|
| 19MM02 | 1/8" | 40 | 20 | | | |
| 19MM04 | 1/4" | 54 | 27 | | | |
| 19MM06 | 3/8" | 60 | 30 | | | |
| 19MM08 | 1/2" | 70 | 35 | | | |
| 19MM10 | 5/8" | 80 | 40 | | | |
| 19MM12 | 3/4" | 80 | 40 | | | |
| 19MM16 | 1" | 96 | 48 | | | |
| | | | | | | |
| | | | | | | |
| | | | | | | |
| | | | | | | |
| | | | | | | |
| | | | | | | |
| | | | | | | |
| | | | | | | |

**RACCORDO A
CROCE FEMM. GAS
CILINDRICA**

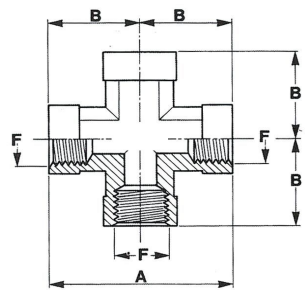

| CODICE | F GAS CIL. | A | B | | | |
|--------|---------------|----|----|--|--|--|
| 19FF02 | 1/8" | 34 | 17 | | | |
| 19FF04 | 1/4" | 44 | 22 | | | |
| 19FF06 | 3/8" | 52 | 26 | | | |
| 19FF08 | 1/2" | 62 | 31 | | | |
| 19FF12 | 3/4" | 70 | 35 | | | |
| 19FF16 | 1" | | | | | |
| | | | | | | |
| | | | | | | |
| | | | | | | |
| | | | | | | |
| | | | | | | |
| | | | | | | |
| | | | | | | |
| | | | | | | |
| | | | | | | |

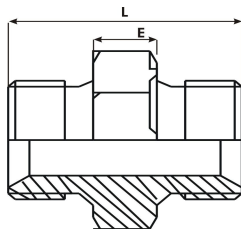
**NIPPO M/M
METRICO**

| CODICE | F | L | E | CH | | |
|---------|--------|----|----|----|--|--|
| 01NP10C | 10X1 | 22 | 6 | 14 | | |
| 01NP12A | 12X1,5 | 27 | 7 | 17 | | |
| 01NP14A | 14X1,5 | 31 | 7 | 19 | | |
| 01NP16A | 16X1,5 | 33 | 7 | 22 | | |
| 01NP18A | 18X1,5 | 36 | 8 | 24 | | |
| 01NP20A | 20X1,5 | 36 | 8 | 25 | | |
| 01NP22A | 22X1,5 | 38 | 8 | 27 | | |
| 01NP24A | 24X1,5 | 39 | 9 | 30 | | |
| 01NP26A | 26X1,5 | 43 | 9 | 32 | | |
| 01NP30A | 30X1,5 | 43 | 10 | 36 | | |
| | | | | | | |
| | | | | | | |

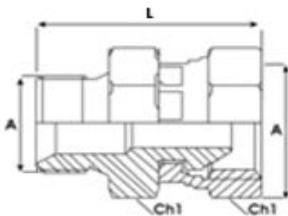
**NIPPO METRICO
M/F GIREVOLE**

| CODICE | Filetto A | L | CH | | | |
|---------|-----------|----|----|--|--|--|
| 01MG14A | 14X1,5 | 35 | 19 | | | |
| 01MG16A | 16X1,5 | 37 | 22 | | | |
| 01MG18A | 18X1,5 | 37 | 24 | | | |
| 01MG20A | 20X1,5 | 42 | 27 | | | |
| 01MG22A | 22X1,5 | 44 | 27 | | | |
| 01MG26A | 26X1,5 | 49 | 32 | | | |
| | | | | | | |
| | | | | | | |

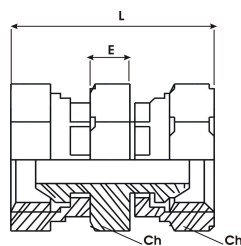
**GIUNZIONE METRICA
F/F GIREVOLE**

| CODICE | Filetto | L | E | CH1 | CH2 | |
|---------|---------|----|----|-----|-----|--|
| 01FG14A | 14X1,5 | 40 | 7 | 19 | 17 | |
| 01FG16A | 16X1,5 | 42 | 7 | 22 | 22 | |
| 01FG18A | 18X1,5 | 43 | 7 | 24 | 24 | |
| 01FG20A | 20X1,5 | 49 | 8 | 27 | 27 | |
| 01FG22A | 22X1,5 | 49 | 8 | 27 | 27 | |
| 01FG24A | 24X1,5 | 53 | 10 | 27 | 30 | |
| | | | | | | |
| | | | | | | |

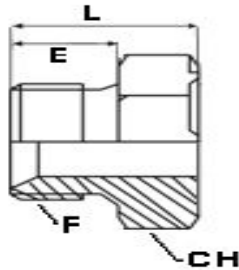
**MEZZO NIPPLO
METRICO A SALDARE**

| CODICE | F | L | E | CH | |
|---------|--------|----|----|----|--|
| 01NS10C | 10X1 | 15 | 8 | 15 | |
| 01NS12A | 12X1,5 | 18 | 11 | 17 | |
| 01NS14A | 14X1,5 | 19 | 12 | 19 | |
| 01NS16A | 16X1,5 | 21 | 13 | 22 | |
| 01NS18A | 18X1,5 | 21 | 13 | 22 | |
| 01NS20A | 20X1,5 | 23 | 14 | 27 | |
| 01NS22A | 22X1,5 | 23 | 15 | 27 | |
| 01NS24A | 24X1,5 | 25 | 16 | 30 | |
| 01NS26A | 26X1,5 | 26 | 16 | 32 | |
| 01NS30A | 30X1,5 | 29 | 18 | 36 | |
| | | | | | |
| | | | | | |
| | | | | | |
| | | | | | |
| | | | | | |

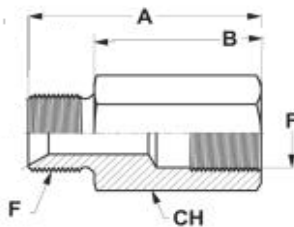
**COLONNETTA
METRICA M/F**

| CODICE | F | A | B | CH | |
|------------|--------|----|----|----|--|
| 01MF10C-20 | 10X1 | 29 | 20 | 14 | |
| 01MF10C-30 | 10X1 | 39 | 30 | 14 | |
| 01MF12A-20 | 12X1,5 | 32 | 20 | 17 | |
| 01MF12A-40 | 12X1,5 | 52 | 40 | 17 | |
| 01MF14A-20 | 14X1,5 | 32 | 20 | 19 | |
| 01MF14A-25 | 14X1,5 | 37 | 25 | 19 | |
| 01MF14A-35 | 14X1,5 | 47 | 35 | 19 | |
| 01MF14A-40 | 14X1,5 | 52 | 40 | 19 | |
| 01MF14A-50 | 14X1,5 | 62 | 50 | 19 | |
| 01MF16A-20 | 16X1,5 | 33 | 20 | 22 | |
| 01MF16A-35 | 16X1,5 | 48 | 35 | 22 | |
| 01MF16A-40 | 16X1,5 | 53 | 40 | 22 | |
| 01MF18A-20 | 18X1,5 | 35 | 20 | 24 | |
| 01MF18A-25 | 18X1,5 | 40 | 25 | 24 | |
| 01MF18A-30 | 18X1,5 | 45 | 30 | 24 | |
| 01MF18A-33 | 18X1,5 | 48 | 33 | 24 | |
| 01MF18A-40 | 18X1,5 | 55 | 40 | 24 | |
| 01MF18A-45 | 18X1,5 | 60 | 45 | 24 | |
| 01MF18A-50 | 18X1,5 | 65 | 50 | 24 | |
| 01MF18A-80 | 18X1,5 | 95 | 80 | 24 | |
| 01MF20A-45 | 20X1,5 | 60 | 45 | 27 | |
| 01MF22A-25 | 22X1,5 | 40 | 25 | 28 | |
| 01MF22A-45 | 22X1,5 | 60 | 45 | 28 | |
| 01MF22A-60 | 22X1,5 | 75 | 60 | 28 | |
| | | | | | |
| | | | | | |
| | | | | | |

**GIUNZIONE M GAS /
F GIREVOLE
METRICA**

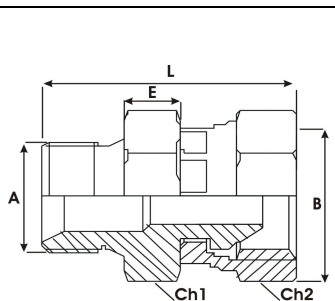

| CODICE | Filetto A | Filetto B | L | CH1 | CH2 |
|---------------|------------------|------------------|----------|------------|------------|
| 02MG04-12A | 1/4-19 | 12X1,5 | 32 | 17 | 17 |
| 02MG04-14A | 1/4-19 | 14X1,5 | 32 | 17 | 17 |
| 02MG04-16A | 1/4-19 | 16X1,5 | 35 | 19 | 22 |
| 02MG04-18A | 1/4-19 | 18X1,5 | 42 | 24 | 19 |
| 02MG06-16A | 3/8-19 | 16X1,5 | 40 | 22 | 22 |
| 02MG06-18A | 3/8-19 | 18X1,5 | 39 | 22 | 22 |
| 02MG08-18A | 1/2-14 | 18X1,5 | 43 | 27 | 22 |
| 02MG08-22A | 1/2-14 | 22X1,5 | 41 | 27 | 27 |
| 02MG12-18A | 3/4-14 | 18X1,5 | 53 | 31 | 24 |
| 02MG12-22A | 3/4-14 | 22X1,5 | 48 | 32 | 27 |
| 02MG16A-18A | 18X1,5 | 16X1,5 | 41 | 24 | 22 |
| 02MG18A-16A | 16X1,5 | 18X1,5 | 39 | 22 | 22 |

**NIPPLO M/M DI
RIDUZIONE
GAS/METRICA**

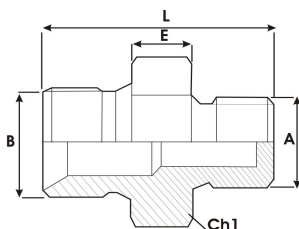

| CODICE | Filetto A | Filetto B | L | E | CH |
|---------------|------------------|------------------|----------|----------|-----------|
| 02NR02-10C | 1/8-28 | 10X1 | 25 | 6 | 14 |
| 02NR04-10C | 1/4-19 | 10X1 | 25 | 7 | 17 |
| 02NR04-10A | 1/4-19 | 10X1,5 | 28 | 6 | 19 |
| 02NR04-12A | 1/4-19 | 12X1,5 | 29 | 7 | 19 |
| 02NR04-14A | 1/4-19 | 14X1,5 | 28 | 7 | 19 |
| 02NR04-16A | 1/4-19 | 16X1,5 | 30 | 7 | 22 |
| 02NR04-18A | 1/4-19 | 18X1,5 | 30 | 7 | 22 |
| 02NR06-12A | 3/8-19 | 12X1,5 | 31 | 8 | 22 |
| 02NR06-14A | 3/8-19 | 14X1,5 | 30 | 7 | 22 |
| 02NR06-16A | 3/8-19 | 16X1,5 | 33 | 8 | 22 |
| 02NR06-18A | 3/8-19 | 18X1,5 | 35 | 8 | 24 |
| 02NR06-20A | 3/8-19 | 20X1,5 | 35 | 8 | 27 |
| 02NR06-22A | 3/8-19 | 22X1,5 | 35 | 8 | 27 |
| 02NR08-14A | 1/2-14 | 14X1,5 | 36 | 10 | 27 |
| 02NR08-16A | 1/2-14 | 16X1,5 | 35 | 8 | 27 |
| 02NR08-18A | 1/2-14 | 18X1,5 | 36 | 8 | 27 |
| 02NR08-20A | 1/2-14 | 20X1,5 | 37 | 8 | 27 |
| 02NR08-22A | 1/2-14 | 22X1,5 | 36 | 8 | 27 |
| 02NR08-24A | 1/2-14 | 24X1,5 | 39 | 9 | 30 |
| 02NR08-26A | 1/2-14 | 26X1,5 | 40 | 9 | 32 |
| 02NR10-18A | 5/8-14 | 18X1,5 | 40 | 10 | 27 |
| 02NR10-22A | 5/8-14 | 22X1,5 | 40 | 10 | 27 |
| 02NR12-18A | 3/4-14 | 18X1,5 | 39 | 9 | 32 |
| 02NR12-22A | 3/4-14 | 22X1,5 | 41 | 9 | 32 |
| 02NR12-24A | 3/4-14 | 24X1,5 | 43 | 10 | 32 |
| 02NR12-26A | 3/4-14 | 26X1,5 | 41 | 9 | 32 |
| 02NR16-26A | 1-11 | 26X1,5 | 48 | 12 | 40 |
| 02NR16-30A | 1-11 | 30X1,5 | 46 | 10 | 38 |
| 02NR12-33B | 3/4-14 | 33X2 | 48 | 13 | 40 |
| 02NR12-30A | 3/4-14 | 30X1,5 | 42 | 10 | 32 |

**RACCORDO
MASCHIO A T
METRICO**

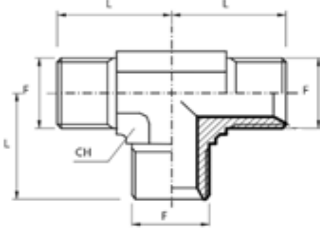

| CODICE | F | L | CH | | | |
|---------|--------|------|----|--|--|--|
| 04MW14A | 14X1,5 | 27 | 14 | | | |
| 04MW16A | 16X1,5 | 29 | 19 | | | |
| 04MW18A | 18X1,5 | 29 | 19 | | | |
| 04MW22A | 22X1,5 | 36,5 | 22 | | | |
| | | | | | | |
| | | | | | | |
| | | | | | | |
| | | | | | | |
| | | | | | | |
| | | | | | | |
| | | | | | | |
| | | | | | | |
| | | | | | | |
| | | | | | | |

**TAPPO METRICO
FEMMINA SEDE
OGIVA**

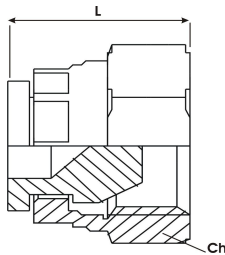

| CODICE | L | CH | | | | |
|---------|----|----|--|--|--|--|
| 05TF10C | 17 | 15 | | | | |
| 05TF14A | 17 | 19 | | | | |
| 05TF16A | 19 | 22 | | | | |
| 05TF18A | 20 | 24 | | | | |
| 05TF20A | 22 | 27 | | | | |
| 05TF22A | 22 | 27 | | | | |
| 05TF26A | 25 | 32 | | | | |
| | | | | | | |
| | | | | | | |
| | | | | | | |
| | | | | | | |
| | | | | | | |
| | | | | | | |
| | | | | | | |
| | | | | | | |

**TAPPO MASCHIO
METRICO TESTA
ESAGONALE**

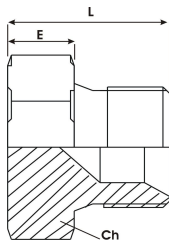

| CODICE | L | E | CH | | | |
|---------|----|----|----|--|--|--|
| 05TM10C | 14 | 6 | 14 | | | |
| 05TM12A | 17 | 6 | 17 | | | |
| 05TM14A | 18 | 7 | 19 | | | |
| 05TM16A | 20 | 8 | 22 | | | |
| 05TM18A | 21 | 8 | 24 | | | |
| 05TM20A | 24 | 9 | 28 | | | |
| 05TM22A | 24 | 9 | 28 | | | |
| 05TM24A | 24 | 9 | 30 | | | |
| 05TM26A | 25 | 9 | 32 | | | |
| 05TM30A | 26 | 10 | 36 | | | |
| | | | | | | |
| | | | | | | |
| | | | | | | |
| | | | | | | |
| | | | | | | |
| | | | | | | |
| | | | | | | |
| | | | | | | |

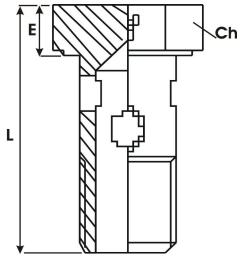
**VITE FORATA FIL.
METRICO**

| CODICE | Filetto A | L | E | CH | | |
|---------|-----------|----|-----|----|--|--|
| 06VS10C | 10X1 | 26 | 5 | 14 | | |
| 06VS10A | 10X1,5 | 27 | 6 | 14 | | |
| 06VS14A | 14X1,5 | 38 | 8 | 19 | | |
| 06VS16A | 16X1,5 | 40 | 8 | 22 | | |
| 06VS18A | 18X1,5 | 44 | 8,5 | 24 | | |
| 06VS20A | 20X1,5 | 45 | 8 | 27 | | |
| 06VS22A | 22X1,5 | 50 | 9 | 27 | | |
| 06VS24A | 24X1,5 | 49 | 9 | 30 | | |
| 06VS26A | 26X1,5 | 57 | 9,5 | 32 | | |
| 06VS8D | 8 | 29 | 4 | 13 | | |
| 06VS6C | 6X1 | 20 | 4 | 10 | | |
| 06VS8C | 8X1 | 22 | 4,5 | 12 | | |
| 06VS10D | 10 | 26 | 5 | 14 | | |
| 06VS12C | 12X1 | 28 | 5 | 17 | | |
| 06VS12D | 12 | 28 | 5 | 17 | | |
| 06VS24B | 24X2 | 56 | 10 | 30 | | |
| 06VS30A | 30X1,5 | 67 | 9 | 38 | | |

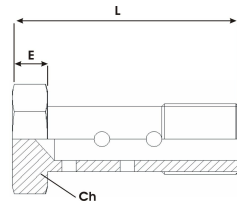
**VITE FORATA
DOPPIA FIL. METRICO**

| CODICE | Filetto A | L | E | CH | | |
|---------|-----------|----|-----|----|--|--|
| 06VD10C | 10X1 | 39 | 6 | 14 | | |
| 06VD12A | 12X1,5 | 47 | 7 | 17 | | |
| 06VD14A | 14X1,5 | 49 | 6,5 | 19 | | |
| 06VD16A | 16X1,5 | 58 | 8 | 22 | | |
| 06VD18A | 18X1,5 | 65 | 8 | 24 | | |
| 06VD8C | 8X1 | 30 | 4 | 12 | | |
| 06VD12C | 12X1,5 | 47 | 7 | 17 | | |

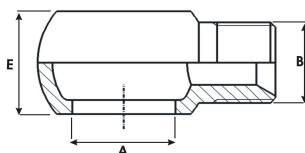
**OCCHIO FILETTATO
METRICO SENZA
BATTUTA**

| CODICE | Filetto A | Filetto B | L | E | | |
|------------|-----------|-----------|----|----|--|--|
| 07OF04-14A | 1/4-19 | 14X1,5 | 36 | 14 | | |
| 07OF06-16A | 3/8-19 | 16X1,5 | 40 | 17 | | |
| 07OF06-18A | 3/8-19 | 18X1,5 | 44 | 20 | | |
| 07OF08-18A | 1/2-14 | 18X1,5 | 48 | 23 | | |
| 07OF14-14A | ø 14 | 14X1,5 | 36 | 15 | | |
| 07OF16-16A | ø 16 | 16X1,5 | 40 | 18 | | |
| 07OF18-18A | ø 18 | 18X1,5 | 46 | 20 | | |
| 07OF18-22A | ø 18 | 22X1,5 | 50 | 22 | | |
| 07OF22-22A | ø 22 | 22X1,5 | 49 | 22 | | |

**ADATTATORE A 45°
M/F GIREVOLE
METRICO**

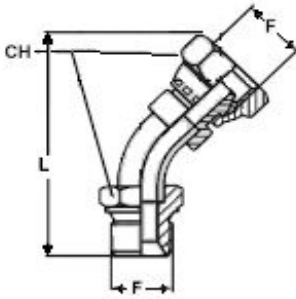

| CODICE | F | L | CH | | |
|---------|--------|----|----|--|--|
| 12AQ10C | 10X1 | 50 | 15 | | |
| 12AQ12A | 12X1,5 | 50 | 17 | | |
| 12AQ14A | 14X1,5 | 60 | 19 | | |
| 12AQ16A | 16X1,5 | 70 | 22 | | |
| 12AQ18A | 18X1,5 | 85 | 24 | | |
| 12AQ20A | 20X1,5 | 85 | 27 | | |
| 12AQ22A | 22X1,5 | 85 | 27 | | |
| | | | | | |
| | | | | | |
| | | | | | |
| | | | | | |
| | | | | | |
| | | | | | |
| | | | | | |
| | | | | | |

**ADATTATORE A 90°
M/F GIREVOLE
METRICO**

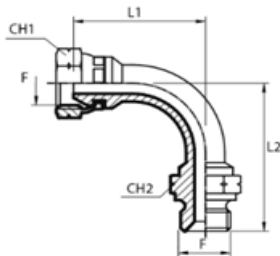

| CODICE | F | L1 | L2 | CH | |
|---------|--------|------|------|----|--|
| 12AN12A | 12X1,5 | 35 | 33 | 17 | |
| 12AN14A | 14X1,5 | 28 | 30 | 19 | |
| 12AN16A | 16X1,5 | 39 | 48 | 22 | |
| 12AN18A | 18X1,5 | 41 | 48 | 24 | |
| 12AN20A | 20X1,5 | 44,5 | 61,5 | 27 | |
| 12AN22A | 22X1,5 | 44,5 | 61,5 | 27 | |
| 12AN26A | 26X1,5 | 54 | 69 | 30 | |
| | | | | | |
| | | | | | |
| | | | | | |
| | | | | | |
| | | | | | |
| | | | | | |
| | | | | | |
| | | | | | |

**ADATTATORE A 90°
F/F GIREVOLE
METRICO**

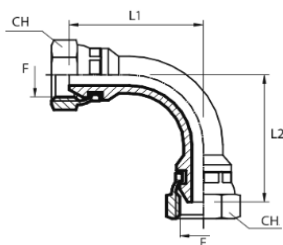

| CODICE | F | L1 | L2 | CH | |
|---------|--------|----|----|----|--|
| 14AN10C | 10X1 | 29 | 31 | 15 | |
| 14AN12A | 12X1,5 | 29 | 31 | 17 | |
| 14AN14A | 14X1,5 | 30 | 30 | 19 | |
| 14AN16A | 16X1,5 | 43 | 43 | 22 | |
| 14AN18A | 18X1,5 | 43 | 43 | 22 | |
| 14AN20A | 20X1,5 | 48 | 48 | 27 | |
| 14AN22A | 22X1,5 | 47 | 47 | 27 | |
| 14AN26A | 26X1,5 | 61 | 61 | 32 | |
| | | | | | |
| | | | | | |
| | | | | | |
| | | | | | |
| | | | | | |
| | | | | | |
| | | | | | |
| | | | | | |

**NIPPLO MASCHIO
ORFS**

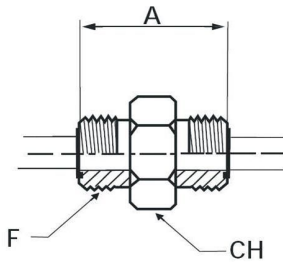

CODICE

F

A

CH

01NP04FRS
01NP06FRS
01NP08FRS
01NP10FRS
01NP12FRS
01NP16FRS
01NP20FRS
01NP24FRS

9/16-18
11/16-16
13/16-16
1-14
1-3/16-12
1-7/16-12
1-11/16-12
2-12

27.5
31
35.5
42.5
47
49.5
51.5
53

17
19
22
27
32
41
46
55

**RACCORDO ORFS
PASSAPARETE**

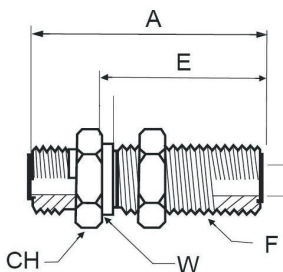

CODICE

F

A

E

W

CH

01PSP04FRS
01PSP06FRS
01PSP08FRS
01PSP10FRS
01PSP12FRS
01PSP16FRS
01PSP20FRS
01PSP24FRS

9/16-18
11/16-16
13/16-16
1-14
1-3/16-12
1-7/16-12
1-11/16-12
2-12

48
53
58,5
66,5
70
70
70
70

31,5
34
36,5
40,5
42
42
42
42

14,28
17,45
20,63
25,4
36,5
36,5
42,8
50,8

22
27
30
36
41
46
50
60

disponibili anche a 90° (cod. 01PSP90--FRS)

**MEZZO NIPPO A
SALDARE ORFS**

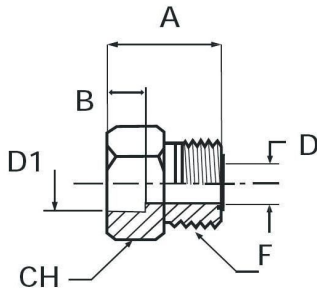

| CODICE | F | A | S | D | D1 |
|-----------|-----------|------|------|-------|------|
| 01NS04FRS | 9/16-18 | 22 | 8.5 | 6.15 | 5 |
| 01NS04FRS | 9/16-18 | 22 | 8.5 | 10.15 | 5 |
| 01NS06FRS | 11/16-16 | 23 | 8.5 | 10.15 | 6.5 |
| 01NS06FRS | 11/16-16 | 23 | 8.5 | 12.15 | 6.5 |
| 01NS08FRS | 13/16-16 | 24.5 | 8.5 | 12.5 | 9.5 |
| 01NS08FRS | 13/16-16 | 24.5 | 8.5 | 16.15 | 9.5 |
| 01NS10FRS | 1-14 | 27.5 | 9.5 | 16.15 | 12.5 |
| 01NS10FRS | 1-14 | 27.5 | 9.5 | 18.15 | 12.5 |
| 01NS12FRS | 1-3/16-12 | 33.5 | 12.5 | 18.5 | 15.5 |
| | | | | | |
| | | | | | |
| | | | | | |

**RACCORDO DIRITTO
ORFS / GAS CIL.**

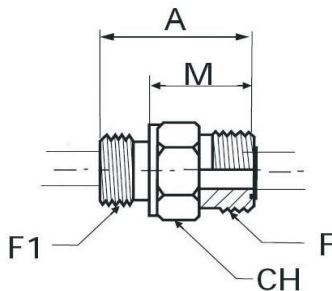

| CODICE | F | F1 GAS | A | M | CH |
|--------------|------------|-----------|------|------|----|
| 02NR02-04FRS | 9/16-18 | 1/8-28 | 25,5 | 17,5 | 17 |
| 02NR04-04FRS | 9/16-18 | 1/4-19 | 30,5 | 18,5 | 19 |
| 02NR06-04FRS | 9/16-18 | 3/8-19 | 31,5 | 19,5 | 22 |
| 02NR08-04FRS | 9/16-18 | 1/2-14 | 35,5 | 24,5 | 27 |
| 02NR02-06FRS | 11/16-16 | 1/8-28 | 31 | 23 | 19 |
| 02NR04-06FRS | 11/16-16 | 1/4-19 | 32 | 20 | 19 |
| 02NR08-06FRS | 11/16-16 | 1/2-14 | 37 | 24,5 | 27 |
| 02NR12-06FRS | 11/16-16 | 3/4-14 | 40,5 | 24,5 | 32 |
| 02NR06-06FRS | 11/16-16 | 3/8-16 | 33 | 21,5 | 22 |
| 02NR04-08FRS | 13/16-16 | 1/4-19 | 34,5 | 25,5 | 22 |
| 02NR06-08FRS | 13/16-16 | 3/8-19 | 34,5 | 22,5 | 22 |
| 02NR08-08FRS | 13/16-16 | 1/2-14 | 38,5 | 24,5 | 27 |
| 02NR12-08FRS | 13/16-16 | 3/4-14 | 42 | 26 | 32 |
| 02NR06-10FRS | 1-14 | 3/8-19 | 43 | 32 | 27 |
| 02NR08-10FRS | 1-14 | 1/2-14 | 41 | 27 | 27 |
| 02NR12-10FRS | 1-14 | 3/4-14 | 44,5 | 28,5 | 32 |
| 02NR16-10FRS | 1-14 | 1-11 | 48 | 30 | 41 |
| 02NR08-12FRS | 1-3/16-12 | 1/2-14 | 48,5 | 34,5 | 32 |
| 02NR12-12FRS | 1-3/16-12 | 3/4-14 | 46 | 30 | 32 |
| 02NR16-12FRS | 1-3/16-12 | 1-11 | 49 | 31 | 41 |
| 02NR20-12FRS | 1-3/16-12 | 1-1/4-11 | 53,5 | 33,5 | 50 |
| 02NR12-16FRS | 1-7/16-12 | 3/4-14 | 52 | 36 | 41 |
| 02NR16-16FRS | 1-7/16-12 | 1-11 | 50 | 31,5 | 41 |
| 02NR20-16FRS | 1-7/16-12 | 1-1/4-11 | 54 | 34 | 50 |
| 02NR24-16FRS | 1-7/16-12 | 1-1/2-11 | 57,5 | 35,5 | 55 |
| 02NR16-20FRS | 1-11/16-12 | 1-11 | 57,5 | 39,5 | 46 |
| 02NR20-20FRS | 1-11/16-12 | 1-1/4-11 | 54 | 34 | 50 |
| 02NR24-20FRS | 1-11/16-12 | 1-1/2-11 | 57,5 | 35,5 | 50 |
| 02NR32-24FRS | 2-12 | 2-11 | 57,5 | 35,5 | 55 |
| | | | | | |
| | | | | | |
| | | | | | |

**RACCORDO DIRITTO
ORFS / UNF-2A**

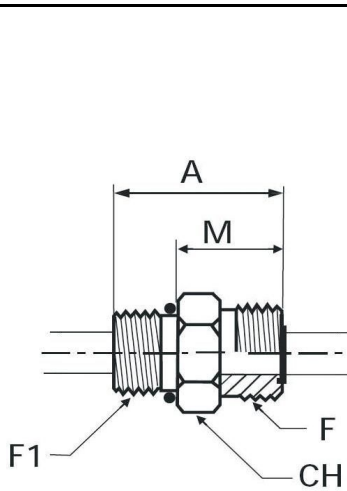

| CODICE | F ORFS | F1 UNF | A mm | M | CH mm | |
|-----------------|------------|-----------|---------|------|----------|--|
| 02NR04UNF-04FRS | 9/16-18 | 7/16-20 | 28,7 | 18,7 | 17 | |
| 02NR06UNF-04FRS | 9/16-18 | 9/16-18 | 30,5 | 18,5 | 19 | |
| 02NR08UNF-04FRS | 9/16-18 | 3/4-16 | 33,5 | 19,5 | 22 | |
| 02NR06UNF-06FRS | 11/16-16 | 9/16-18 | 32 | 21 | 19 | |
| 02NR08UNF-06FRS | 11/16-16 | 3/4-16 | 35 | 21 | 22 | |
| 02NR10UNF-06FRS | 11/16-16 | 7/8-14 | 38,8 | 28 | 27 | |
| 02NR04UNF-06FRS | 11/16-16 | 7/16-20 | 34 | 23 | 19 | |
| 02NR06UNF-08FRS | 13/16-16 | 9/16-18 | 37,5 | 26,5 | 22 | |
| 02NR08UNF-08FRS | 13/16-16 | 3/4-16 | 36,5 | 22,5 | 22 | |
| 02NR10UNF-08FRS | 13/16-16 | 7/8-14 | 40,4 | 24,4 | 27 | |
| 02NR12UNF-08FRS | 13/16-16 | 1-1/16-12 | 44,4 | 25,9 | 32 | |
| 02NR16UNF-08FRS | 13/16-16 | 1-5/16-12 | 45,5 | 27 | 38 | |
| 02NR08UNF-10FRS | 1-14 | 3/4-16 | 45 | 31 | 27 | |
| 02NR10UNF-10FRS | 1-14 | 7/8-14 | 43 | 27 | 27 | |
| 02NR12UNF-10FRS | 1-14 | 1-1/16-12 | 47 | 28,5 | 32 | |
| 02NR08UNF-12FRS | 1-3/16-12 | 3/4-16 | 48,5 | 34,5 | 32 | |
| 02NR10UNF-12FRS | 1-3/16-12 | 7/8-14 | 50,5 | 34,5 | 32 | |
| 02NR12UNF-12FRS | 1-3/16-12 | 1-1/16-12 | 48,5 | 30 | 32 | |
| 02NR16UNF-12FRS | 1-3/16-12 | 1/5-16-12 | 50 | 31,5 | 38 | |
| 02NR12UNF-16FRS | 1-7/16-12 | 1-1/16-12 | 56 | 37,5 | 38 | |
| 02NR20UNF-16FRS | 1-7/16-12 | 1-5/8-12 | 52,5 | 34 | 46 | |
| 02NR16UNF-16FRS | 1-7/16-12 | 1-5/16-12 | 50 | 32 | 38 | |
| 02NR16UNF-20FRS | 1-11/16-12 | 1-5/16-12 | 58 | 39,5 | 46 | |
| 02NR20UNF-20FRS | 1-11/16-12 | 1-5/8-12 | 52,5 | 34 | 46 | |
| 02NR24UNF-20FRS | 1-11/16-12 | 1-7/8-12 | 54 | 35,5 | 54 | |
| 02NR24UNF-20FRS | 1-11/16-12 | 1-7/8-12 | 54 | 35,5 | 55 | |
| 02NR20UNF-24FRS | 2-12 | 1-5/8-12 | 59,5 | 41 | 55 | |
| 02NR24UNF-24FRS | 2-12 | 1-7/8-12 | 54 | 35,5 | 55 | |
| 02NR24UNF-24FRS | 2-12 | 1-7/8-12 | 59,5 | 35,5 | 55 | |

**RACCORDO DIRITTO
ORFS / METRICO CIL.**

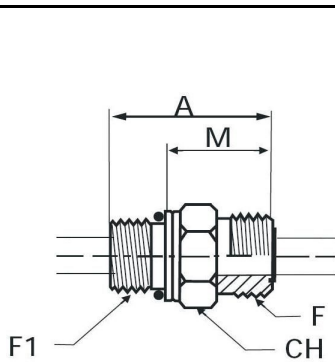

| CODICE | F | F1 UNF | A | M | CH | |
|-----------------|------------|-----------|------|------|----|--|
| 02NR12AMW-04FRS | 9/16-18 | M12X1,5 | 28,5 | 17,5 | 17 | |
| 02NR14AMW-04FRS | 9/16-18 | M14X1,5 | 29,5 | 18,5 | 19 | |
| 02NR12AMW-06FRS | 11/16-16 | M12X1,5 | 32 | 21 | 19 | |
| 02NR14AMW-06FRS | 11/16-16 | M14X1,5 | 32,5 | 20 | 22 | |
| 02NR16AMW-06FRS | 11/16-16 | M16X1,5 | 32,5 | 20 | 22 | |
| 02NR18AMW-08FRS | 13/16-16 | M18X1,5 | 36,5 | 22,5 | 24 | |
| 02NR22AMW-08FRS | 13/16-16 | M22X1,5 | 39,5 | 27 | 27 | |
| 02NR18AMW-10FRS | 1-14 | M18X1,5 | 41 | 27 | 27 | |
| 02NR22AMW-10FRS | 1-14 | M22X1,5 | 42 | 27 | 27 | |
| 02NR22AMW-12FRS | 1-3/16-12 | M22X1,5 | 45 | 27 | 32 | |
| 02NR27BMW-12FRS | 1-3/16-12 | M27X2 | 48,5 | 30 | 32 | |
| 02NR33BMW-12FRS | 1-3/16-12 | M33X2 | 51,5 | 33 | 32 | |
| 02NR33BMW-16FRS | 1-7/16-12 | M33X2 | 50,5 | 32 | 41 | |
| 02NR33BMW-20FRS | 1-11/16-12 | M33X2 | 53 | 34,5 | 46 | |
| 02NR42BMW-20FRS | 1-11/16-12 | M42X2 | 53 | 34 | 50 | |
| 02NR48BMW-24FRS | 2-12 | M48X2 | 57 | 35,5 | 55 | |

**RACCORDO
INTERMEDIO A 90°
M/M ORFS**

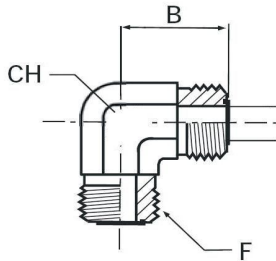

| CODICE | F | B | D | CH | | |
|-----------|------------|------|------|----|--|--|
| 03MM04FRS | 9/16-18 | 21,5 | 5 | 14 | | |
| 03MM06FRS | 11/16-16 | 25 | 6,5 | 19 | | |
| 03MM08FRS | 13/16-16 | 28 | 9,5 | 19 | | |
| 03MM10FRS | 1-14 | 33,5 | 12,5 | 27 | | |
| 03MM12FRS | 1-3/16-12 | 37,5 | 15,5 | 30 | | |
| 03MM16FRS | 1-7/16-12 | 41,5 | 20,5 | 36 | | |
| 03MM20FRS | 1-11/16-12 | 44,5 | 26 | 41 | | |
| 03MM24FRS | 2-12 | 49 | 32 | 48 | | |
| | | | | | | |
| | | | | | | |
| | | | | | | |
| | | | | | | |

**RACCORDO
INTERMEDIO MMM A
T ORFS**

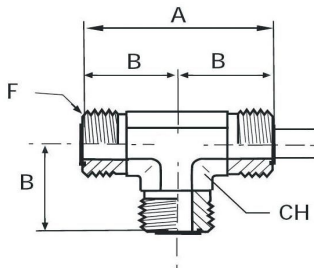

| CODICE | F | B | D | CH | | |
|-----------|------------|------|------|----|--|--|
| 04MM04FRS | 9/16-18 | 21,5 | 5 | 14 | | |
| 04MM06FRS | 11/16-16 | 25 | 6,5 | 19 | | |
| 04MM08FRS | 13/16-16 | 28 | 9,5 | 19 | | |
| 04MM10FRS | 1-14 | 33,5 | 12,5 | 27 | | |
| 04MM12FRS | 1-3/16-12 | 37,5 | 15,5 | 30 | | |
| 04MM16FRS | 1-7/16-12 | 41,5 | 20,5 | 36 | | |
| 04MM20FRS | 1-11/16-12 | 44,5 | 26 | 41 | | |
| 04MM24FRS | 2-12 | 49 | 32 | 48 | | |
| | | | | | | |
| | | | | | | |
| | | | | | | |
| | | | | | | |

**RACCORDO A T
ORFS CON DADO
GIREVOLE CENTRALE**

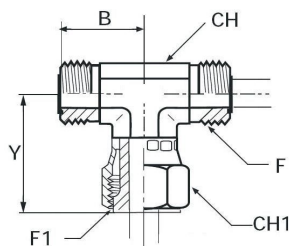

| CODICE | F | F1 | B | Y | CH1 | |
|-------------|------------|------------|------|------|-----|--|
| 04CMFG04FRS | 9/16-18 | 9/16-18 | 21,5 | 26,5 | 14 | |
| 04CMFG06FRS | 11/16-16 | 11/16-16 | 25 | 29,5 | 19 | |
| 04CMFG08FRS | 13/16-16 | 13/16-16 | 28 | 38 | 24 | |
| 04CMFG10FRS | 1-14 | 1-14 | 33,5 | 41 | 27 | |
| 04CMFG12FRS | 1-3/16-16 | 1-3/16-12 | 37,5 | 46,5 | 32 | |
| 04CMFG16FRS | 1-7/16-12 | 1-7/16-12 | 41,5 | 53 | 38 | |
| 04CMFG20FRS | 1-11/16-12 | 1-11/16-12 | 44,5 | 58 | 50 | |
| 04CMFG24FRS | 2-12 | 2-12 | 49 | 61 | 55 | |
| | | | | | | |
| | | | | | | |
| | | | | | | |
| | | | | | | |

RACCORDO ORFS A T CON DADO GIREVOLE LATERALE

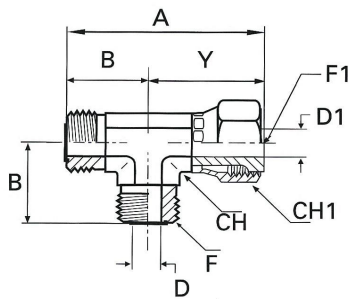

| CODICE | F | F1 | B | Y | CH1 | |
|-------------|------------|------------|------|------|-----|--|
| 04LMFG04FRS | 9/16-18 | 9/16-18 | 21,5 | 26,5 | 14 | |
| 04LMFG06FRS | 11/16-16 | 11/16-16 | 25 | 29,5 | 19 | |
| 04LMFG08FRS | 13/16-16 | 13/16-16 | 28 | 38 | 24 | |
| 04LMFG10FRS | 1-14 | 1-14 | 33,5 | 41 | 27 | |
| 04LMFG12FRS | 1-3/16-12 | 1-3/16-12 | 37,5 | 46,5 | 32 | |
| 04LMFG16FRS | 1-7/16-12 | 1-7/16-12 | 41,5 | 53 | 38 | |
| 04LMFG20FRS | 1-11/16-12 | 1-11/16-12 | 44,5 | 58 | 50 | |
| 04LMFG24FRS | 2-12 | 2-12 | 49 | 61 | 55 | |
| | | | | | | |
| | | | | | | |
| | | | | | | |
| | | | | | | |

TAPPO ORFS MASCHIO

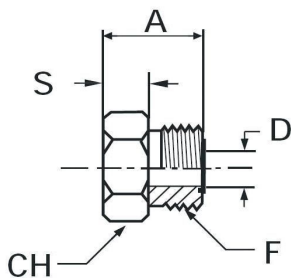

| CODICE | F | A | S | D | CH | |
|-----------|------------|------|------|------|----|--|
| 05TM04FRS | 9/16-18 | 16,5 | 6,5 | 5 | 17 | |
| 05TM06FRS | 11/16-16 | 19 | 8 | 6,5 | 19 | |
| 05TM08FRS | 13/16-16 | 22 | 9 | 9,5 | 22 | |
| 05TM10FRS | 1-14 | 26 | 10,5 | 12,5 | 27 | |
| 05TM12FRS | 1-3/16-12 | 27,5 | 10,5 | 15,5 | 32 | |
| 05TM16FRS | 1-7/16-12 | 28 | 10,5 | 20,5 | 41 | |
| 05TM20FRS | 1-11/16-12 | 28 | 10,5 | 26 | 46 | |
| 05TM24FRS | 2-12 | 28 | 10,5 | 32 | 55 | |
| | | | | | | |
| | | | | | | |
| | | | | | | |
| | | | | | | |

TAPPO ORFS FEMMINA

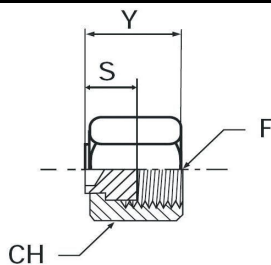

| CODICE | F | Y | S | CH | | |
|-----------|------------|------|------|----|--|--|
| 05TF04FRS | 9/16-18 | 16,5 | 8,5 | 17 | | |
| 05TF06FRS | 11/16-16 | 18 | 9,5 | 22 | | |
| 05TF08FRS | 13/16-16 | 22 | 12 | 24 | | |
| 05TF10FRS | 1-14 | 24,5 | 12 | 30 | | |
| 05TF12FRS | 1-3/16-12 | 27 | 13,5 | 36 | | |
| 05TF16FRS | 1-7/16-12 | 28,5 | 15 | 41 | | |
| 05TF20FRS | 1-11/16-12 | 28,5 | 15 | 50 | | |
| 05TF24FRS | 2-12 | 28,5 | 15 | 60 | | |
| | | | | | | |
| | | | | | | |
| | | | | | | |
| | | | | | | |

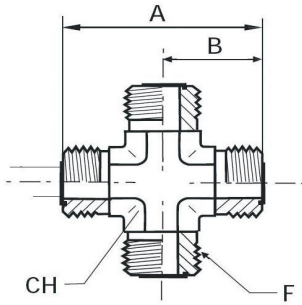
**RACCORDO
 MASCHIO ORFS
 INTERMEDIO A
 CROCE**

| CODICE | F | A | B | CH | | |
|-----------|------------|----|------|------|--|--|
| 19MM04FRS | 9/16-18 | 43 | 21,5 | 5 | | |
| 19MM06FRS | 11/16-16 | 50 | 25 | 6,5 | | |
| 19MM08FRS | 13/16-16 | 56 | 28 | 9,5 | | |
| 19MM10FRS | 1-14 | 67 | 33,5 | 12,5 | | |
| 19MM12FRS | 1-3/16-12 | 75 | 37,5 | 15,5 | | |
| 19MM16FRS | 1-7/16-12 | 83 | 41,5 | 20,5 | | |
| 19MM20FRS | 1-11/16-12 | 89 | 44,5 | 26 | | |
| 19MM24FRS | 2-12 | 98 | 49 | 32 | | |
| | | | | | | |
| | | | | | | |
| | | | | | | |
| | | | | | | |

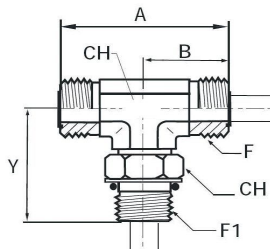
**RACC. DI
 ESTREMITA' A T
 ORIENT. ORFS /
 CENTR. FIL. UNF-2A**

| CODICE | F | F1 | A | B | CH1 | |
|----------------|------------|-----------|------|------|-----|--|
| 33RCMRS04-MS04 | 9/16-18 | 7/16-20 | 21,5 | 30,2 | 14 | |
| 33RCMRS06-MS06 | 11/16-16 | 9/16-18 | 23,5 | 33,5 | 19 | |
| 33RCMRS08-MS08 | 13/16-16 | 3/4-16 | 25 | 35,5 | 19 | |
| 33RCMRS10-MS10 | 1"-14 | 7/8-14 | 26,5 | 38 | 27 | |
| 33RCMRS12-MS12 | 1-3/16-12 | 1-1/16-12 | 28 | 38 | 30 | |
| 33RCMRS16-MS16 | 1-7/16-12 | 1-5/16-12 | 33,5 | 51,4 | 36 | |
| 33RCMRS20-MS20 | 1-11/16-12 | 1-5/8-12 | 33,5 | 48,6 | 41 | |
| 33RCMRS24-MS24 | 2-12 | 1-7/8-12 | 33,5 | 40,7 | 48 | |
| | | | | | | |
| | | | | | | |
| | | | | | | |
| | | | | | | |

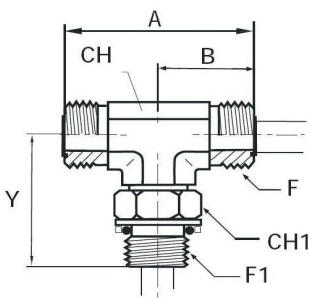
**RACC. DI
 ESTREMITA' A T
 ORIENT. ORFS /
 CENTR. FIL. GAS CIL.**

| CODICE | F | F1 | A | B | Y | |
|-----------------|------------|------|------|------|------|--|
| 33RCM04FRS-MG02 | 9/16-18 | 1/8 | 43 | 21,5 | 30,2 | |
| 33RCM04FRS-MG04 | 9/16-18 | 1/4 | 47 | 23,5 | 36 | |
| 33RCM06FRS-MG04 | 11/16-16 | 1/4 | 50 | 25 | 36 | |
| 33RCM06FRS-MG06 | 11/16-16 | 3/8 | 53 | 26,5 | 38 | |
| 33RCM08FRS-MG06 | 13/16-16 | 3/8 | 56 | 28 | 38 | |
| 33RCM08FRS-MG08 | 13/16-16 | 1/2 | 56 | 28 | 38 | |
| 33RCM10FRS-MG08 | 1-14 | 1/2 | 67 | 33,5 | 48,6 | |
| 33RCM10FRS-MG12 | 1-14 | 3/4 | 71,6 | 35,8 | 51,5 | |
| 33RCM12FRS-MG12 | 1-3/16-12 | 3/4 | 75 | 37,5 | 51,5 | |
| 33RCM16FRS-MG16 | 1-7/16-12 | 1 | 83 | 41,5 | 58,4 | |
| 33RCM20FRS-MG20 | 1-11/16-12 | 1-14 | 85 | 44,5 | 61 | |
| 33RCM24FRS-MG20 | 2-12 | 1-14 | 98 | 49 | 65 | |
| | | | | | | |
| | | | | | | |
| | | | | | | |
| | | | | | | |

NIPPLO M/M JIC

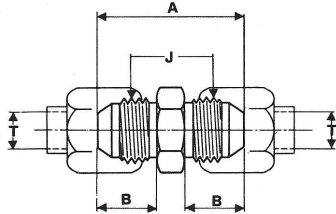

CODICE

J

A

B

| | | | |
|--------|-----------|------|------|
| 32MI04 | 7/16-20 | 34,5 | 14 |
| 32MI05 | 1/2-20 | 34,5 | 14 |
| 32MI06 | 9/16-18 | 35,5 | 14 |
| 32MI08 | 3/4-16 | 41 | 17 |
| 32MI10 | 7/8-14 | 47,5 | 19,5 |
| 32MI12 | 1"1/16-12 | 55 | 22 |
| 32MI16 | 1"5/16-12 | 57 | 23 |
| 32MI20 | 1"5/8-12 | 61,5 | 24,5 |
| 32MI24 | 1"7/8-12 | 69,5 | 27,5 |
| | | | |
| | | | |
| | | | |

**RACCORDO
INTERMEDIO
DIRITTO
PASSAPARETE JIC**

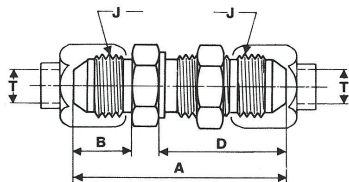

CODICE

J

A

B

D

| | | | | |
|---------|-----------|------|------|------|
| 32PMI04 | 7/16-20 | 52,5 | 14 | 30,5 |
| 32PMI05 | 1/2-20 | 52,5 | 14 | 30,5 |
| 32PMI06 | 9/16-18 | 55,5 | 14 | 32,5 |
| 32PMI08 | 3/4-16 | 62 | 17 | 36,5 |
| 32PMI10 | 7/8-14 | 69,5 | 19,5 | 40 |
| 32PMI12 | 1"1/16-12 | 78,5 | 22 | 44,5 |
| 32PMI16 | 1"5/16-12 | 80 | 23 | 44,5 |
| 32PMI20 | 1"5/8-12 | 84 | 24,5 | 45,7 |
| 32PMI24 | 1"7/8-12 | 89,5 | 27,5 | 46 |
| | | | | |
| | | | | |
| | | | | |

**RACCORDO M JIC /
F GIREVOLE JIC**

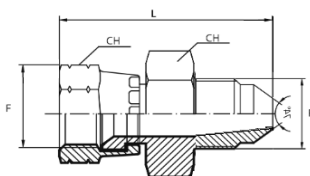

CODICE

F

L

CH

| | | | |
|-----------|-----------|----|----|
| 32FI-MI04 | 7/16-20 | 36 | 13 |
| 32FI-MI05 | 1/2-20 | 40 | 15 |
| 32FI-MI06 | 9/16-18 | 44 | 17 |
| 32FI-MI08 | 3/4-16 | 48 | 22 |
| 32FI-MI10 | 7/8-14 | 55 | 27 |
| 32FI-MI12 | 1"1/16-12 | 60 | 32 |
| 32FI-MI16 | 1"5/16-12 | 65 | 41 |
| | | | |
| | | | |
| | | | |

**RACCORDO
MASCHIO
INTERMEDIO A T JIC**

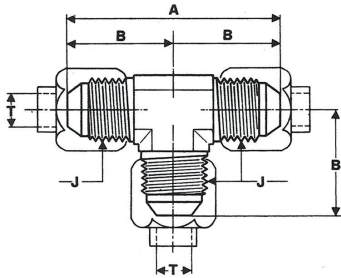

| CODICE | J | A | B | | |
|--------|-----------|-----|------|--|--|
| 33MI04 | 7/16-20 | 45 | 22.5 | | |
| 33MI05 | 1/2-20 | 48 | 24 | | |
| 33MI06 | 9/16-18 | 54 | 27 | | |
| 33MI08 | 3/4-16 | 63 | 31.5 | | |
| 33MI10 | 7/8-14 | 73 | 36.5 | | |
| 33MI12 | 1"1/16-12 | 84 | 42 | | |
| 33MI16 | 1"5/16-12 | 92 | 46 | | |
| 33MI20 | 1"5/8-12 | 104 | 52 | | |
| 33MI24 | 1"7/8-12 | 118 | 59 | | |
| | | | | | |
| | | | | | |

**RACCORDO A T
F. CENTRALE
GIREVOLE JIC**

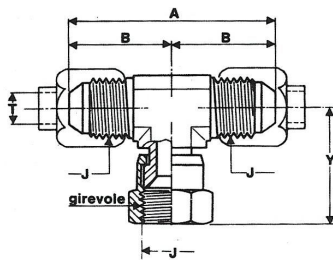

| CODICE | J | A | B | Y | |
|------------|-----------|-----|------|------|--|
| 33CMI-FI04 | 7/16-20 | 45 | 22.5 | 26 | |
| 33CMI-FI05 | 1/2-20 | 48 | 24 | 28 | |
| 33CMI-FI06 | 9/16-18 | 54 | 27 | 31 | |
| 33CMI-FI08 | 3/4-16 | 63 | 31.5 | 35.5 | |
| 33CMI-FI10 | 7/8-14 | 73 | 36.5 | 42 | |
| 33CMI-FI12 | 1"1/16-12 | 84 | 42 | 45.5 | |
| 33CMI-FI16 | 1"5/16-12 | 92 | 46 | 51.5 | |
| 33CMI-FI20 | 1"5/8-12 | 105 | 52.5 | 59 | |
| 33CMI-FI24 | 1"7/8-12 | 118 | 59 | 65.5 | |
| | | | | | |
| | | | | | |

**RACCORDO A T
F. LATERALE
GIREVOLE JIC**

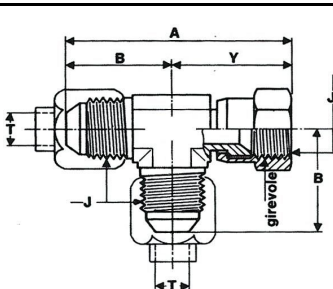

| CODICE | J | A | B | Y | |
|------------|-----------|-------|------|------|--|
| 33LMI-FI04 | 7/16-20 | 48,5 | 22,5 | 26 | |
| 33LMI-FI05 | 1/2-20 | 52 | 24 | 28 | |
| 33LMI-FI06 | 9/16-18 | 58 | 27 | 31 | |
| 33LMI-FI08 | 3/4-16 | 67 | 31,5 | 35,5 | |
| 33LMI-FI10 | 7/8-14 | 78,5 | 36,5 | 42 | |
| 33LMI-FI12 | 1"1/16-12 | 87,5 | 42 | 45,5 | |
| 33LMI-FI16 | 1"5/16-12 | 97,5 | 46 | 51,5 | |
| 33LMI-FI20 | 1"5/8-12 | 111,5 | 52,5 | 59 | |
| 33LMI-FI24 | 1"7/8-12 | 124,5 | 59 | 65,5 | |
| | | | | | |
| | | | | | |

**RACCORDO M/M JIC
INTERMEDIO A 90°**

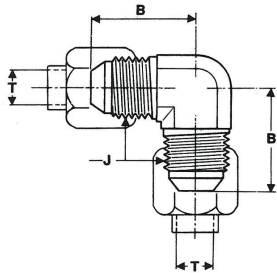

| CODICE | J | B | | | |
|--------|-----------|------|--|--|--|
| 39MI04 | 7/16-20 | 22,5 | | | |
| 39MI05 | 1/2-20 | 24 | | | |
| 39MI06 | 9/16-18 | 27 | | | |
| 39MI08 | 3/4-16 | 31,5 | | | |
| 39MI10 | 7/8-14 | 36,5 | | | |
| 39MI12 | 1"1/16-12 | 42 | | | |
| 39MI16 | 1"5/16-12 | 46 | | | |
| 39MI20 | 1"5/8-12 | 52 | | | |
| 39MI24 | 1"7/8-12 | 59 | | | |
| | | | | | |
| | | | | | |

**RACCORDO
INTERMEDIO M/F JIC
90° CON DADO
GIREVOLE**

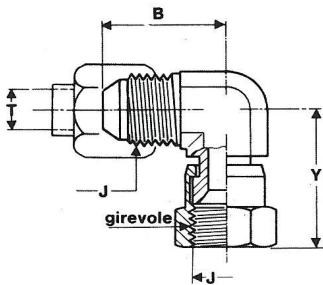

| CODICE | J | B | Y | | |
|----------|-----------|------|------|--|--|
| 39MIFI04 | 7/16-20 | 22,5 | 26 | | |
| 39MIFI05 | 1/2-20 | 24 | 28,5 | | |
| 39MIFI06 | 9/16-18 | 27 | 30 | | |
| 39MIFI08 | 3/4-16 | 31,5 | 35,5 | | |
| 39MIFI10 | 7/8-14 | 36,5 | 42 | | |
| 39MIFI12 | 1"1/16-12 | 42 | 44,5 | | |
| 39MIFI16 | 1"5/16-12 | 46 | 50 | | |
| 39MIFI20 | 1"5/8-12 | 52,5 | 59 | | |
| 39MIFI24 | 1"7/8-12 | 59 | 65,5 | | |
| | | | | | |
| | | | | | |

**RACCORDO
INTERMEDIO JIC 90°
PASSAPARETE**

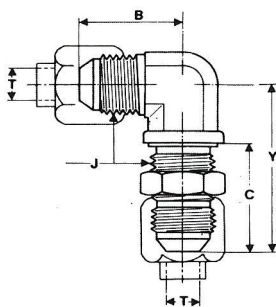

| CODICE | J | B | Y | C | |
|---------|-----------|------|------|------|--|
| 39PMI04 | 7/16-20 | 24,5 | 40,5 | 28,5 | |
| 39PMI05 | 1/2-20 | 26 | 41 | 28,5 | |
| 39PMI06 | 9/16-18 | 27,5 | 46 | 30 | |
| 39PMI08 | 3/4-16 | 34,5 | 53,5 | 35 | |
| 39PMI10 | 7/8-14 | 39,5 | 60,5 | 38,5 | |
| 39PMI12 | 1"1/16-12 | 45 | 68 | 42,5 | |
| 39PMI16 | 1"5/16-12 | 49 | 71 | 42,5 | |
| | | | | | |
| | | | | | |

**RACC. DI
ESTREMITA' A 90° M
JIC / M FIL. TERM.
GAS CONICO**

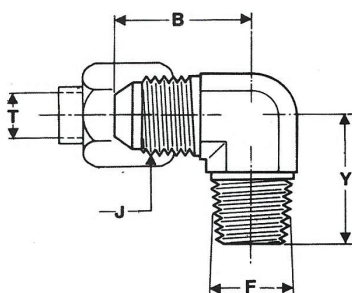

| CODICE | J | F GAS CON | B | Y | |
|-------------|-----------|--------------|------|------|--|
| 39MI04MGC02 | 7/16-20 | 1/8" | 22.5 | 19.5 | |
| 39MI04MGC04 | 7/16-20 | 1/4" | 27 | 27.5 | |
| 39MI05MGC02 | 1/2-20 | 1/8" | 24 | 19.5 | |
| 39MI05MGC04 | 1/2-20 | 1/4" | 27 | 27.5 | |
| 39MI06MGC04 | 9/16-18 | 1/4" | 27 | 27.5 | |
| 39MI06MGC06 | 9/16-18 | 3/8" | 28.5 | 31 | |
| 39MI06MGC08 | 9/16-18 | 1/2" | 31 | 37 | |
| 39MI08MGC04 | 3/4-16 | 1/4" | 31.5 | 31 | |
| 39MI08MGC06 | 3/4-16 | 3/8" | 31.5 | 31 | |
| 39MI08MGC08 | 3/4-16 | 1/2" | 34 | 37 | |
| 39MI08MGC12 | 3/4-16 | 3/4" | 36.5 | 40.5 | |
| 39MI10MGC06 | 7/8-14 | 3/8" | 36.5 | 32 | |
| 39MI10MGC08 | 7/8-14 | 1/2" | 36.5 | 37 | |
| 39MI10MGC12 | 7/8-14 | 3/4" | 39.5 | 40.5 | |
| 39MI12MGC08 | 1"1/16-12 | 1/2" | 42 | 40.5 | |
| 39MI12MGC12 | 1"1/16-12 | 3/4" | 42 | 40.5 | |
| 39MI16MGC12 | 1"5/16-12 | 3/4" | 46 | 45 | |
| 39MI16MGC16 | 1"5/16-12 | 1" | 46 | 50 | |
| 39MI20MGC16 | 1"5/8-12 | 1" | 52 | 59 | |
| 39MI20MGC20 | 1"5/8-12 | 1"1/4" | 52 | 60 | |
| 39MI24MGC24 | 1"7/8-12 | 1"1/2" | 59 | 67 | |

**RACC. DI
ESTREMITA' A 90° M
JIC / M FIL. TERM.
GAS CILIN.**

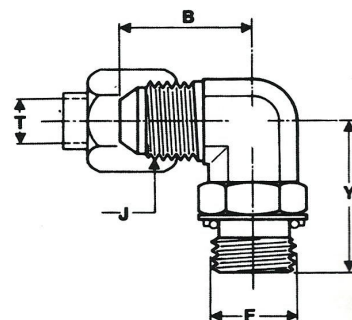

| CODICE | J | F GAS CIL. | B | Y | |
|-------------|-----------|---------------|------|------|--|
| 39RMI04MG02 | 7/16-20 | 1/8" | 22.5 | 26 | |
| 39RMI04MG04 | 7/16-20 | 1/4" | 27 | 31.5 | |
| 39RMI05MG02 | 1/2-20 | 1/8" | 24 | 27.5 | |
| 39RMI05MG04 | 1/2-20 | 1/4" | 27 | 31.5 | |
| 39RMI06MG04 | 9/16-18 | 1/4" | 27 | 31.5 | |
| 39RMI06MG06 | 9/16-18 | 3/8" | 28.5 | 36.5 | |
| 39RMI06MG08 | 9/16-18 | 1/2" | 31 | 43 | |
| 39RMI08MG04 | 3/4-16 | 1/4" | 31.5 | 33.5 | |
| 39RMI08MG06 | 3/4-16 | 3/8" | 31.5 | 36.5 | |
| 39RMI08MG08 | 3/4-16 | 1/2" | 34 | 43 | |
| 39RMI10MG08 | 7/8-14 | 1/2" | 36.5 | 43 | |
| 39RMI10MG06 | 7/8-14 | 3/8" | 36.5 | 39.5 | |
| 39RMI10MG12 | 7/8-14 | 3/4" | 36.5 | 49 | |
| 39RMI12MG12 | 1"1/16-12 | 3/4" | 42 | 49 | |
| 39RMI12MG08 | 1"1/16-12 | 1/2" | 42 | 45.5 | |
| 39RMI12MG16 | 1"1/16-12 | 1" | 44.5 | 52 | |
| 39RMI16MG12 | 1"5/16-12 | 3/4" | 46 | 52 | |
| 39RMI16MG16 | 1"5/16-12 | 1" | 46 | 52 | |
| 39RMI16MG20 | 1"5/16-12 | 1"1/4" | 51 | 57 | |
| 39RMI20MG16 | 1"5/8-12 | 1" | 52 | 57 | |
| 39RMI20MG20 | 1"5/8-12 | 1"1/4" | 52 | 57 | |
| 39RMI24MG20 | 1"7/8-12 | 1"1/4" | 59 | 57 | |
| 39RMI24MG24 | 1"7/8-12 | 1"1/2" | 59 | 61 | |

NIPPLI

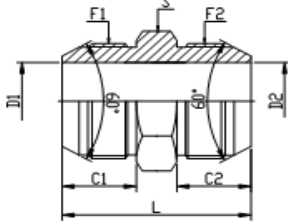

| CODICE | F1 | F2 | S | L | C1 e C2 |
|----------|--------|--------|----|----|---------|
| 01NPG04 | 1/4" | 1/4" | 17 | 38 | 16 |
| 01NPG06 | 3/8" | 3/8" | 19 | 42 | 18 |
| 01NPG08 | 1/2" | 1/2" | 22 | 48 | 20 |
| 01NPG12 | 3/4" | 3/4" | 30 | 54 | 22 |
| 01NPG14A | 14x1,5 | 14x1,5 | | | |
| 01NPG16A | 16x1,5 | 16x1,5 | | | |
| 01NPG18A | 18x1,5 | 18x1,5 | | | |

TAPPI MASCHIO

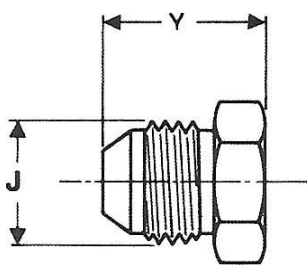

| CODICE | FIL (J) | Y | CH | | |
|----------|---------|---|----|--|--|
| 05TMG04 | 1/4" | | | | |
| 05TMG06 | 3/8" | | | | |
| 05TMG08 | 1/2" | | | | |
| 05TMG12 | 3/4" | | | | |
| 05TMG16 | 1" | | | | |
| 05TMG14A | 14x1,5 | | | | |
| 05TMG16A | 16x1,5 | | | | |
| 05TMG18A | 18x1,5 | | | | |
| 05TMG22A | 22x1,5 | | | | |
| 05TMG24A | 24x1,5 | | | | |
| 05TMG30A | 30x1,5 | | | | |
| 05TMG33A | 33x1,5 | | | | |

TAPPO FEMMINA

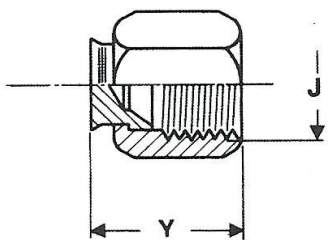

| CODICE | FIL (J) | Y | CH | | |
|----------|---------|---|----|--|--|
| 05TFG04 | 1/4" | | | | |
| 05TFG06 | 3/8" | | | | |
| 05TFG08 | 1/2" | | | | |
| 05TFG12 | 3/4" | | | | |
| 05TFG16 | 1" | | | | |
| 05TFG14A | 14x1,5 | | | | |
| 05TFG16A | 16x1,5 | | | | |
| 05TFG18A | 18x1,5 | | | | |
| 05TFG22A | 22x1,5 | | | | |
| 05TFG24A | 24x1,5 | | | | |
| 05TFG30A | 30x1,5 | | | | |
| 05TFG33A | 33x1,5 | | | | |



Sede: 60035 JESI (AN) - Via G. di Vittorio, 9 - Tel 0731 207231

Filiale: 41100 MODENA - Via Respighi, 78 - Tel 059 270966

e-mail: om@omoleodinamica.com - www.omoleodinamica.com - C.F. e P.IVA 00478760424